

# AIRPORT LAYOUT PLAN FOR MANOKOTAK AIRPORT

2006

### DRAWING INDEX

- 1 - COVER SHEET AND INDEX
- 2 - VICINITY MAP AND DATA TABLES
- 3 - PROPOSED RUNWAY 03/21 PLAN
- 4 - FUTURE RUNWAY 03/21 PLAN
- 5 - RUNWAY 03/21 INNER APPROACH SURFACE PLAN AND PROFILE
- 6 - TERMINAL AREA PLAN
- 7 - RUNWAY 03/21 APPROACH PROFILES
- 8 - F.A.R. PART 77 SURFACES
- 9 - NARRATIVE REPORT
- 10 - AIRPORT PROPERTY MAP

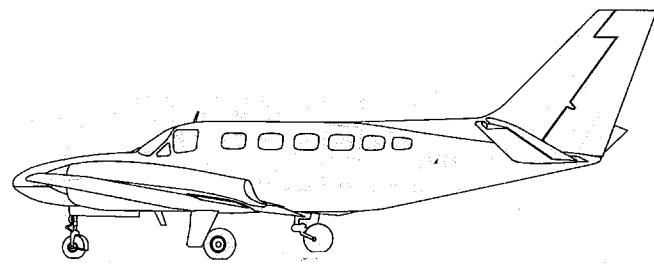

STL	6/1/06	FRA APPROVAL
F/S	4-26-11	AS-BUILT: UPDATED SHEETS 2-8 & 10
BY	DATE	REVISIONS

Date Plotted: 07/28/2006  
 Plot Ratio and Layout: 1=1, Layout=ALP Cover (1)  
 File: P:\2002\F02010\Submitted\0907m27d - ALP Converted\Drawn\CD0000\F02010\$\$.

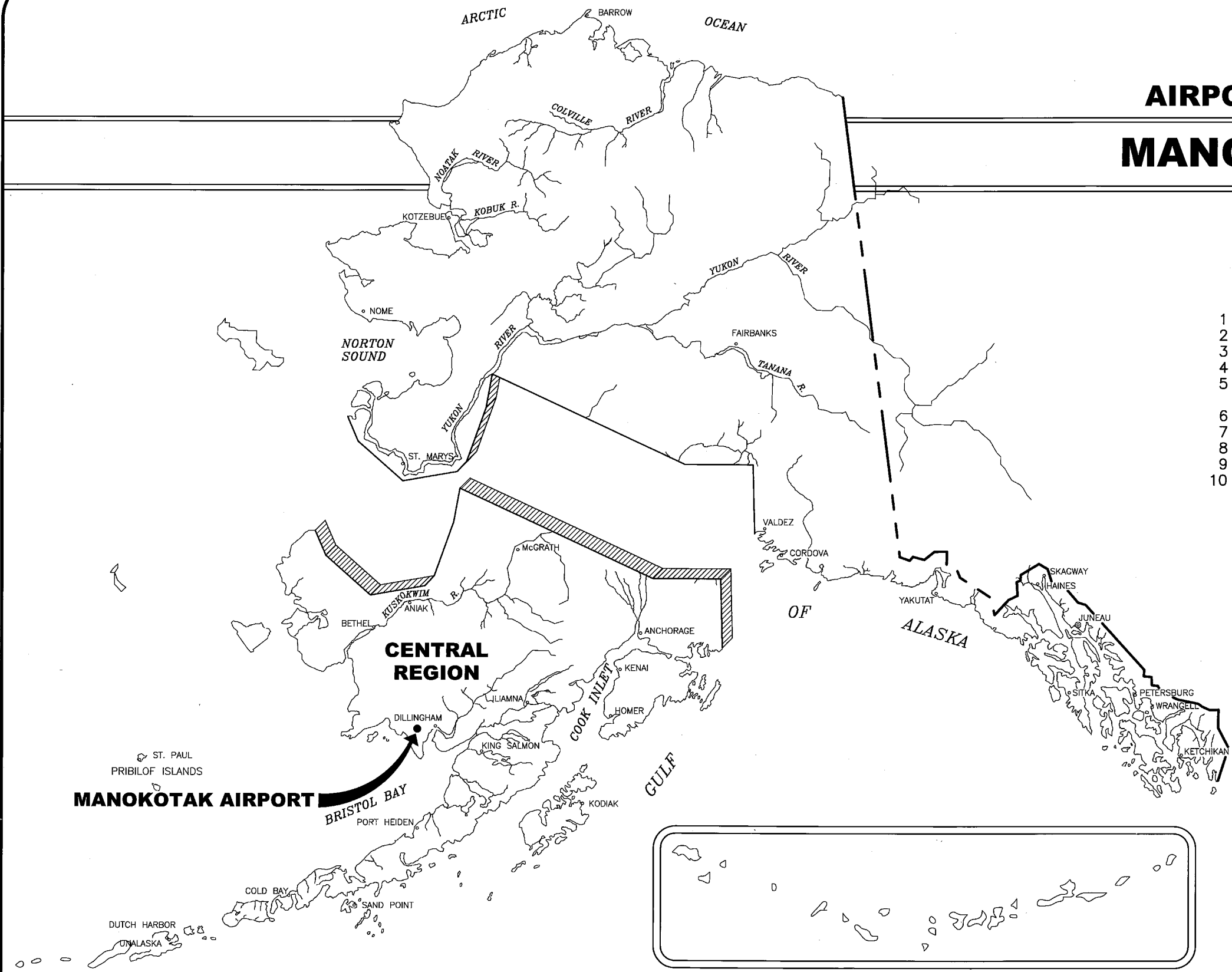

**MANOKOTAK AIRPORT**

**SPONSORED BY**  
**STATE OF ALASKA**  
**DEPARTMENT OF TRANSPORTATION**  
**AND PUBLIC FACILITIES**  
**CENTRAL REGION**

**APPROVED** *[Signature]* **DATE** 8-3-06  
**ROBERT A. CAMPBELL, P.E.** **PRECONSTRUCTION ENGINEER**  
**RECOMMENDED** *[Signature]* **DATE** 8/3/2006  
**HARVEY M. DOUTHIT, P.E.** **DESIGN SECTION CHIEF**

AIRPORT LAYOUT PLAN CONDITIONAL APPROVAL  
 SUBJECT TO ALP APPROVAL LETTER DATED 8/30/06  
 By: *[Signature]* DATE: 8/30/06  
 FAA, AIRPORTS DIVISION  
 ALASKAN REGION, AAL-600  
 F.A.A. AIRSPACE REVIEW NUMBER:  
 05-AAL-139NRA

**MANOKOTAK AIRPORT**  
**AIRPORT LAYOUT PLAN**

**SHEET 1 OF 10**



Date Plotted: 7/21/2010, 1:15 PM  
 Layout Name: ALP Plan (3)  
 File Name: W:\Projects\Manokotak\ALP\2010 ALP Minor Updates\ALP 2010.dwg  
 Designed By:  
 Drawn By:  
 Checked By:

MAG DEC = 15°49'E FEB 2006  
 EPOCH YEAR MAG DEC = 15°01'E JAN 1, 2010

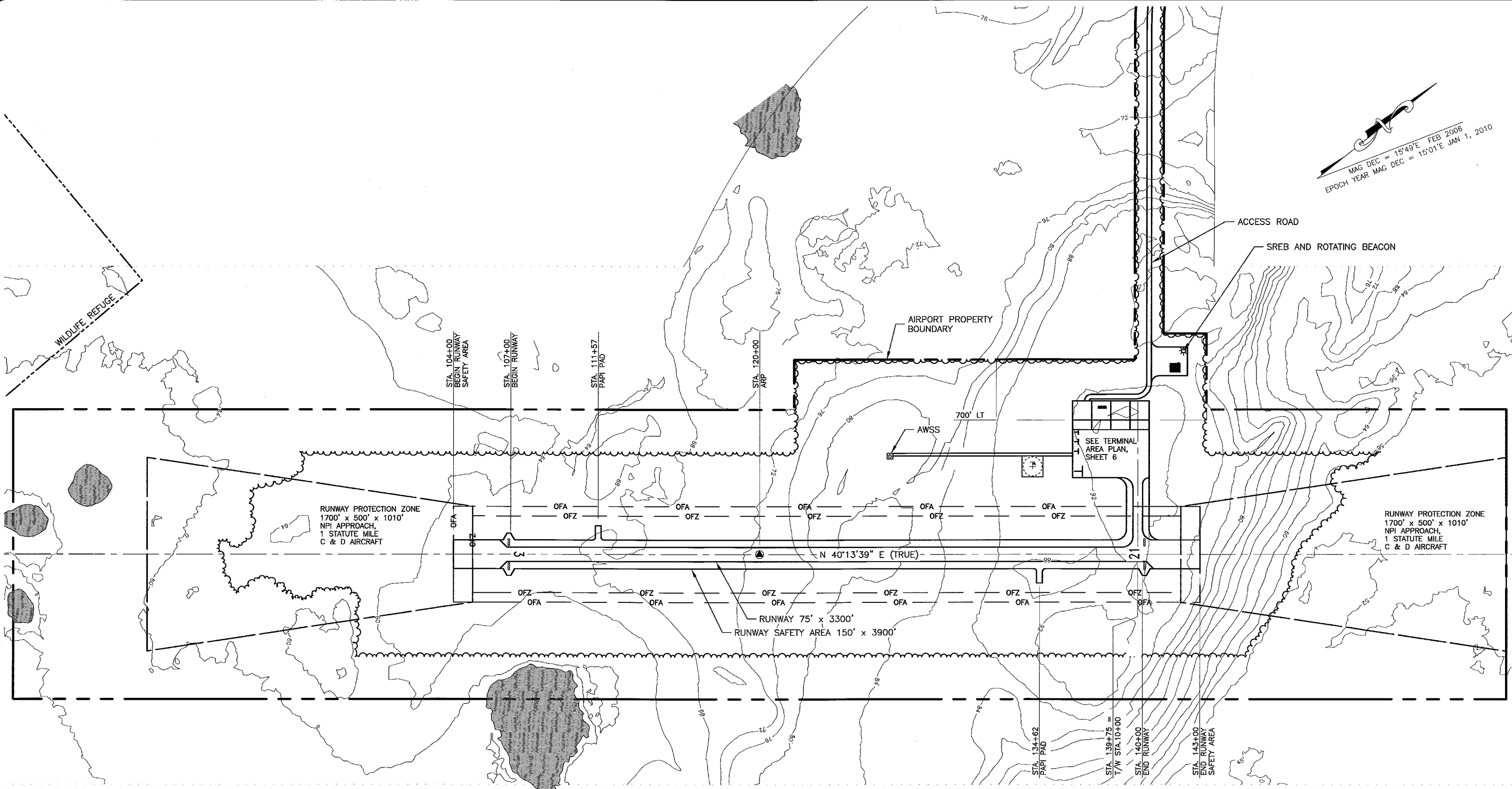

**NOTES:**

- SEE SHEET 6 FOR BUILDING DATA TABLE AND SHEET 8 FOR OBSTRUCTIONS DATA TABLE.

**RUNWAY 03/21 PLAN**

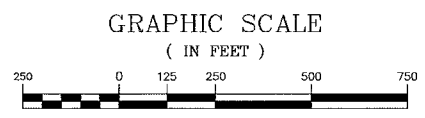

BY	DATE	REVISIONS
PK	4-26-11	AS-BUILT: UPDATED TO EXISTING CONDITIONS

STATE OF ALASKA  
 DEPARTMENT OF TRANSPORTATION  
 AND PUBLIC FACILITIES  
 CENTRAL REGION

**MANOKOTAK AIRPORT**  
 MANOKOTAK, ALASKA  
 AIRPORT LAYOUT PLAN  
 EXISTING RUNWAY 03/21 PLAN

DATE:  
 JULY 2006  
 SHEET:  
 3  
 OF  
 10

MAG DEC = 15'49"E FEB 2006  
 EPOCH YEAR MAG DEC = 15'01"E JAN 1, 2010

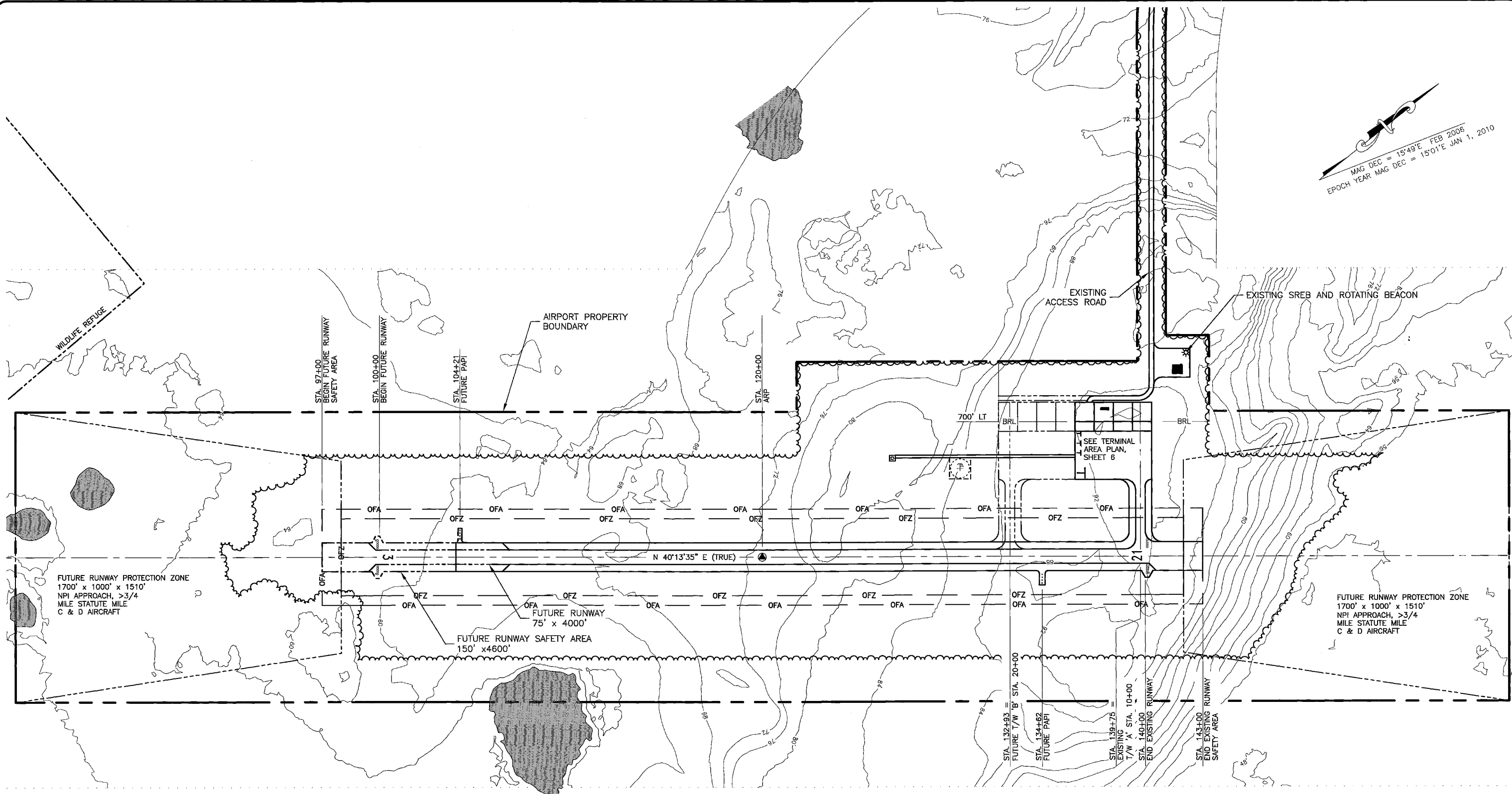

Date Plotted: 7/21/2010, 2:30 PM  
 Layout Name: ALP Plan (4)  
 File Name: W:\Projects\Manokotak\ALP\2010 ALP Minor Updates\ALP 2010.dwg

**NOTES:**  
 1. SEE SHEET 6 FOR BUILDING DATA TABLE AND SHEET 8 FOR OBSTRUCTIONS DATA TABLE.

**FUTURE RUNWAY 03/21 PLAN**

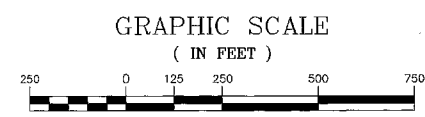

BY	DATE	REVISIONS
TJS	4-26-11	AS-BUILT: UPDATED TO EXISTING CONDITIONS

**STATE OF ALASKA  
 DEPARTMENT OF TRANSPORTATION  
 AND PUBLIC FACILITIES  
 CENTRAL REGION**

**MANOKOTAK AIRPORT**  
 MANOKOTAK, ALASKA  
 AIRPORT LAYOUT PLAN  
 FUTURE RUNWAY 03/21 PLAN

DATE:  
 JULY 2006  
 SHEET:  
 4  
 OF  
 10

Date Plotted: 7/22/2010, 8:05 AM  
 Layout Name: ALP\_Inner\_App\_05-300  
 File Name: W:\Projects\Manokotak\ALP\_2010\ALP\_Inner\_Update\ALP\_2010.dwg  
 Designed By:  
 Drawn By:  
 Checked By:

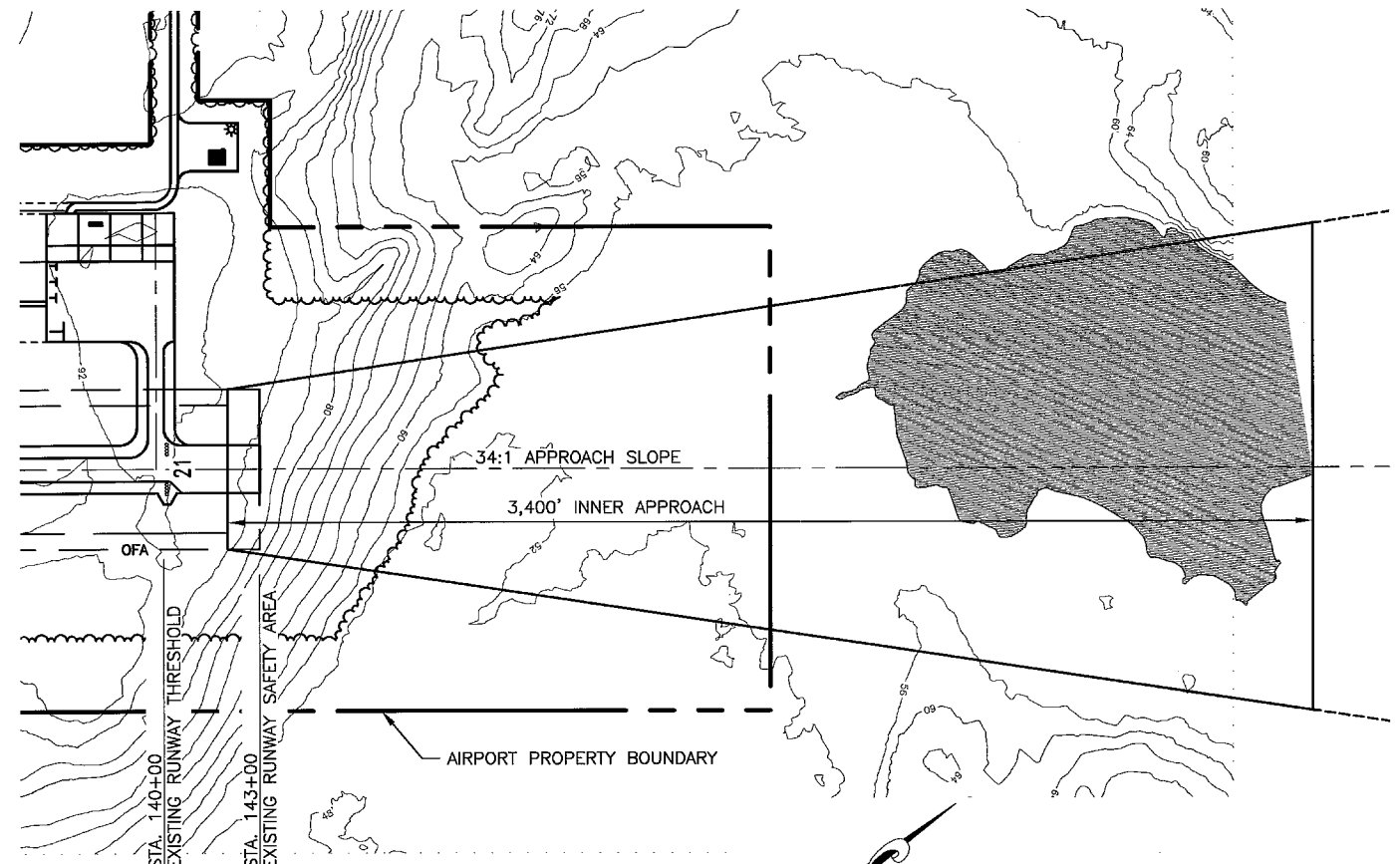
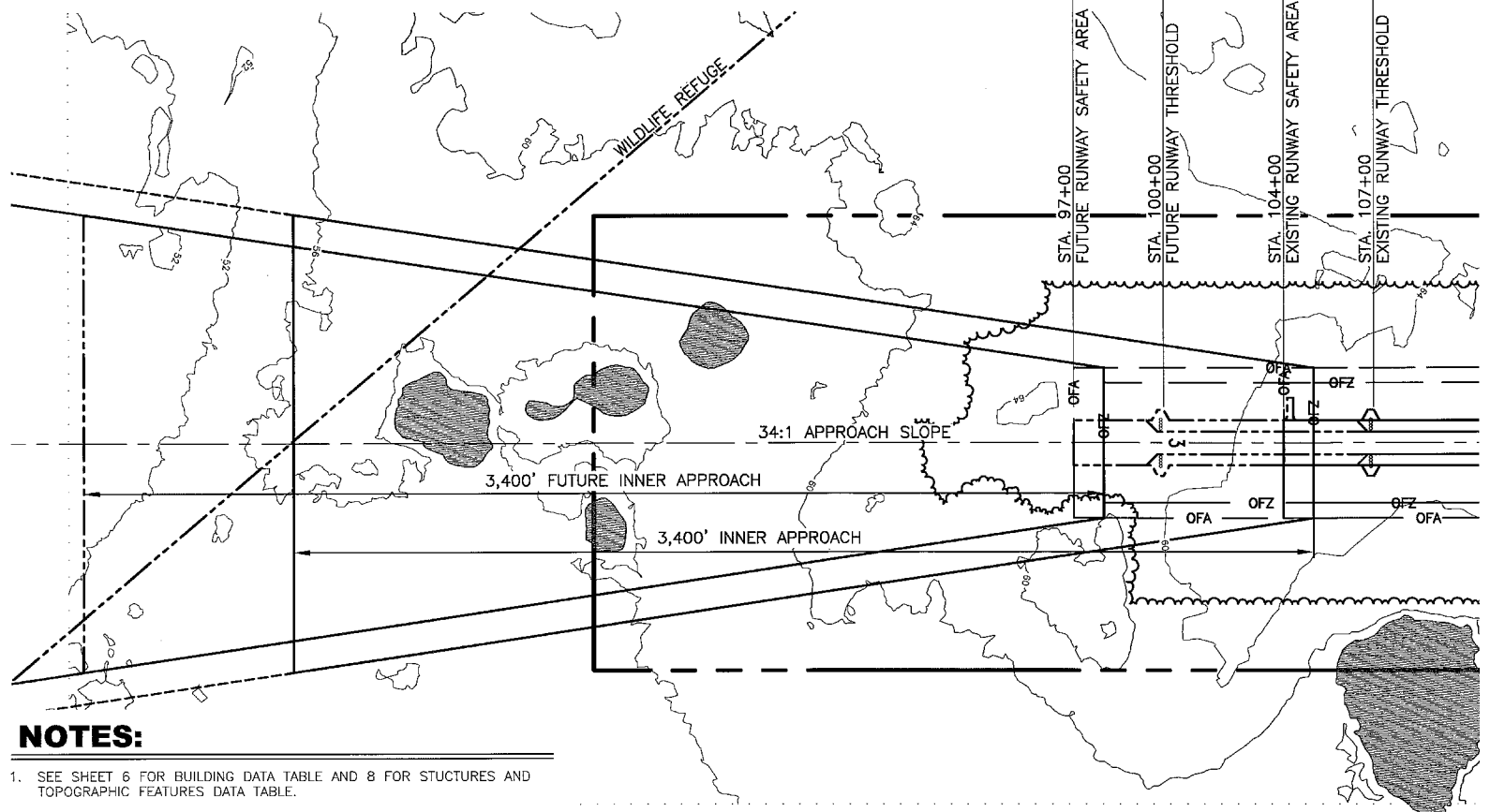

- NOTES:**
- SEE SHEET 6 FOR BUILDING DATA TABLE AND 8 FOR STRUCTURES AND TOPOGRAPHIC FEATURES DATA TABLE.
  - NO THRESHOLD SITING SURFACE PENETRATIONS.
  - TERPS PARAGRAPH 251, 20:1 APPROACH SURFACE CLEAR.
  - OBSTRUCTION CLEARANCE SLOPE GREATER THAN 50:1.

**RUNWAY 03 PLAN**

**RUNWAY 21 PLAN**

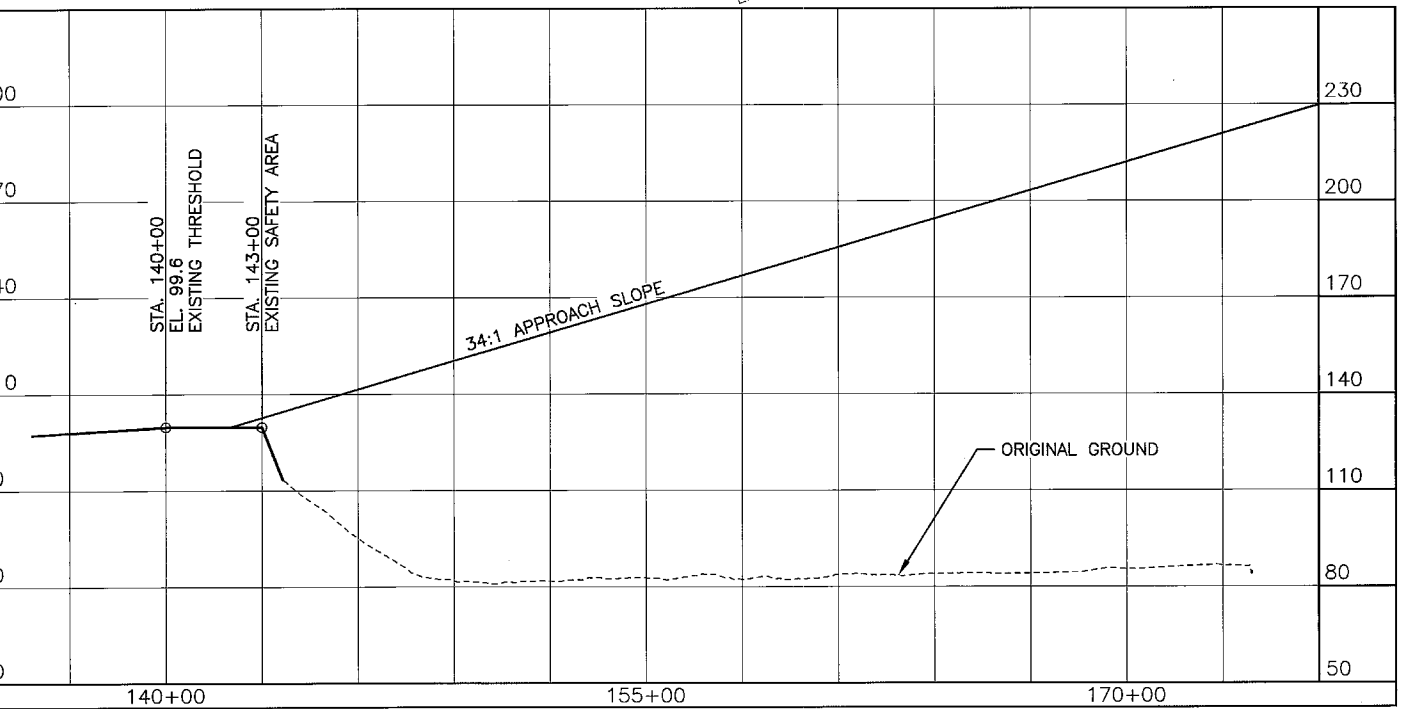
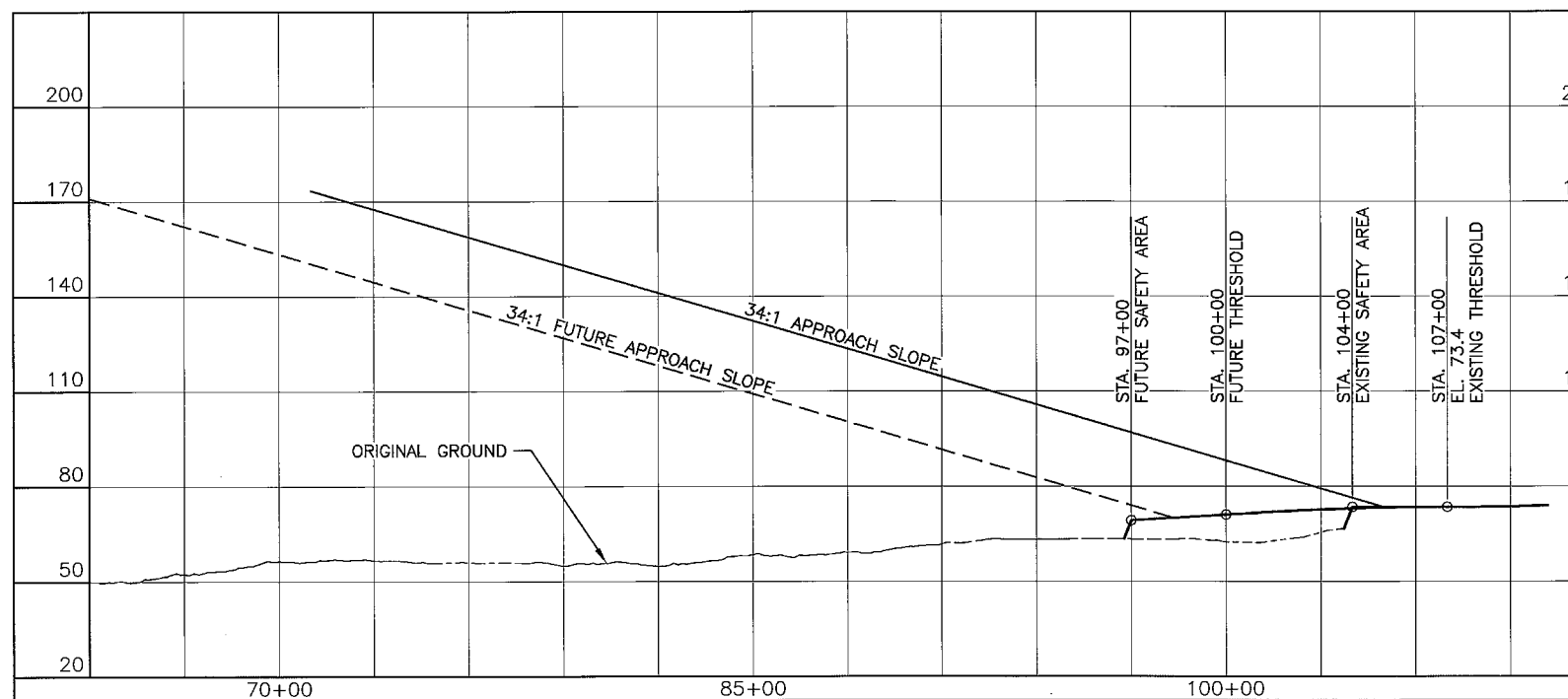
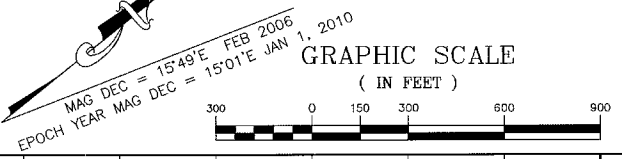

**RUNWAY 03 PROFILE**

**RUNWAY 21 PROFILE**

NO.	DATE	REVISIONS
175	4-26-11	AS-BUILT: UPDATED TO EXISTING CONDITIONS

STATE OF ALASKA  
 DEPARTMENT OF TRANSPORTATION  
 AND PUBLIC FACILITIES  
 CENTRAL REGION

**MANOKOTAK AIRPORT**  
 MANOKOTAK, ALASKA  
 AIRPORT LAYOUT PLAN  
 RUNWAY 03/21 INNER APPROACH SURFACE  
 PLAN AND PROFILE

DATE: JULY 2006  
 SHEET: 5 OF 10

PROPOSED AND FUTURE TAXIWAY DATA TABLE	
DESCRIPTION	T/W 'A' & T/W 'B'
AIRPORT DESIGN GROUP	III
TAXIWAY WIDTH	50'
TAXIWAY SAFETY AREA WIDTH	118'
TAXIWAY OBJECT FREE AREA WIDTH	186'

BUILDING DATA TABLE								
BUILDING ID #	DESCRIPTION	BUILDING STA/OFFSET	TOP ELEV (MSL)	HEIGHT ABOVE PRIMARY SURF	TRANS SURF @ BUILD	AMOUNT OF PENETRATION	DISPOSITION	OBSTRUCTION MARKING
A	AWSS	126+80 / 515' LT	122.81	32.25	128.42	NONE	TO REMAIN	NONE
B	SREB	141+04 / 940' LT	122.75	22.95	199.20	NONE	TO REMAIN	NONE

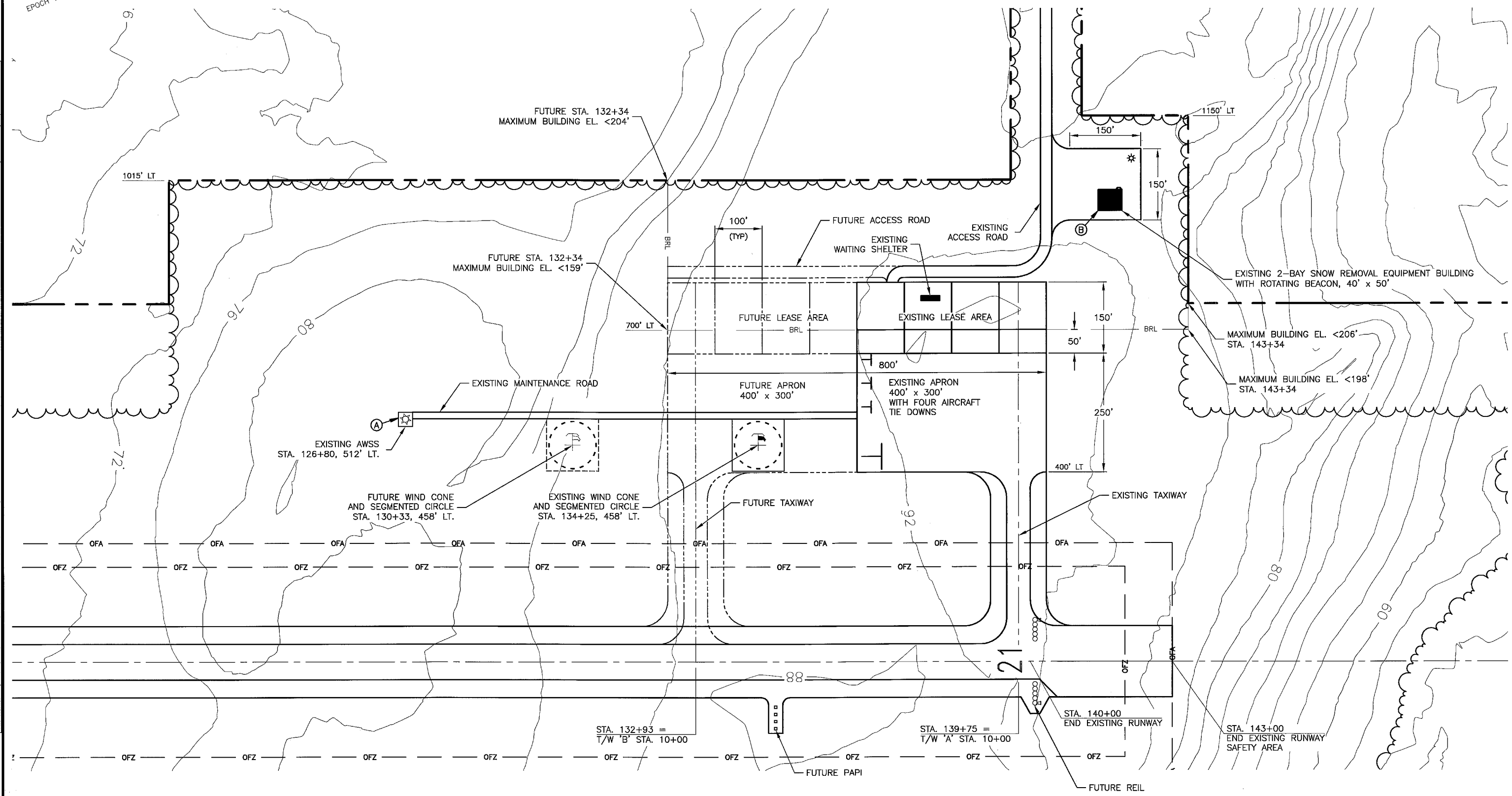
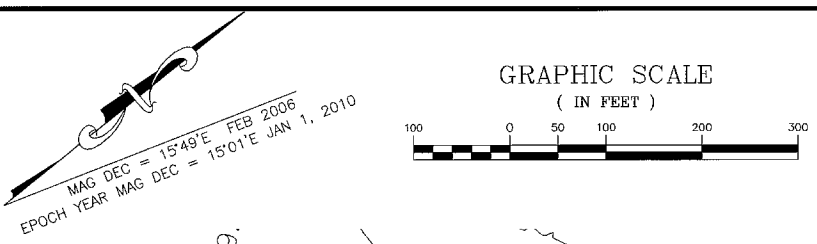

**TERMINAL AREA PLAN**

Date Plotted: 7/27/2010, 2:44 PM  
 Layout Name: ALP\_Term\_Plan\_6  
 File Name: W:\Projects\Manokotak\ALP\2010 ALP Minor Update\ALP 2010.dwg

BY	DATE	REVISIONS
TS	4-26-11	AS-BUILT: UPDATED TO EXISTING CONDITIONS

STATE OF ALASKA  
DEPARTMENT OF TRANSPORTATION  
AND PUBLIC FACILITIES  
CENTRAL REGION

**MANOKOTAK AIRPORT**  
MANOKOTAK, ALASKA  
AIRPORT LAYOUT PLAN  
TERMINAL AREA PLAN

DATE: JULY 2006  
SHEET: 6 OF 10

Date Plotted: 7/22/2010, 7:51 AM  
 Layout Name: ALP App Prof (7)  
 File Name: W:\Projects\Manokotak\ALP\2010\ALP App Prof\ALP 2010.dwg  
 Designed By:  
 Drawn By:  
 Checked By:

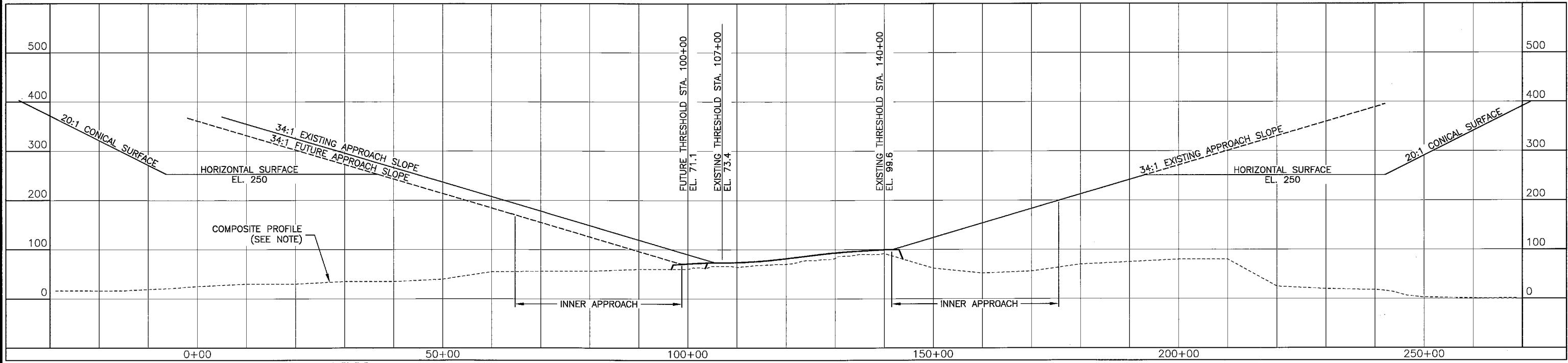

NOTE: THE COMPOSITE PROFILE ALONG THE EXTENDED RUNWAY CENTERLINE REPRESENTS THE HIGHEST TERRAIN ACROSS THE WIDTH AND ALONG THE LENGTH OF THE APPROACH SURFACE.

**RUNWAY 03/21 APPROACH PROFILE**

BY	DATE	REVISIONS
RS	4-26-11	AS-BUILT: UPDATED TO EXISTING CONDITIONS

STATE OF ALASKA  
 DEPARTMENT OF TRANSPORTATION  
 AND PUBLIC FACILITIES  
 CENTRAL REGION

**MANOKOTAK AIRPORT**  
 MANOKOTAK, ALASKA  
 AIRPORT LAYOUT PLAN  
 RUNWAY 03/21 APPROACH PROFILES

DATE: JULY 2006  
 SHEET: 7 OF 10

Date Plotted: 7/22/2010, 7:52 AM  
 Layout Name: ALP Part 77 (8)  
 File Name: W:\Projects\Manokotak\ALP\2010 ALP Minor Update\ALP 2010.dwg

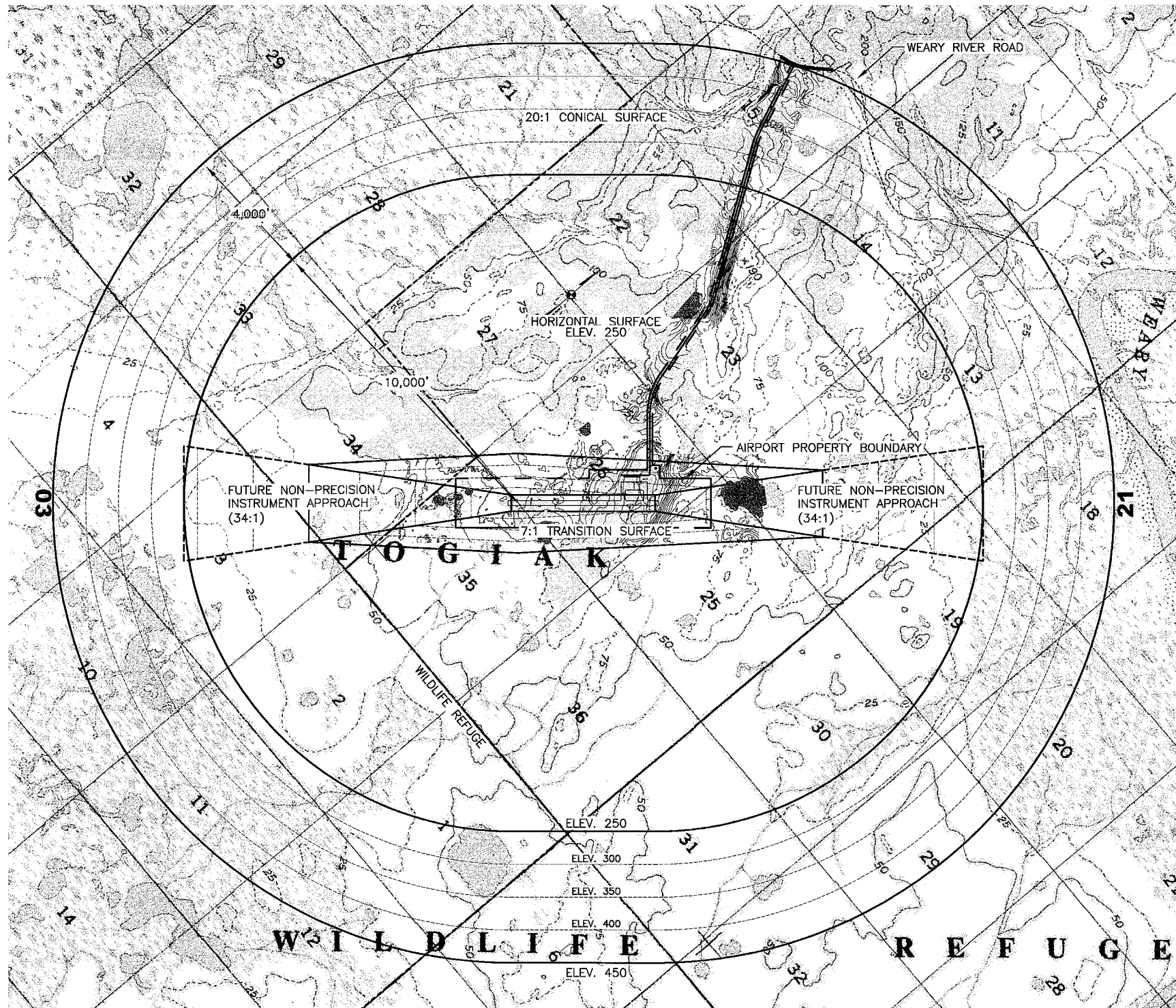

NOTE: USGS QUAD MAP AND FIELD OBSERVATIONS USED FOR AIRSPACE DRAWINGS.

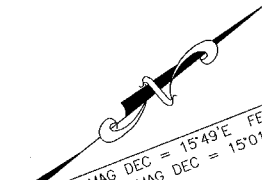
  
 MAG DEC = 15°49'E FEB 2006  
 EPOCH YEAR MAG DEC = 15°01'E JAN 1, 2010

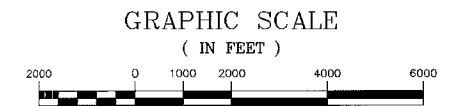

F.A.R. PART 77 OBSTRUCTION TABLE								
OBSTRUCTION ID	DESCRIPTION	OBSTRUCTION STA/OFFSET	OBSTRUCTION ELEVATION	SURFACE PENETRATED	SURFACE ELEVATION	AMOUNT OF PENETRATION	DISPOSITION	STAGE TO BE CORRECTED
	NO KNOWN OBSTRUCTIONS							

THE PRIMARY SURFACE WIDTH IS 500 FEET.

BY	DATE	REVISIONS
NS	4-26-11	AS-BUILT: UPDATED TO EXISTING CONDITIONS

STATE OF ALASKA  
 DEPARTMENT OF TRANSPORTATION  
 AND PUBLIC FACILITIES  
 CENTRAL REGION

**MANOKOTAK AIRPORT**  
 MANOKOTAK, ALASKA  
 AIRPORT LAYOUT PLAN  
 F.A.R. PART 77 SURFACES

DATE:  
 JULY 2006  
 SHEET:  
 8 OF 10



PROPERTY STATUS							
ID #	INTEREST	GRANTOR	GRANTEE	PARCEL SIZE	DATE ACQUIRED	RECORDED DOC NO.	ACQUIRED AIP NO.
PARCEL 1	FEE SURFACE	MANDKOTAK NATIVES	STATE OF ALASKA, DOT&PF	329.788 AC	7/25/06	2006-000371-0	3-02-0171-0206
PARCEL 1	FEE SUBSURFACE	BRISTOL BAY NATIVE CORP	STATE OF ALASKA, DOT&PF	329.788 AC	7/25/06	2006-000372-0	3-02-0171-0206

MAG DEC = 15°49'E FEB 2006  
EPOCH YEAR MAG DEC = 15°01'E JAN 1, 2010

MATCHLINE

AIRPORT PROPERTY BOUNDARY

150'

MATCHLINE

AIRPORT PROPERTY BOUNDARY

MAG DEC = 15°49'E FEB 2006  
EPOCH YEAR MAG DEC = 15°01'E JAN 1, 2010

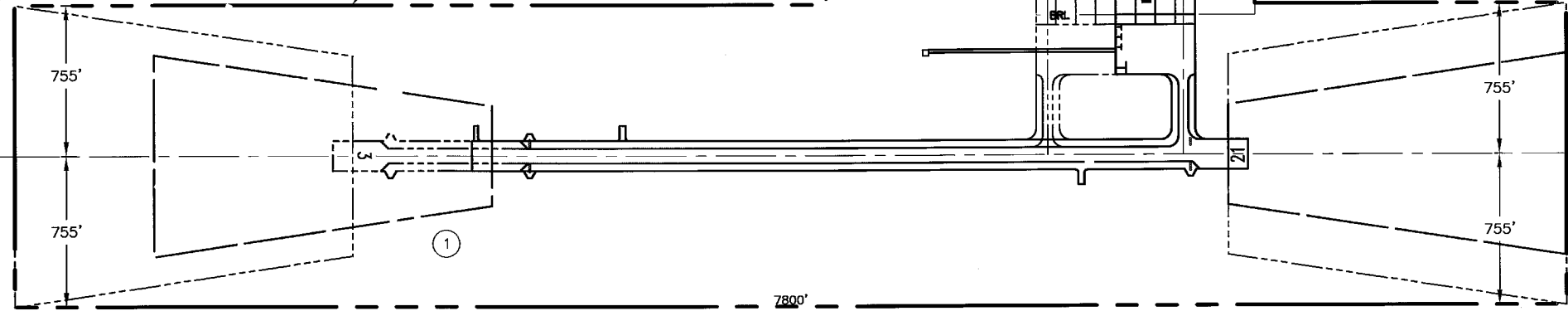

**PROPERTY MAP**

GRAPHIC SCALE  
( IN FEET )

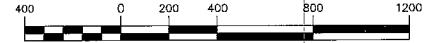

- NOTES:**
1. THE EXISTING PROPERTY IS SHOWN ON THE EXISTING PROPERTY PLAN (NOT ATTACHED).

Date Plotted: 7/22/2010, 7:58 AM  
 Layout Name: Property Map (10)  
 File Name: W:\Projects\Manokotak\AIP\2010 AIP Minor Update\AIP 2010.dwg

AS	4-26-11	AS-BUILT: UPDATED TO EXISTING CONDITIONS
BY	DATE	REVISIONS

**STATE OF ALASKA  
DEPARTMENT OF TRANSPORTATION  
AND PUBLIC FACILITIES  
CENTRAL REGION**

**MANOKOTAK AIRPORT**  
MANOKOTAK, ALASKA  
AIRPORT LAYOUT PLAN  
AIRPORT PROPERTY MAP

DATE:  
JULY 2006  
SHEET:  
10  
OF  
10