

Designed By: J. OSTERMANN
 Drawn By: M. TOLMAN
 Checked By: T. SCHMID
 Date Plotted: 7/19/2006 3:44 PM
 Layout Name: Layout1
 File Name: W:\Projects\McGrath\ALP_2005\Final Drawings\Data sheet-1.dwg

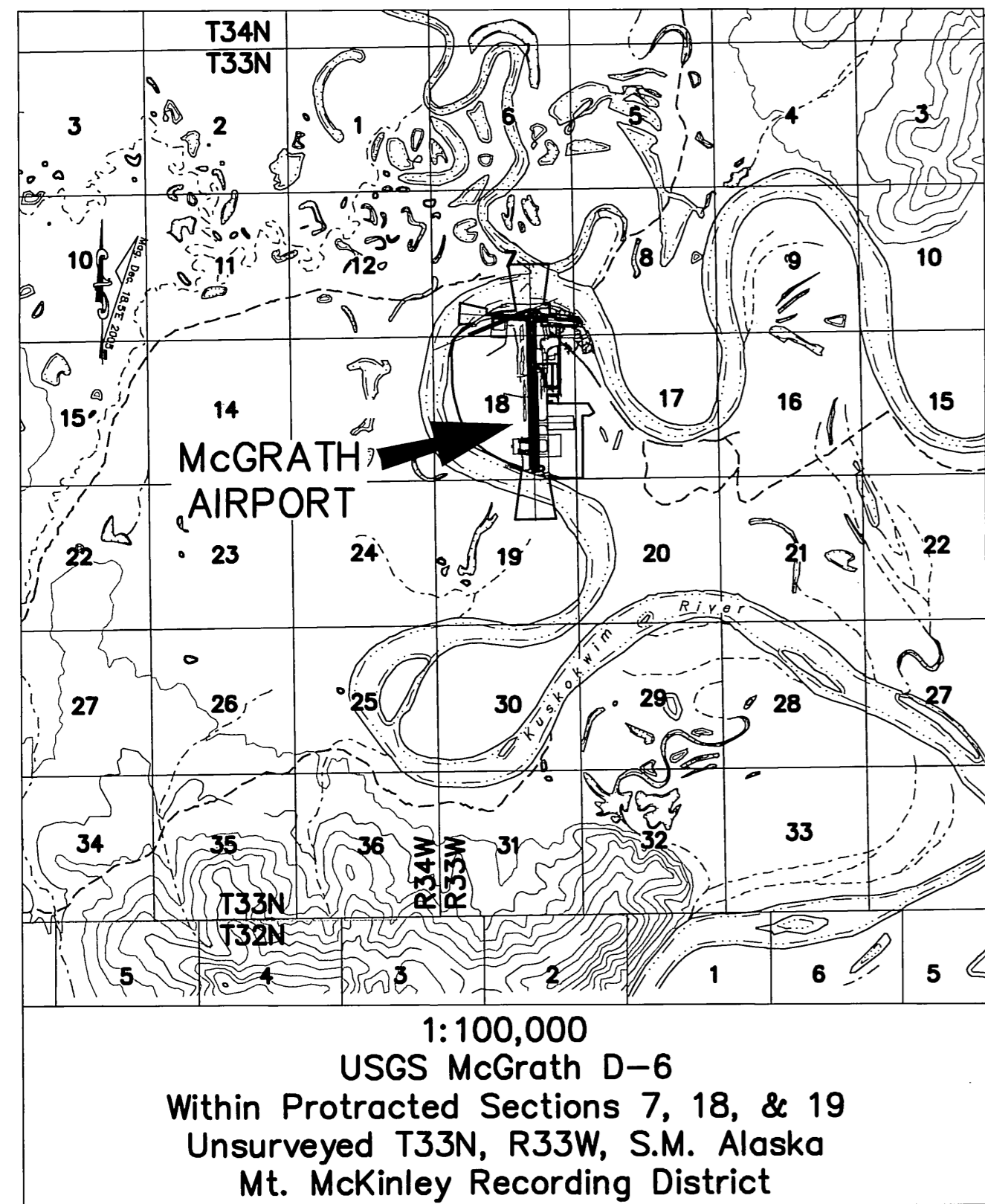

VICINITY MAP

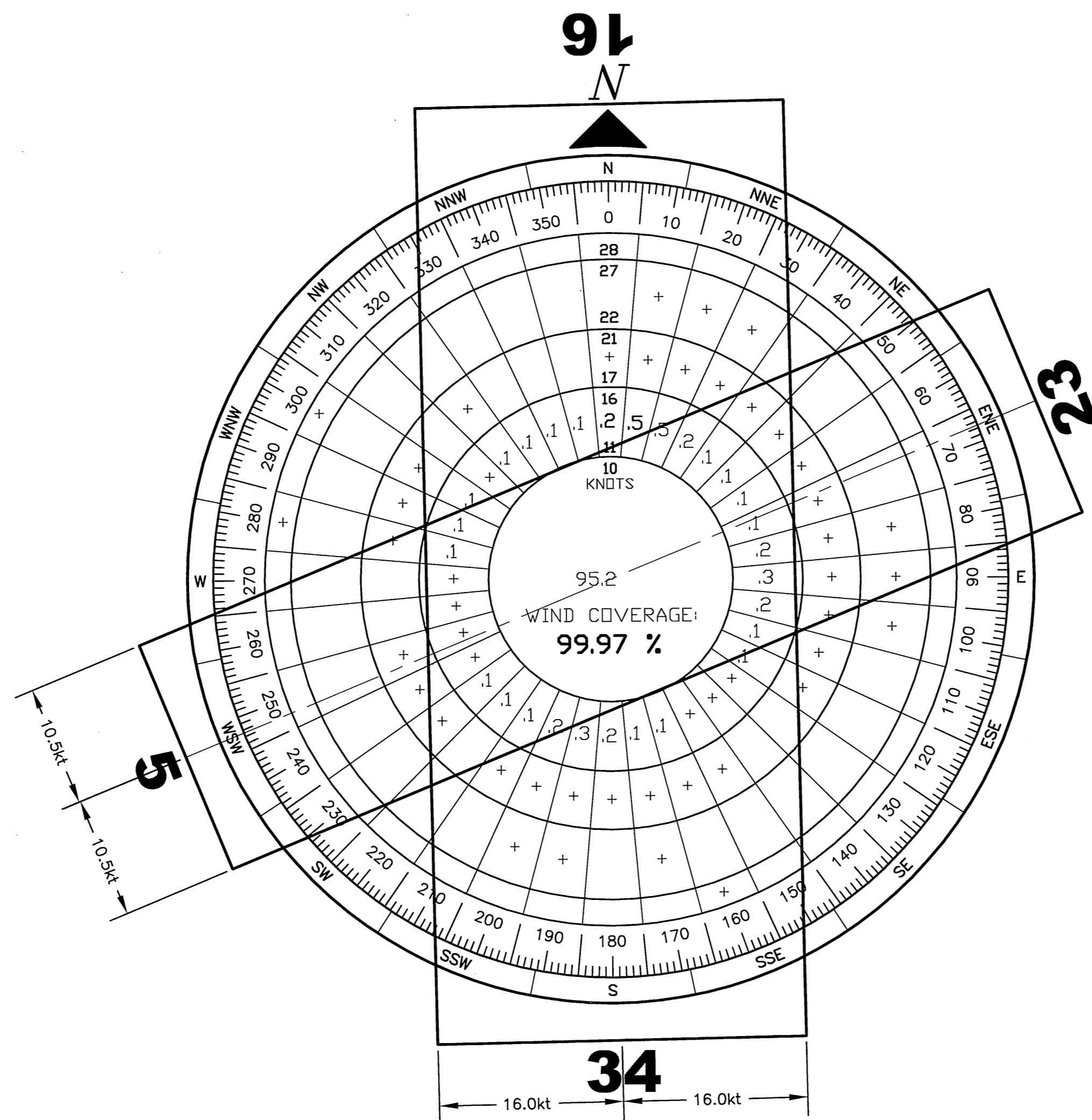

WIND DATA TABLE				
WIND SPEED	10.5K	13K	16K	20K
16-34	98.48%	99.18%	99.88%	N/A
05-23	97.80%	N/A	N/A	N/A
BOTH	99.79%	N/A	N/A	N/A

WIND DATA

SOURCE: U.S. DEPARTMENT OF COMMERCE, NATIONAL OCEANIC AND ATMOSPHERIC ADMINISTRATION, NATIONAL CLIMATIC DATA CENTER

PERIOD: JAN. 1, 1995 - DEC. 31, 2004

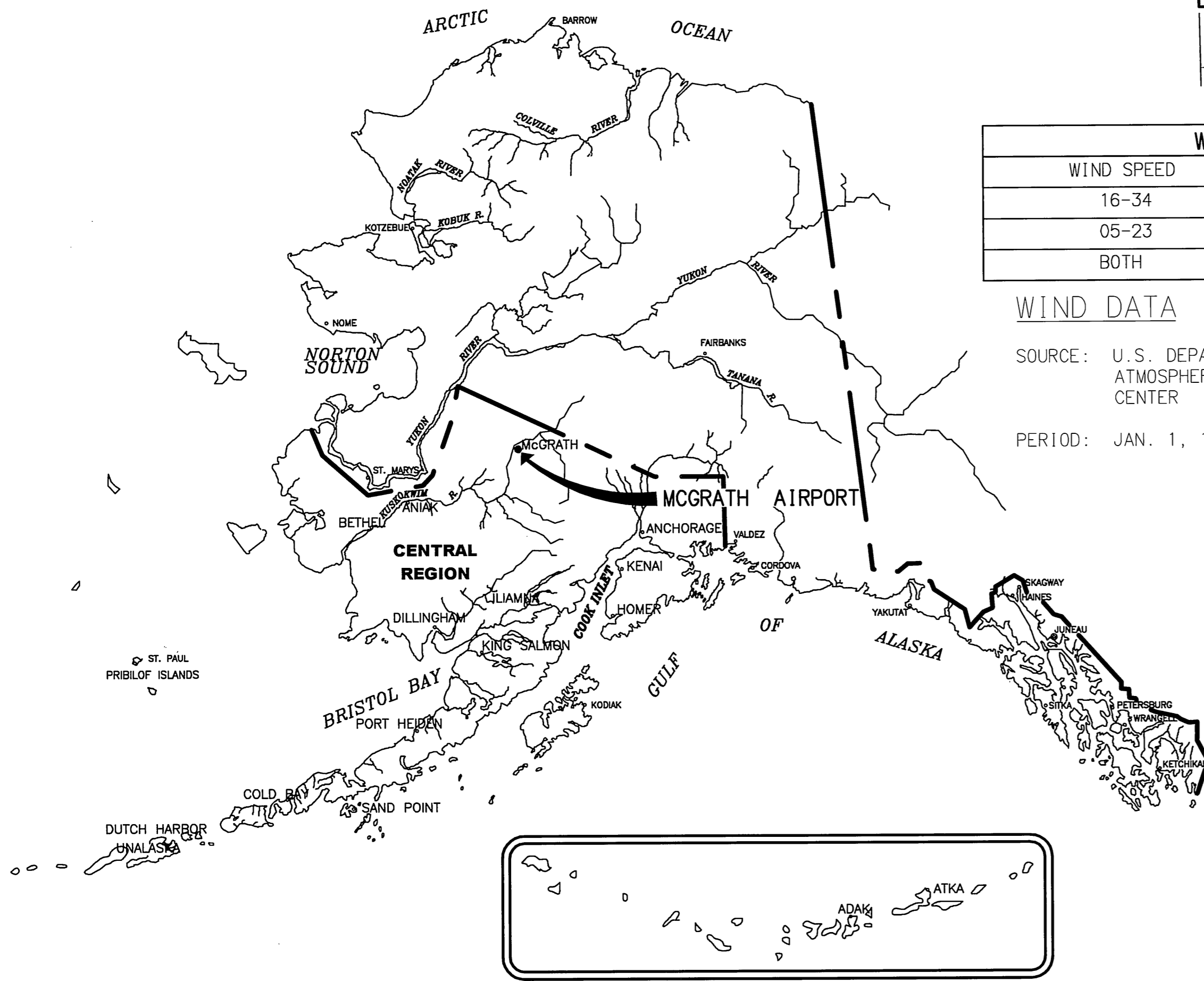

LOCATION MAP

RUNWAY 16/34 DATA TABLE		
ITEM	EXISTING	ULTIMATE
RUNWAY TYPE	ENTER UTILITY OR >UTILITY	> UTILITY
FAR PART 77 APPROACH CATEGORY (V, NPI, P)	NPI (16) / V (34)	NPI
APPROACH SURFACES	34:1 / 20:1	34:1
VISIBILITY MINIMUM	1 SM / V	1 SM
RUNWAY SURFACE	ASPHALT	ASPHALT
PAVEMENT STRENGTH (1000lbs)	SINGLE WHEEL (SW)	75
	DUAL WHEEL (DW)	155
	DUAL TANDEM WHEEL (DTW)	250
	DOUBLE DUAL TANDEM WHEEL (DDTW)	N/A
AIRCRAFT APPROACH CATEGORY	B	B
AIRPLANE DESIGN GROUP	III	III
RUNWAY DIMENSIONS	100' x 5936'	100' x 5936'
TRUE GEODETIC BEARING (MEAN)	N 01° 05' 09" W	N 01° 05' 09" W
EFFECTIVE GRADE	0.00 %	0.00 %
TOUCHDOWN ELEVATION (NAVD88)	341.35' / 341.25'	341.35' / 341.25'
RUNWAY SAFETY AREA (RSA)	300' x 6039'	300' x 6043'
LENGTH BEYOND RWY DISPLACED THRESHOLD	600' / 596'	600' / 600'
RUNWAY PROTECTION ZONE (RPZ)	500' x 700' x 1000'	500' x 700' x 1000'
RUNWAY OBJECT FREE AREA (OFA)	800' x 7136'	800' x 7136'
LENGTH BEYOND RWY END (THRESHOLD)	600' / 600'	600' / 600'
RUNWAY OBSTACLE FREE ZONE (OFZ)	400' x 6336'	400' x 6336'
RUNWAY LIGHTING	M.I.	M.I.
RUNWAY MARKING TYPE	NPI	NPI
RUNWAY VISUAL APPROACH AIDS	VASI, REIL	VASI, REIL

EXISTING RUNWAY 07/25 & PROPOSED RUNWAY 05/23 DATA TABLE			
ITEM	RUNWAY 07/25 EXISTING	RUNWAY 07/25 NEAR-TERM/ULT	RUNWAY 05/23 ULTIMATE
RUNWAY TYPE	UTILITY	UTILITY	UTILITY
FAR PART 77 APPROACH CATEGORY (V, NPI, P)	V / V	V / V	V / V
APPROACH SURFACES	20:1 / 20:1	20:1 / 20:1	20:1 / 20:1
VISIBILITY MINIMUM	VISUAL	VISUAL	VISUAL
RUNWAY SURFACE	ASPHALT	GRAVEL	N/A
PAVEMENT STRENGTH SW, DW, DTW, DDTW 1000lbs	12.5 SW	N/A	N/A
AIRCRAFT APPROACH CATEGORY	A	A	A
AIRPLANE DESIGN GROUP	I	I	I
RUNWAY DIMENSIONS	100' x 1720'	60' x 2000'	60' x 2000'
TRUE GEODETIC BEARING (MEAN)	S 86° 0' 13" E	S 67° 34' 28" W	S 67° 34' 28" W
EFFECTIVE GRADE	0.15 %	0.00 %	0.00 %
TOUCHDOWN ELEVATION (NAVD88)	338.87' / 340.76'	341.3' / 341.3'	341.3' / 341.3'
RUNWAY SAFETY AREA (RSA)	120' x 2020'	120' x 2480'	120' x 2480'
LENGTH BEYOND RWY END	60' / 240'	240' / 240'	240' / 240'
RUNWAY PROTECTION ZONE (RPZ)	250' x 450' x 1000'	250' x 450' x 1000'	250' x 450' x 1000'
RUNWAY OBJECT FREE AREA (OFA)	250' x 2200'	250' x 2480'	250' x 2480'
LENGTH BEYOND RWY END	240' / 240'	240' / 240'	240' / 240'
RUNWAY OBSTACLE FREE ZONE (OFZ)	250' x 2120'	250' x 2400'	250' x 2400'
RUNWAY LIGHTING	NONE	M.I.	M.I.
RUNWAY MARKING TYPE	VISUAL	NONE	NONE
RUNWAY VISUAL APPROACH AIDS	NONE	NONE	NONE

GEOGRAPHIC COORDINATES TABLE				
ITEM	EXISTING LATITUDE	EXISTING LONGITUDE	ULTIMATE LATITUDE	ULTIMATE LONGITUDE
ARP	62°57'10.02" N	155°36'25.36" W	62°57'10.02" N	155°36'25.36" W
THRESHOLD RW 16	62°57'33.12" N	155°36'19.01" W	SAME	SAME
THRESHOLD RW 34	62°56'34.70" N	155°36'16.58" W	SAME	SAME
DISPLACED RW 16	62°57'27.75" N	155°36'18.80" W	SAME	SAME
DISPLACED RW 34	62°56'40.08" N	155°36'16.80" W	SAME	SAME
THRESHOLD RW 07	62°57'31.18" N	155°36'48.08" W		
THRESHOLD RW 25	62°57'30.00" N	155°36'10.98" W		
THRESHOLD RW 05	62°57'24.40" N	155°37'07.79" W	62°57'24.40" N	155°37'07.79" W
THRESHOLD RW 23	62°57'31.91" N	155°36'27.82" W	62°57'31.91" N	155°36'27.82" W

AIRPORT DATA TABLE		
ITEM	EXISTING	ULTIMATE
ICAO IDENTIFIER	PAMC	PAMC
NATIONAL AIRPORT IDENTIFIER	MCG	MCG
FAA SITE NUMBER	50467.A	50467.A
AIRPORT ELEVATION (NAVD88)	341.35'	341.35'
AIRPORT REFERENCE CODE	B III	B III
MEAN MAX. TEMPERATURE, HOTTEST MONTH	69.7°F JULY	69.7°F JULY
AIRPORT AND TERMINAL NAVIGATION AIDS	GPS, VORTAC, LOC/DME	GPS, VORTAC, LOC/DME
TAXIWAY LIGHTING/MARKING	NDB, VHF/DF	NDB, VHF/DF
OBSTRUCTION SURVEY SOURCE & TYPE	M. I. / NA	M. I. / NA
MAGNETIC DECLINATION, YEAR, RATE OF CHANGE	NGS 1981	NGS 1981

MODIFICATION TO STANDARDS/ NON STANDARD CONDITIONS			
DESCRIPTION	STANDARD	EXISTING	ULTIMATE
EAST GA. APRON AIRCRAFT PARKING SETBACK			
FROM R/W 16-34	400'	330'	400'
BUILDINGS WITHIN BRL EAST OF R/W 16-34	495'	393' TO 425'	495'
SEWAGE LAGOONS	10,000'	1,260'	1,260'
SOLID WASTE FACILITY	10,000'	7,000'	7,000'

NOTES:
 1. ELEVATIONS AND COORDINATES REFERENCE THE OCTOBER 2005 SURVEY PERFORMED BY LOUNSBURY & ASSOCIATES, INC.
 2. HORIZONTAL COORDINATES REFERENCE NAD83 & VERTICAL ELEVATIONS REFERENCE NAVD88.

LEGEND		
ITEM	EXISTING	ULTIMATE
AIRPORT REFERENCE POINT (A.R.P.)		
ANTENNA		
BLUFF		
BUILDINGS		
BUILDING RESTRICTION LINE		
FENCE		
PROPERTY LINE		
REIL		
ROADWAYS		
ROTATING BEACON		
SHORELINE		
SURVEY MONUMENT		
THRESHOLD MARKERS/LIGHTS		
TOPOGRAPHIC CONTOURS		
TREE (LARGE SINGLE)		
TREELINE		
VASI		
VISIBILITY ZONE		
TAXIWAY DESIGNATOR		
MONUMENTS		
WIND CONE		
WIND CONE AND SEGMENTED CIRCLE		

DRAWING INDEX	
SHT No.	TITLE
1	COVER, AIRPORT DATA AND LOCATION
2	EXISTING LAYOUT PLAN
3	ULTIMATE LAYOUT PLAN
4	DECLARED DISTANCE PLAN
5	INNER PORTION OF THE APPROACH SURFACES R/W 16
6	INNER PORTION OF THE APPROACH SURFACES R/W 34
7	INNER PORTION OF THE APPROACH SURFACES R/W 05-23
8	AIRPORT AIRSPACE
9	PROPERTY MAP

AIRPORT LAYOUT PLAN CONDITIONAL APPROVAL SUBJECT TO ALP APPROVAL LETTER DATED 7/21/2006
 FAA AIRSPACE REVIEW NUMBER: 2006-AA-96-WRA
 DATE: 7/21/06
 FAA AIRPORTS DIVISION ALASKAN REGION, AAL-612

STATE OF ALASKA
 DEPARTMENT OF TRANSPORTATION
 AND PUBLIC FACILITIES
 CENTRAL REGION

McGRATH AIRPORT
 McGRATH, ALASKA
 AIRPORT LAYOUT PLAN
 COVER
 AIRPORT DATA AND LOCATION

DATE: 7/19/2006
 SHEET: 1 OF 9

APPROVED: *Robert A. Campbell* FOR
 ROBERT A. CAMPBELL, P.E. PRECONSTRUCTION ENGINEER
 RECOMMENDED: *Harvey M. Douthitt* DATE: 7/20/2006
 HARVEY M. DOUTHITT, P.E. DESIGN SECTION CHIEF

BY DATE REVISION
 10/11/12 AS-BUILT ALP PER AIP#3-02-0176-005-2006

Designed By: J. OSTERMAN
 Drawn By: M. TOLMAN
 Checked By: T. SCHMID
 Date Plotted: 10/15/2012, 8:25 AM
 Layout Name: E:\Projects\McGrath\ALP 2012 As-Built Update\Final Drawings\east-ultimate_layout.dwg
 File Name:

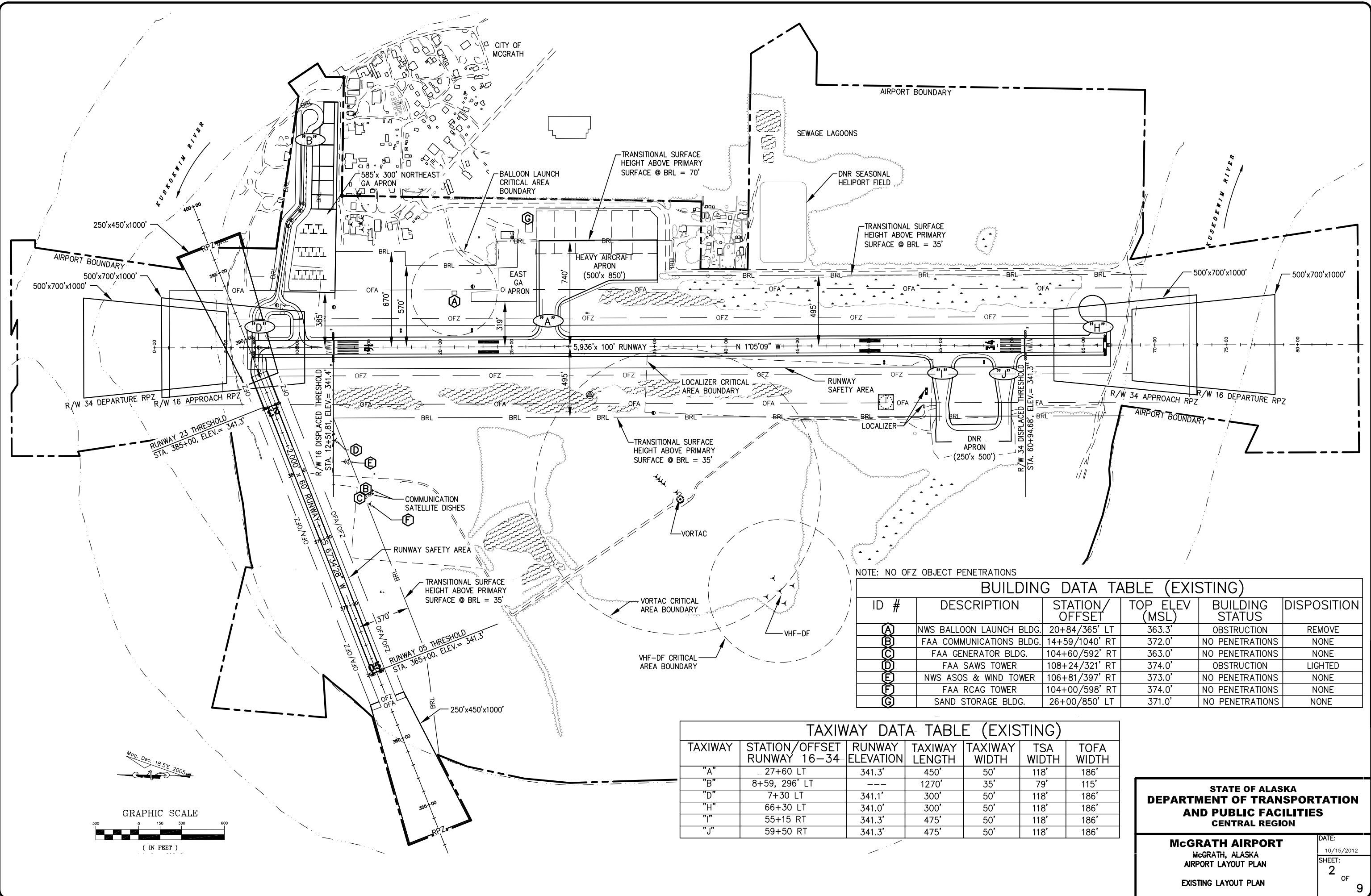

NOTE: NO OFZ OBJECT PENETRATIONS

BUILDING DATA TABLE (EXISTING)

ID #	DESCRIPTION	STATION/OFFSET	TOP ELEV (MSL)	BUILDING STATUS	DISPOSITION
(A)	NWS BALLOON LAUNCH BLDG.	20+84/365' LT	363.3'	OBSTRUCTION	REMOVE
(B)	FAA COMMUNICATIONS BLDG.	14+59/1040' RT	372.0'	NO PENETRATIONS	NONE
(C)	FAA GENERATOR BLDG.	104+60/592' RT	363.0'	NO PENETRATIONS	NONE
(D)	FAA SAWS TOWER	108+24/321' RT	374.0'	OBSTRUCTION	LIGHTED
(E)	NWS ASOS & WIND TOWER	106+81/397' RT	373.0'	NO PENETRATIONS	NONE
(F)	FAA RCAG TOWER	104+00/598' RT	374.0'	NO PENETRATIONS	NONE
(G)	SAND STORAGE BLDG.	26+00/850' LT	371.0'	NO PENETRATIONS	NONE

TAXIWAY DATA TABLE (EXISTING)

TAXIWAY	STATION/OFFSET RUNWAY 16-34	RUNWAY ELEVATION	TAXIWAY LENGTH	TAXIWAY WIDTH	TSA WIDTH	TOFA WIDTH
"A"	27+60 LT	341.3'	450'	50'	118'	186'
"B"	8+59, 296' LT	---	1270'	35'	79'	115'
"D"	7+30 LT	341.1'	300'	50'	118'	186'
"H"	66+30 LT	341.0'	300'	50'	118'	186'
"I"	55+15 RT	341.3'	475'	50'	118'	186'
"J"	59+50 RT	341.3'	475'	50'	118'	186'

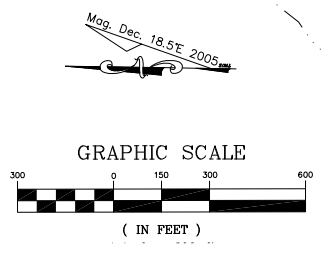

STATE OF ALASKA
DEPARTMENT OF TRANSPORTATION
AND PUBLIC FACILITIES
CENTRAL REGION

McGRATH AIRPORT
 McGRATH, ALASKA
 AIRPORT LAYOUT PLAN
 EXISTING LAYOUT PLAN

DATE:
 10/15/2012
 SHEET:
 2 OF 9

Designed By: J. OSTERMAN
 Drawn By: M. TOLMAN
 Checked By: T. SCHMID
 Date Plotted: 10/15/2012, 8:26 AM
 Layout Name: Ultimate Layout
 File Name: W:\Projects\McGrath\ALP\ALP 2012 As-Built Update\Final Drawings\asult-ultimate layout.dwg

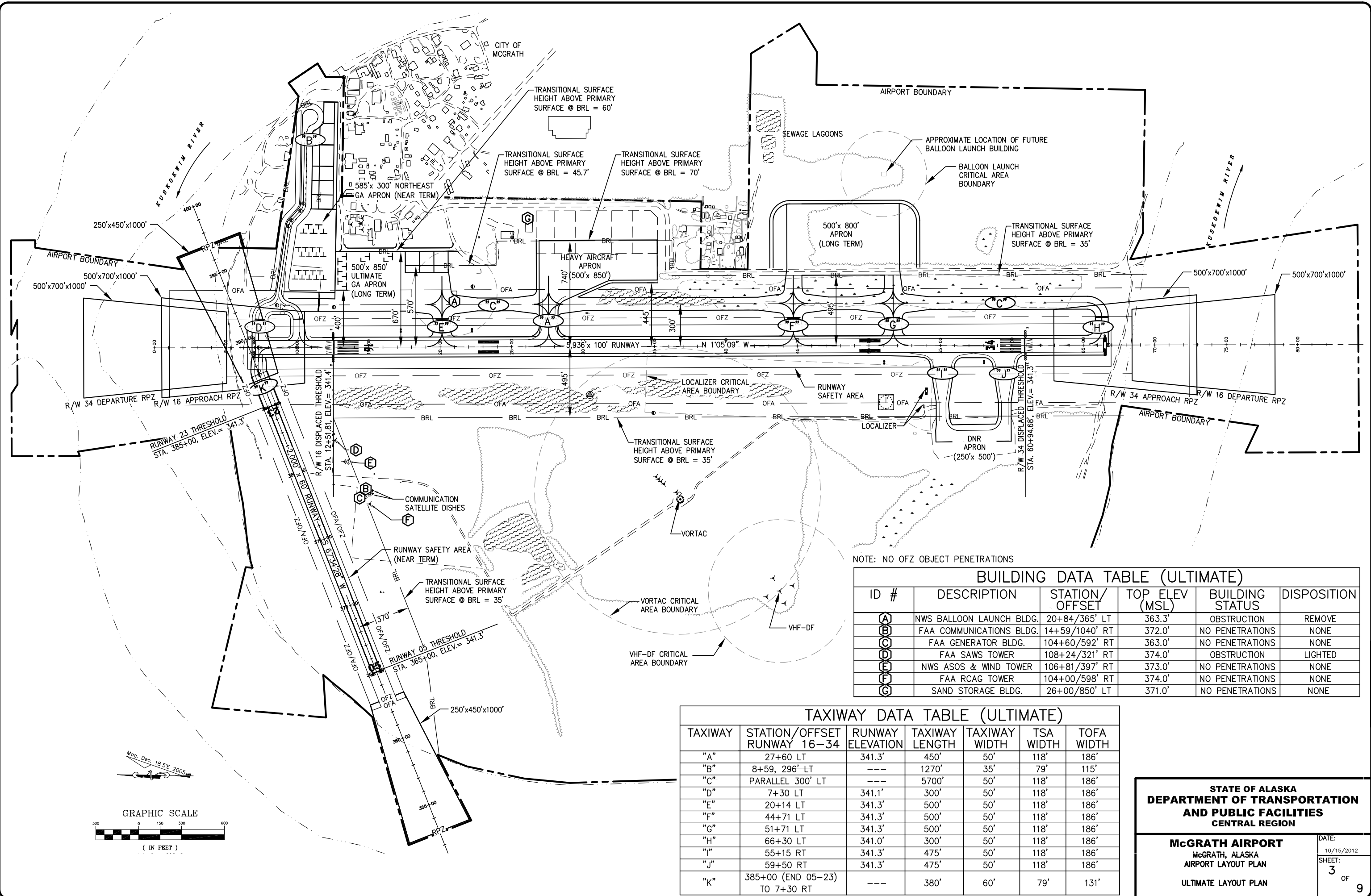

NOTE: NO OFZ OBJECT PENETRATIONS

ID #	DESCRIPTION	STATION/OFFSET	TOP ELEV (MSL)	BUILDING STATUS	DISPOSITION
A	NWS BALLOON LAUNCH BLDG.	20+84/365' LT	363.3'	OBSTRUCTION	REMOVE
B	FAA COMMUNICATIONS BLDG.	14+59/1040' RT	372.0'	NO PENETRATIONS	NONE
C	FAA GENERATOR BLDG.	104+60/592' RT	363.0'	NO PENETRATIONS	NONE
D	FAA SAWS TOWER	108+24/321' RT	374.0'	OBSTRUCTION	LIGHTED
E	NWS ASOS & WIND TOWER	106+81/397' RT	373.0'	NO PENETRATIONS	NONE
F	FAA RCAG TOWER	104+00/598' RT	374.0'	NO PENETRATIONS	NONE
G	SAND STORAGE BLDG.	26+00/850' LT	371.0'	NO PENETRATIONS	NONE

TAXIWAY	STATION/OFFSET	RUNWAY ELEVATION	TAXIWAY LENGTH	TAXIWAY WIDTH	TSA WIDTH	TOFA WIDTH
"A"	27+60 LT	341.3'	450'	50'	118'	186'
"B"	8+59, 296' LT	---	1270'	35'	79'	115'
"C"	PARALLEL 300' LT	---	5700'	50'	118'	186'
"D"	7+30 LT	341.1'	300'	50'	118'	186'
"E"	20+14 LT	341.3'	500'	50'	118'	186'
"F"	44+71 LT	341.3'	500'	50'	118'	186'
"G"	51+71 LT	341.3'	500'	50'	118'	186'
"H"	66+30 LT	341.0'	300'	50'	118'	186'
"I"	55+15 RT	341.3'	475'	50'	118'	186'
"J"	59+50 RT	341.3'	475'	50'	118'	186'
"K"	385+00 (END 05-23) TO 7+30 RT	---	380'	60'	79'	131'

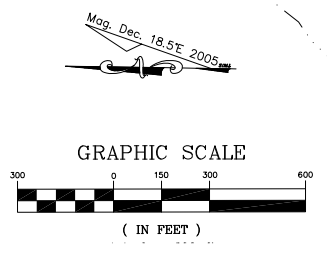

STATE OF ALASKA
DEPARTMENT OF TRANSPORTATION
AND PUBLIC FACILITIES
CENTRAL REGION

McGRATH AIRPORT
 McGRATH, ALASKA
 AIRPORT LAYOUT PLAN
 ULTIMATE LAYOUT PLAN

DATE:	10/15/2012
SHEET:	3
OF	9

Date Plotted: 10/15/2012, 8:26 AM
 Layout Name: Declared Distance
 File Name: W:\Projects\McGrath\ALP\ALP 2012 As-Built Update\Final Drawings\east-ultimate layout.dwg
 Designed By: J. OSTERMAN
 Drawn By: M. TOLMAN
 Checked By: T. SCHMID

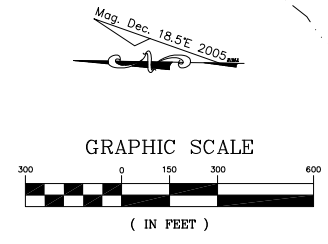
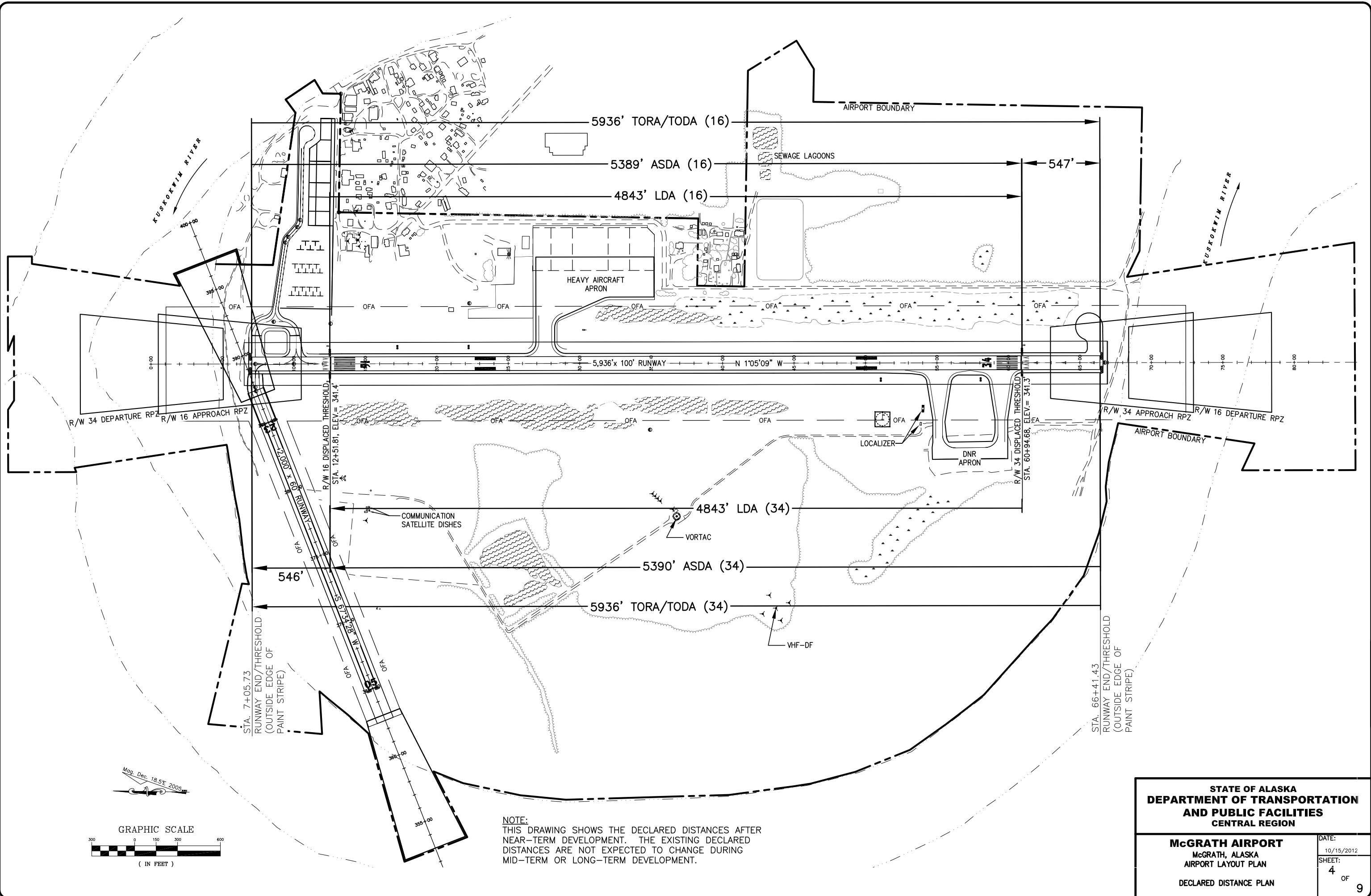

NOTE:
 THIS DRAWING SHOWS THE DECLARED DISTANCES AFTER NEAR-TERM DEVELOPMENT. THE EXISTING DECLARED DISTANCES ARE NOT EXPECTED TO CHANGE DURING MID-TERM OR LONG-TERM DEVELOPMENT.

STATE OF ALASKA DEPARTMENT OF TRANSPORTATION AND PUBLIC FACILITIES CENTRAL REGION	
McGRATH AIRPORT McGRATH, ALASKA AIRPORT LAYOUT PLAN DECLARED DISTANCE PLAN	DATE: 10/15/2012 SHEET: 4 OF 9

Designed By: J. OSTERMANN
 Drawn By: M. TOLMAN
 Checked By: T. SCHMID

Date Plotted: 10/15/2012, 8:27 AM
 Layout Name: R-W 16
 File Name: W:\Projects\McGrath\ALP\ALP 2012 As-Built\Update\Final Drawings\INNER APPROACH SURFACES.dwg

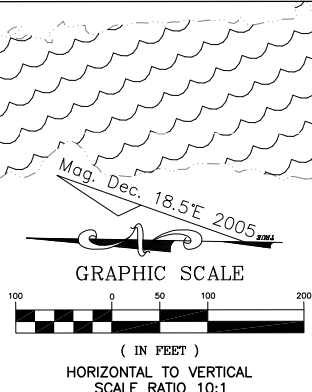
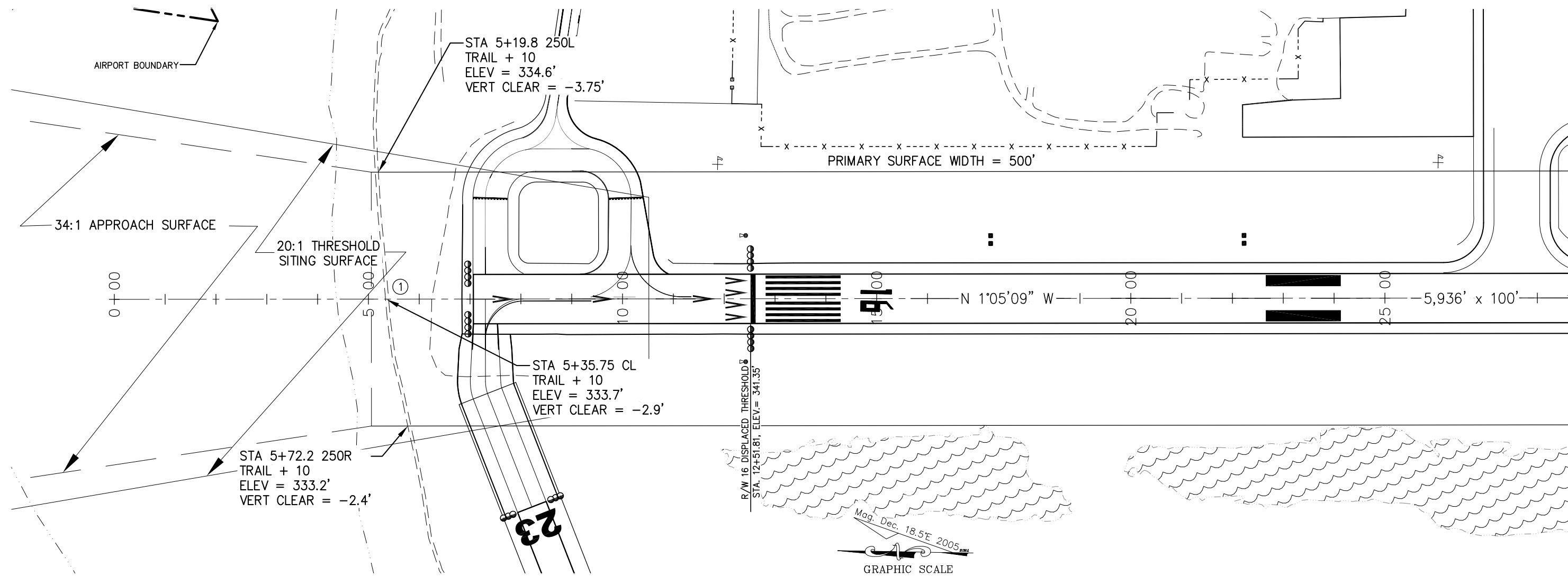

ID #	DESCRIPTION	STATION/OFFSET	ELEVATION (NAVD88)	SURFACE PENETRATED	SURFACE ELEVATION	AMOUNT PENETRATION	DISPOSITION	STAGE TO CORRECT
①	TRAIL	5+37/CL	343.7'	PRIMARY	340.87'	2.9'	NONE	N/A

NOTE: OBSTRUCTION CLEARANCE SLOPE FROM END OF PRIMARY SURFACE IS 44:1.

- NOTES:
- THERE ARE NO CONTROLLING OBSTRUCTIONS FOR RUNWAY 16, THEREFORE THE CONTROLLING OBSTRUCTION CLEARANCE SLOPE IS ESTABLISHED AS 20:1 PER FAA AC 150/5200-35A, CHAPTER 4, DATA ELEMENT NUMBER 57.
 - THERE ARE NO OBJECT PENETRATIONS IN THE RUNWAY APPROACH END SITING SURFACES OF RUNWAY 16, AS DEFINED IN FAA AC 150/5300-13, CHG 15, APPENDIX 2, TABLE A2-1, LINE 5.
 - THERE ARE NO THRESHOLD SITING SURFACE PENETRATIONS FOR THE DISPLACED THRESHOLD.

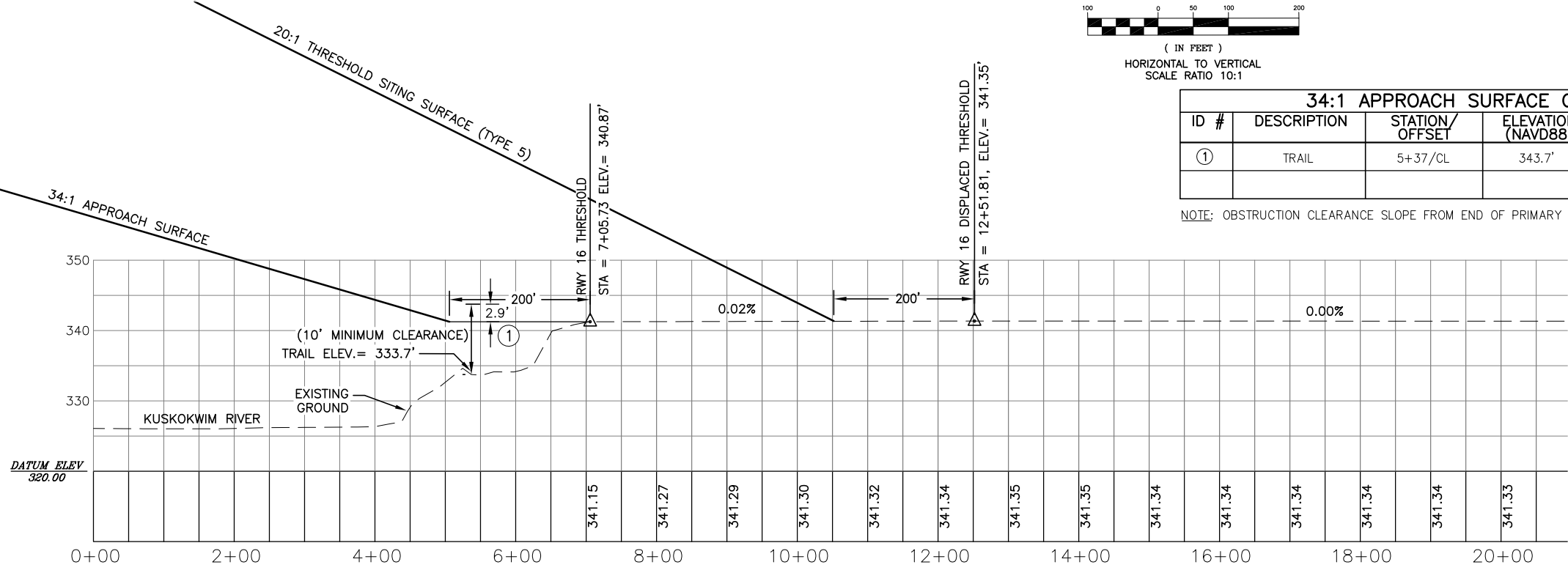

**STATE OF ALASKA
 DEPARTMENT OF TRANSPORTATION
 AND PUBLIC FACILITIES
 CENTRAL REGION**

McGRATH AIRPORT
 McGRATH, ALASKA
 AIRPORT LAYOUT PLAN

INNER PORTION OF THE APPROACH SURFACES
 RUNWAY 16

DATE: 10/15/2012.
 SHEET: 5 OF 9

Date Plotted: 10/15/2012, 8:28 AM
 Layout Name: RW 34
 File Name: W:\Projects\McGrath\ALP\ALP 2012 As-Built Update\Final Drawings\INNER APPROACH SURFACES.dwg
 Designed By: J. OSTERMANN
 Drawn By: M. TOLMAN
 Checked By: T. SCHMID

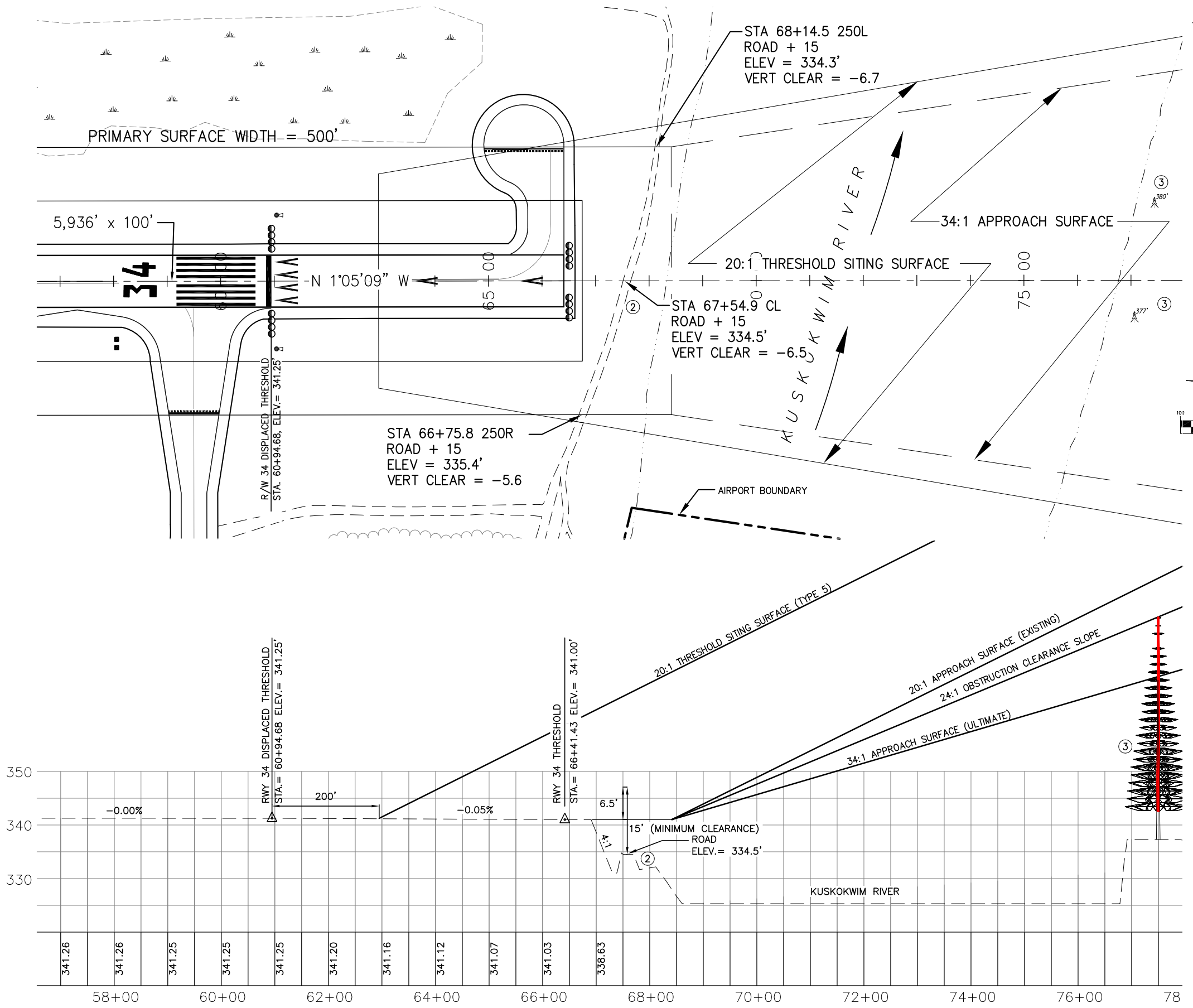

- NOTES:**
1. THERE ARE NO CONTROLLING OBSTRUCTIONS FOR RUNWAY 34, THEREFORE THE CONTROLLING OBSTRUCTION CLEARANCE SLOPE IS ESTABLISHED AS 20:1 PER FAA AC 150/5200-35A, CHAPTER 4, DATA ELEMENT NUMBER 57.
 2. THERE ARE NO OBJECT PENETRATIONS IN THE RUNWAY APPROACH END SITING SURFACES OF RUNWAY 34, AS DEFINED IN FAA AC 150/5300-13, CHG 15, APPENDIX 2, TABLE A2-1, LINE 5.
 3. THERE ARE NO THRESHOLD SITING SURFACE PENETRATIONS FOR THE DISPLACED THRESHOLD.

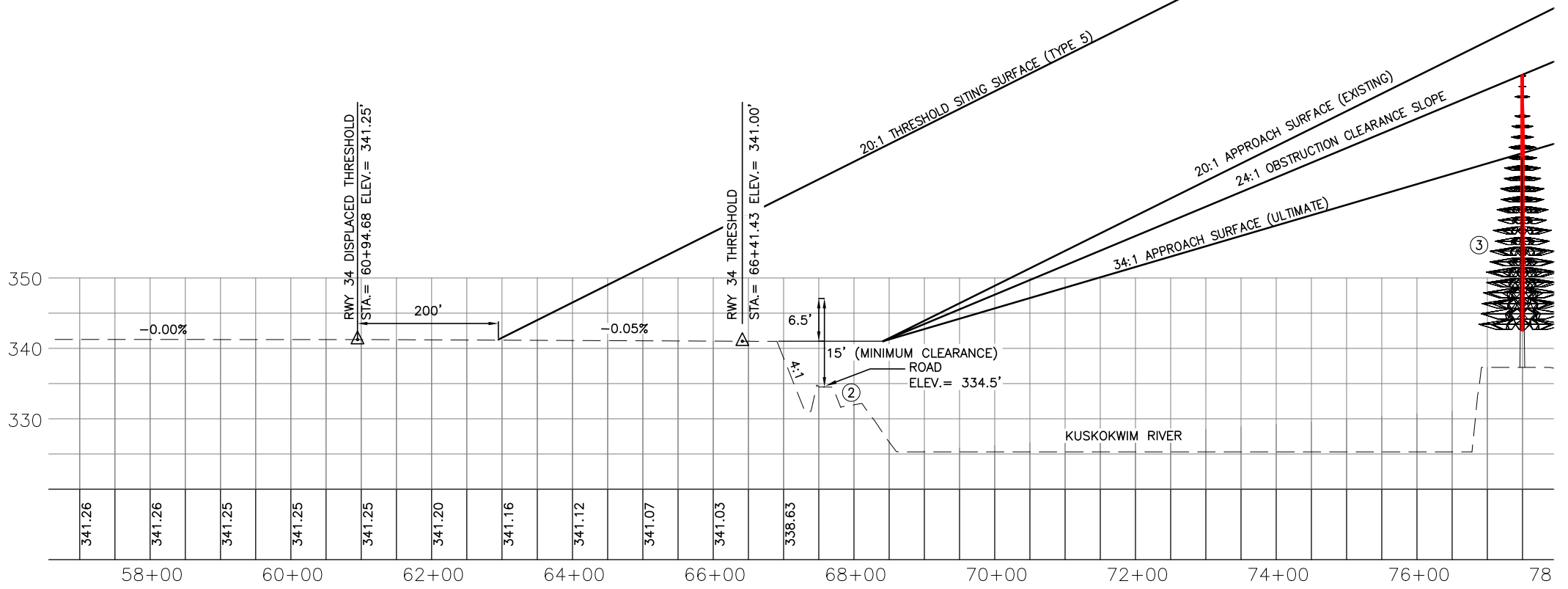
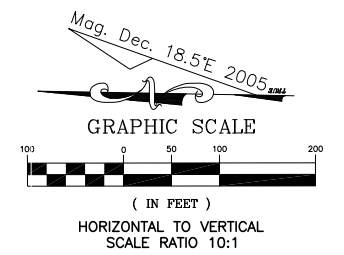

34:1 APPROACH SURFACE OBSTRUCTION TABLE (INNER PORTION RW 34)

ID #	DESCRIPTION	STATION/OFFSET	ELEVATION (NAVD88)	SURFACE PENETRATED	SURFACE ELEVATION	AMOUNT PENETRATION	DISPOSITION	STAGE TO CORRECT
②	ROAD	67+58/CL	349.5'	PRIMARY	341.0'	6.5'	NONE	N/A
③	TREES*	77+00 - 81+50 / 0' - 250' RT. & LT.	377' - 394'	APPROACH	366' - 380'	1' - 14'	REMOVE	LONG-TERM

*NOTE: TREE HEIGHTS ARE BASED ON AERIAL MAPPING FIELD SURVEY BY WALKER ALASKA AERIAL SURVEYS DATED 10/3/89. AN ADDITIONAL 5 FEET WAS ADDED TO THE TREE HEIGHTS TO ACCOUNT FOR GROWTH.

STATE OF ALASKA
DEPARTMENT OF TRANSPORTATION
AND PUBLIC FACILITIES
CENTRAL REGION

McGRATH AIRPORT
 McGRATH, ALASKA
 AIRPORT LAYOUT PLAN

INNER PORTION OF THE APPROACH SURFACES
 RUNWAY 34

DATE: 10/15/2012.
 SHEET: 6 OF 9

Date Plotted: 10/15/2012, 8:28 AM
 Layout Name: P-W 5-23
 File Name: W:\Projects\McGrath\ALP\ALP 2012 As-Built Update\Final Drawings\INNER APPROACH SURFACES.dwg
 Designed By: J. OSTERMANN
 Drawn By: M. TOLMAN
 Checked By: T. SCHMID

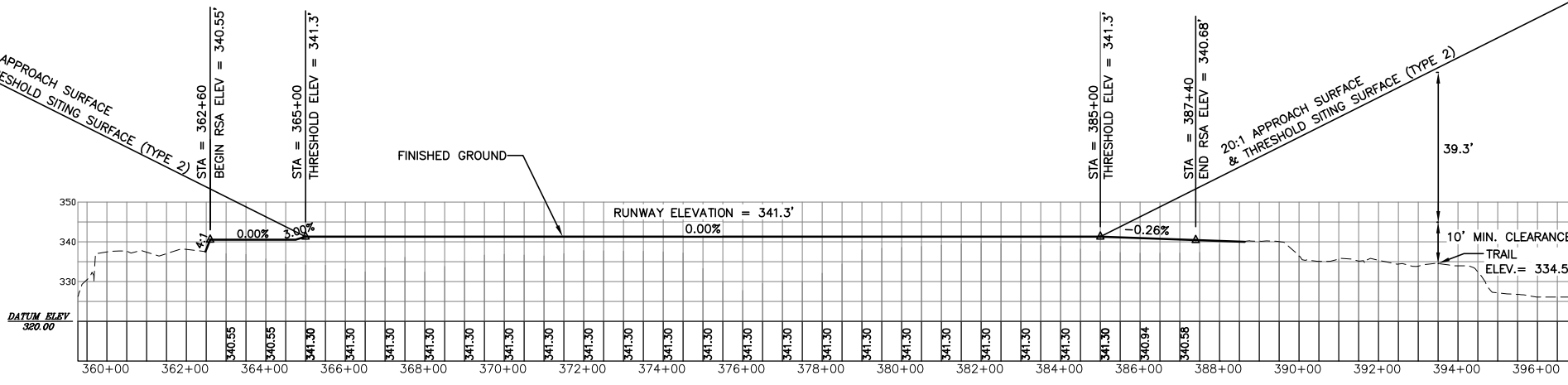
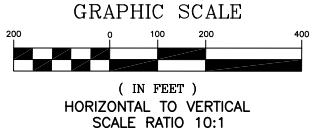
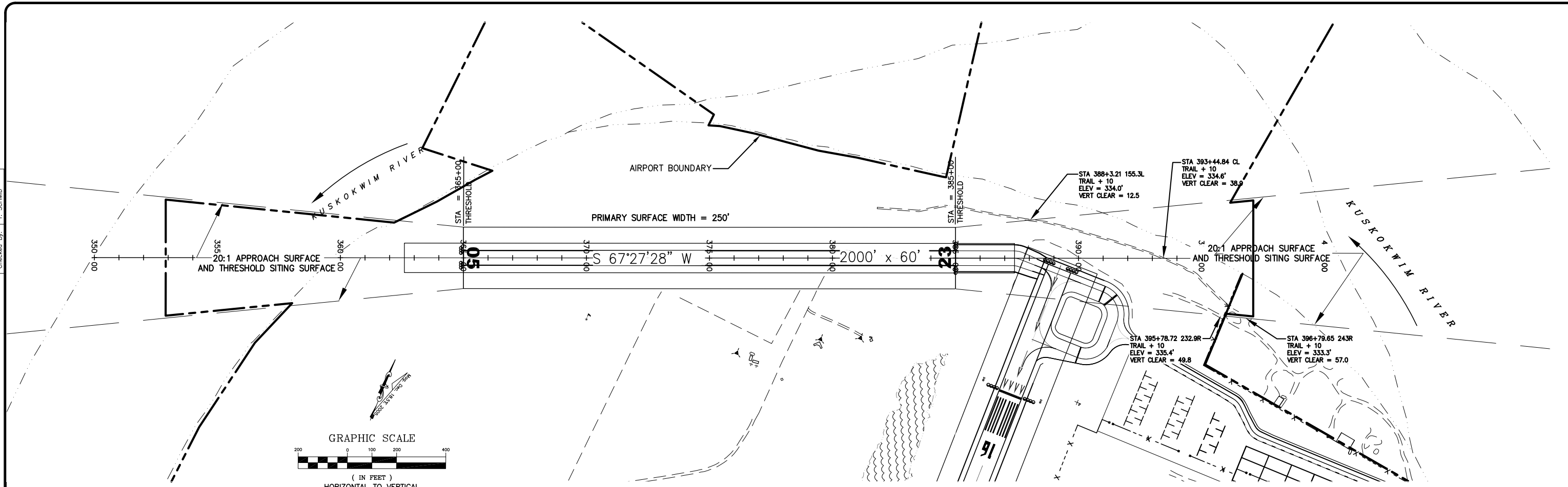

20:1 APPROACH SURFACE OBSTRUCTION TABLE (INNER PORTION RW 05/23)

ID #	DESCRIPTION	STATION/OFFSET	ELEVATION (NAVD88)	SURFACE PENETRATED	SURFACE ELEVATION	AMOUNT PENETRATION	DISPOSITION	STAGE TO CORRECT
	NONE							

- NOTES:
- THERE ARE NO CONTROLLING OBSTRUCTIONS FOR RUNWAY 5-23, THEREFORE THE CONTROLLING OBSTRUCTION CLEARANCE SLOPE IS ESTABLISHED AS 20:1 PER FAA AC 150/5200-35A, CHAPTER 4, DATA ELEMENT NUMBER 57.
 - THERE ARE NO OBJECT PENETRATIONS IN THE RUNWAY APPROACH END SITING SURFACES OF RUNWAY 5-23, AS DEFINED IN FAA AC 150/5300-13, CHG 15, APPENDIX 2, TABLE A2-1, LINE 5.
 - THERE ARE NO THRESHOLD SITING SURFACE PENETRATIONS.
 - RUNWAY 05-23 IS PROPOSED AS PART OF NEAR-TERM DEVELOPMENT.

**STATE OF ALASKA
DEPARTMENT OF TRANSPORTATION
AND PUBLIC FACILITIES
CENTRAL REGION**

McGRATH AIRPORT
McGRATH, ALASKA
AIRPORT LAYOUT PLAN

INNER PORTION OF THE APPROACH SURFACES
RUNWAY 05-23

DATE:
10/15/2012.
SHEET:
7
OF
9

Date Plotted: 10/15/2012, 8:30 AM
 Designed By: SJO
 Drawn By: MCT
 Layout Name: Property Map
 File Name: W:\Projects\McGrath AIP\Map 2012 As-Built Update\Final Drawings\Property Map.dwg
 Checked By: TJS

PROPERTY STATUS						
Parcel Number	Area *	Grantor**	DOT & PF Interest	Date Acquired	Acquired Under A.I.P. No.	Recorded Document Number
Tract I Parcel 1	533.3 Ac.± 215.81 ha.±	United States of America	Fee	4/15/66	N/A	Book 3 Page 80 Mt. McKinley Recording District
Tract II Parcel B	31.9 Ac.± 12.91 ha.±	State of Alaska DNR	Permit, Avigation & Hazard Easement & Right-of-Way	7/19/85	N/A	Book 21 Page 209 Mt. McKinley Recording District
Tract III Parcel B	36.2 Ac.± 14.65 ha.±	State of Alaska DNR	Permit, Avigation & Hazard Easement & Right-of-Way	7/19/85	N/A	Book 21 Page 209 Mt. McKinley Recording District
Tract IV Parcel B	11.7 Ac.± 4.74 ha.±	State of Alaska DNR	Permit, Avigation & Hazard Easement & Right-of-Way	7/19/85	N/A	Book 21 Page 209 Mt. McKinley Recording District
4	11.7 Ac. ± 4.72 ha.±	MTNT, LTD.	Easement & Restrictive Covenant	3/19/97	N/A	Book 32 Page 22 Mt. McKinley Recording District
5	16.3 Ac. ± 6.59 ha.±	MTNT, LTD.	Easement & Restrictive Covenant	3/19/97	N/A	Book 32 Page 22 Mt. McKinley Recording District

* NOTE: All parcels have partial meander boundaries. Some field survey meanders have not been measured in more than 25 years, and some have not even been field surveyed. All areas are approximate.

** NOTE: Grantee for all parcels is the State of Alaska DOT/PF.

FEDERAL GOVERNMENT RESERVES			
LOT	DESCRIPTION	CURRENT OCCUPANT	AREA (ACRES)
(A)	REMOTE COMMUNICATION AIR TO GROUND AND WEATHER BUREAU INSTRUMENT SITE	FAA	17.62
(B)	NONDIRECTIONAL RADIO BEACON TRACT	FAA	11.49
(C)	VORTAC SITE	FAA	103.99
(D)	LOCALIZER SITE	FAA	8.15
(E)	HOUSING & SUPPORT FACILITIES	FAA & NWS	VARIES

- Protracted Section 8
Protracted Section 7
- LEGEND**
- ⊕ Recovered GLO Brass Cap Monument
 - ⊙ Recovered Brass Cap Monument
 - ⊖ Recovered 1-1/2" Aluminum Cap
 - Former Boundary Line
 - Building Restriction Line
 - Property Boundary
 - - - Meander Lines (1944,1971,1998,2005)
 - - - Federal Government Reserve Boundary
 - - - Easement Boundary

Survey monumentation shown is based upon the following field surveys:
 1971 Dickinson-Oswald As-Built
 1989 DOT&PF Design Survey

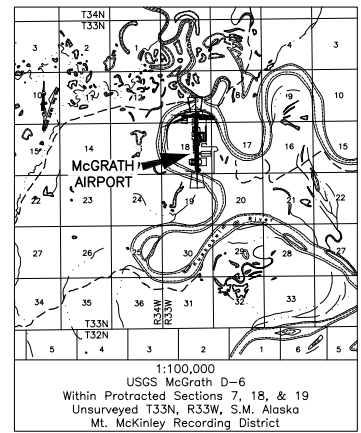

PROPERTY STATUS						
Parcel Number	Area *	Grantor**	DOT & PF Interest	Date Acquired	Acquired Under A.I.P. No.	Recorded Document Number
Tract I Parcel 1	533.3 Ac.± 215.81 ha.±	United States of America	Fee	4/15/66	N/A	Book 3 Page 80 Mt. McKinley Recording District
Tract II Parcel B	31.9 Ac.± 12.91 ha.±	State of Alaska DNR	Permit, Avigation & Hazard Easement & Right-of-Way	7/19/85	N/A	Book 21 Page 209 Mt. McKinley Recording District
Tract III Parcel B	36.2 Ac.± 14.65 ha.±	State of Alaska DNR	Permit, Avigation & Hazard Easement & Right-of-Way	7/19/85	N/A	Book 21 Page 209 Mt. McKinley Recording District
Tract IV Parcel B	11.7 Ac.± 4.74 ha.±	State of Alaska DNR	Permit, Avigation & Hazard Easement & Right-of-Way	7/19/85	N/A	Book 21 Page 209 Mt. McKinley Recording District
4	11.7 Ac. ± 4.72 ha.±	MTNT, LTD.	Easement & Restrictive Covenant	3/19/97	N/A	Book 32 Page 22 Mt. McKinley Recording District
5	16.3 Ac. ± 6.59 ha.±	MTNT, LTD.	Easement & Restrictive Covenant	3/19/97	N/A	Book 32 Page 22 Mt. McKinley Recording District

PROPERTY STATUS (CONT.)						
Parcel Number	Area *	Grantor**	DOT & PF Interest	Date Acquired	Acquired Under A.I.P. No.	Recorded Document Number
6	5.60 Ac.± 2.27 ha.±	State of Alaska DNR	Avigation and Hazard Easement	To Be Acquired	3-02-0176-005-2006	
7	0.91 Ac.± 0.37 ha.±	State of Alaska DNR	Avigation and Hazard Easement	To Be Acquired	3-02-0176-005-2006	
8	0.29 Ac.± 0.12 ha.±	City of McGrath	Avigation and Hazard Easement	To Be Acquired	3-02-0176-005-2006	
9	±192 sq. ft. ±17.83 sq. m.	Joaquin Investment, Inc.	Avigation and Hazard Easement	To Be Acquired	3-02-0176-005-2006	

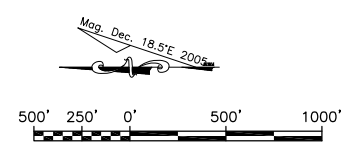

- TITLE NOTES**
- April 15, 1966. The original McGrath airport parcel is "A tract of land out of U.S. Surveys No. 1962 and No. 2646" as described in the deed from the United States of America to the State of Alaska - Book 3 Page 80 Mt. McKinley Recording District.
 - January 28, 1977. The State of Alaska, Department of Public Works transferred a portion of the original property to the State of Alaska, Department of Natural Resources by quitclaim deed.
 - July 19, 1985. The State of Alaska, Department of Transportation & Public Works obtained an Avigation and Hazard Easement Permit over waters within Tract II Parcels, Tract III Parcel B and Tract IV - Bk 21 Pg 209 Mt. McKinley Recording District.
 - March 19, 1997. The State of Alaska, Department of Transportation & Public Works obtained an Easement and Restrictive Covenant from MTNT, LTD. for Parcel 4 & 5. Bk 32 PG 22 Mt. McKinley Recording District.

**STATE OF ALASKA
DEPARTMENT OF TRANSPORTATION
AND PUBLIC FACILITIES
CENTRAL REGION**

McGRATH AIRPORT
McGRATH, ALASKA
AIRPORT LAYOUT PLAN

PROPERTY MAP

DATE: 10/15/2012
SHEET: 9 OF 9