

H:\Jobs\05-021 Palmer Airport Design 2005\CAD\Drawings\Airport Layout Plan\05021_alp-1of7, 1=1, 05/15/06 at 10:00 by unknown
 LAYOUT: 1 OF 7
 XREF: 05021_ALP-AIRPORT_05021_ALP_B001

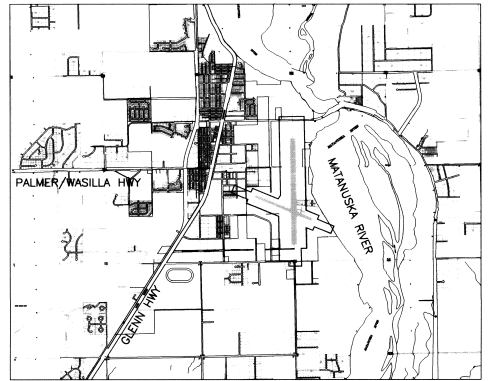

VICINITY MAP
SCALE: 1" = 1 MILE

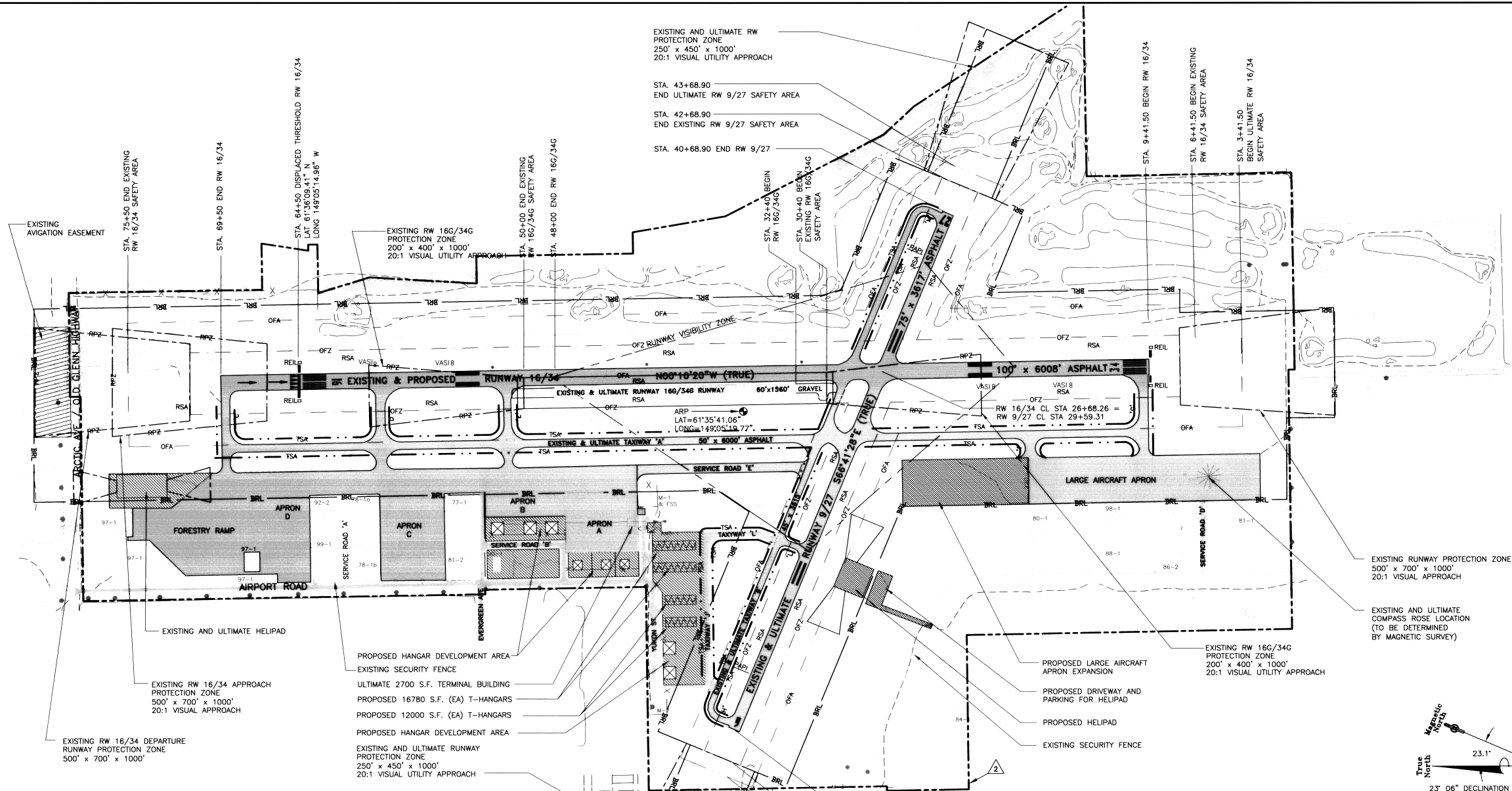
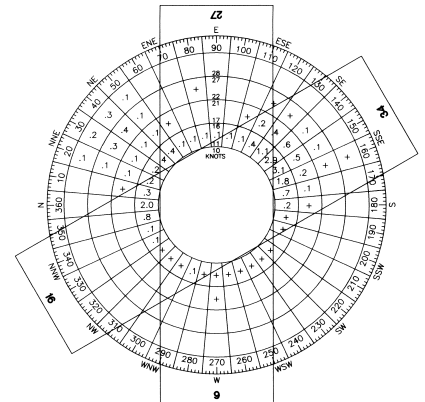

RUNWAY 09/27
 10.5 Crosswind Component = 85.92%
 13 Knot Crosswind Component = 92.10%
RUNWAY 16/34
 10.5 Crosswind Component = 96.55%
 13 Knot Crosswind Component = 97.44%
 16 Knot Crosswind Component = 98.22%
RUNWAYS 09/27 & 16/34
 Combined Crosswind Coverage = 98.37%
 Runway 09/27 @ 13 Knots
 Runway 16/34 @ 16 Knots
 Source: Environmental and Natural Resources Institute
 of the University of Alaska
 Wind Data Collected from 1993 to 1995

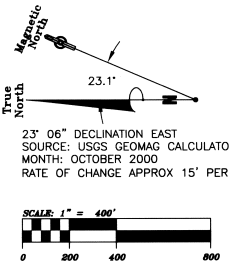

- NOTES:**
- NO THRESHOLD SITING SURFACE OBJECT PENETRATIONS FOR RUNWAY 9/27, OR 34. RUNWAY 16 REQUIRES A DISPLACED THRESHOLD OF 500 FEET FROM RUNWAY END.
 - NO OBSTACLE FREE ZONE PENETRATIONS WITH THE EXCEPTION OF FRANGIBLY MOUNTED EQUIPMENT SPECIFICALLY LOCATED FOR AERONAUTICAL USAGE.
 - THE ONLY OBSTRUCTION TO NAVIGABLE AIRSPACE AS DEFINED IN 14 CFR PART 77 IS AN AREA OF PENETRATION FROM RISING TERRAIN OF LAZY MOUNTAIN TO THE NORTH/NORTHEAST. THE PENETRATION STARTS APPROXIMATELY 4500 FEET NORTHEAST OF THE THRESHOLD FOR RUNWAY 16 AND IS NOT ON THE EXTENDED CENTERLINE OF THE RUNWAY.
 - RUNWAY 9/27 & RUNWAY 16G/34G ARE UTILITY RUNWAYS LIMITED TO USE BY AIRCRAFT OF 12,500 LBS OR LESS.
 - CONTOUR INFORMATION DATES PRIOR TO 2002.

LEGEND

	EXISTING	PROPOSED
AIRPORT PROPERTY LINE	SAME	SAME
FENCE	X	X
CONTOURS	SAME	SAME
WIND CONE AND SEGMENTED CIRCLE	SAME	SAME
AIRPORT REFERENCE POINT (ARP)	SAME	SAME
BUILDING RESTRICTION LINE (BRL)	—BRL—	—BRL—
RUNWAY PROTECTION ZONE (RPZ)	—RPZ—	—RPZ—
RUNWAY OBSTACLE FREE ZONE (OFZ)	—OFZ—	—OFZ—
RUNWAY OBJECT FREE AREA (OFA)	—OFA—	—OFA—
RUNWAY SAFETY AREA (RSA)	—RSA—	—RSA—
TAXIWAY OBJECT FREE AREA (TOFA)	—TOFA—	—TOFA—
TAXIWAY SAFETY AREA (TSA)	—TSA—	—TSA—
POWERPOLE	●	●
DISTANCE TO GO SIGN	*	*
RUNWAY MARKING SIGN	SAME	SAME
RUNWAY THRESHOLD LIGHTS	—	—
REIL	REIL □	REIL □
VASI	VASI 8	VASI 8
PAPI	PAPI	PAPI
RAIL ROAD	SAME	SAME
ROTATING BEACON	SAME	SAME
ROTATING BEAM COUNOMETER	RBC	SAME
ANEMOMETER	ANEM	SAME
AIRFIELD PAVEMENT	▨	▨
GRAVEL RUNWAY	▩	▩
PROPOSED PROPERTY ACQUISITION	▧	▧

AIRPORT DATA

	EXISTING & PROPOSED	ULTIMATE
AIRPORT ELEVATION (MSL)	241.5'	241.5'
AIRPORT REFERENCE POINT	LAT 61°35'41.06" N LONG 149°05'19.77" W	LAT 61°35'41.06" N LONG 149°05'19.77" W
MEAN MAXIMUM TEMPERATURE	58F	58F
AIRPORT AND TERMINAL NAVAIDS	—	—
AIRPORT DESIGN GROUP	16/34-ARC B-II 9/27-ARC B-II 16G/34G - ARC A-1 16/34-GPS-A 9/27-GPS-A 16G/34G	16/34-ARC B-III 9/27-ARC B-III 16G/34G - ARC A-1 16/34-GPS-A 9/27-GPS-A 16G/34G
AIRPORT APPROACH CATEGORY	MIRL (16/34, 9/27)	MIRL (16/34, 9/27)
TAXIWAY LIGHTING	MTL	MTL

DECLARED DISTANCES TABLE

	RW 16	RW 34
TAKE-OFF RUN AVAILABLE (TORA)	6008'	6008'
TAKE-OFF DISTANCE AVAILABLE (TODA)	6008'	6008'
ACCELERATE-STOP DISTANCE (ASDA)	6008'	6008'
LANDING DISTANCE AVAILABLE (LDA)	5508'	6008'

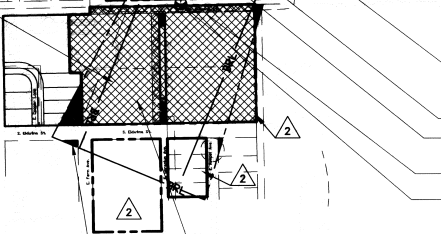

PROPOSED PROPERTY ACQUISITION

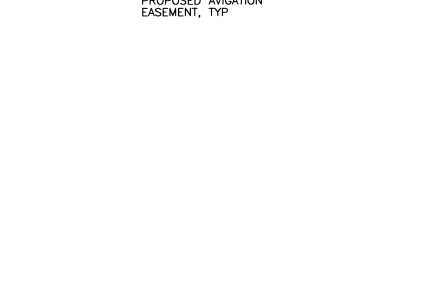

PROPOSED AVIATION EASEMENT, TYP

NON STANDARD CONDITIONS

	EXISTING	STANDARD	ULTIMATE
RW 16 SAFETY AREA LENGTH BEYOND RW END	300'	800'	800'
RW 16/34 OFA WIDTH	600'	800'	800'
RW 9 SAFETY AREA LENGTH BEYOND RW END	200'	300'	300'
RW 27 SAFETY AREA LENGTH BEYOND RW END	200'	300'	300'

RUNWAY DATA

	RUNWAY 16/34 (B-II)		RUNWAY 9/27 (B-I)		GRAVEL RUNWAY 16G/34G (A-1)	
	EXISTING	ULTIMATE	EXISTING	ULTIMATE	EXISTING	ULTIMATE
APPROACH SURFACES (VISIBILITY MINIMUMS)	20:1 (≥ 1 MILE)	20:1	20:1 (≥ 1 MILE)	20:1	20:1 (≥ 1 MILE)	SAME
DECLARED DISTANCES	SEE TABLE	SAME	NONE	SAME	NONE	SAME
INSTRUMENT RUNWAY	NO	NO	NO	NO	NO	SAME
PAVEMENT STRENGTH	>75,000 LBS	SAME	±15,000 LBS	SAME	N/A	SAME
UTILITY	NO	NO	YES	YES	YES	YES
% WIND COVERAGE	SEE WIND ROSE	SAME	SEE WIND ROSE	SAME	SAME AS 16/34	SAME
RUNWAY DIMENSIONS	100' x 6008'	SAME	75' x 3617'	SAME	60' x 1560'	SAME
RUNWAY SAFETY AREA DIMENSIONS	300' x 6008'	300' x 7208'	150' x 4017'	150' x 4215'	120' x 2040'	SAME
RSA DISTANCE BEYOND END	300' - 600'	600' - 600'	200' - 200'	300' - 300'	240' - 240'	SAME
RUNWAY END COORDINATES (NAD 83)	(16) 61°35'41.36" N (16) 149°05'14.89" W	(16) 61°35'41.36" N (16) 149°05'17.68" W	(9) 61°35'41.86" N (9) 149°04'53.67" W	SAME	(16G) 61°35'53.20" N (16G) 149°05'16.96" W	SAME
RUNWAY TOUCHDOWN ZONE ELEV	239.5 - 227.6	SAME	226.5 - 225.6	SAME	231.4 - 223.5	SAME
RUNWAY PROTECTION ZONE	500' x 700' x 1000'	SAME	250' x 450' x 1000'	SAME	200' x 400' x 1000'	SAME
RUNWAY LIGHTING	MIRL	SAME	MIRL	SAME	NONE	SAME
RUNWAY MARKING	VISUAL (BASIC)	SAME	VISUAL (BASIC)	SAME	NONE	SAME
RUNWAY OBJECT FREE AREA DIM'S	600' x 6008'	800' x 7208'	500' x 4217'	SAME	250' x 2040'	SAME
NAVAIDS, VISUAL AIDS	VASI 4	PAPI'S, REIL'S	NONE	PAPI'S	NONE	SAME
EFFECTIVE GRADIENT	0.47%	SAME	0.17%	SAME	0.50%	SAME

BUILDING & FACILITIES TABLE

STRUCTURE NUMBER	STRUCTURE HEIGHT	ELEVATION	STRUCTURE MARKING	STRUCTURE DESCRIPTION
92-2	12'	250'	NONE	BU CUSTOM AIRCRAFT
78-1a	24'	260'	NONE	AIRCRAFT PAINTING CENTER
78-1b	12'	248'	NONE	U-SHAPED HANGAR
77-1	24'	262'	NONE	MUGGET AVIATION HANGAR
81-2	20'	261'	NONE	GALLAGHER ELECTRIC HANGAR
84-1	30'	252'	NONE	SCHOOL DISTRICT WAREHOUSE
80-1	40'	260'	NONE	FORMER WOOD'S AIR HANGAR
81-1	33'	240'	NONE	NHTI SHOP
M-1	25'	258'	NONE	FSS BUILDING
M-2	20'	248'	NONE	CITY STORAGE
M-3	35'	260'	NONE	FIRE DEPT TRAINING AREA
ANT-1	62'	295'	LIGHTED	ANTENNA
FSS	65'	294'	LIGHTED	BEACON
88-1	30'	255'	NONE	NHTI HANGAR
86-2	20'	240'	NONE	NHTI WAREHOUSE
90-1	22'	253'	NONE	CITY OF PALMER MAINTENANCE
98-1	22'	243'	NONE	NHTI OFFICE BUILDING
97-1	24'	273'	NONE	STATE FORESTRY OFFICE
97-1	26'	279'	NONE	STATE FORESTRY WAREHOUSE
97-1	55'	300'	NONE	STATE FORESTRY HANGAR
97-1	100'	348'	LIGHTED	FORESTRY ANTENNA
99-1	24'	260'	NONE	MOUNTAIN FLYERS HANGAR

APPROVAL SIGNATURES

Name of Airport: Palmer Municipal

Date of Sponsor Review: 5/25/06

Name of Sponsor Project Manager Responsible for ALP: JANE DALE

Signature of Sponsor Submitting ALP to FAA for Review: Jane Dale

FAA Airspace Review Number 2004-AAL-10NRA
 Airport Layout Plan Conditional Approval Subject To ALP Approval Letter Dated: 5/25/06

BY: [Signature] DATE: 6/2/06
 FAA Airports Division
 Alaska Region, AAL-601



**CITY OF PALMER
PALMER MUNICIPAL AIRPORT
AIRPORT LAYOUT PLAN
PALMER, ALASKA**

DRAWN BY: _____ ENGINEER
 DESIGNED BY: _____ DATE: 05-9-06
 SCALE: AS NOTED JOB #: 01-005
 PATH: _____
 FILE NO. 1st 7-Layout SHEET: 1 OF 7

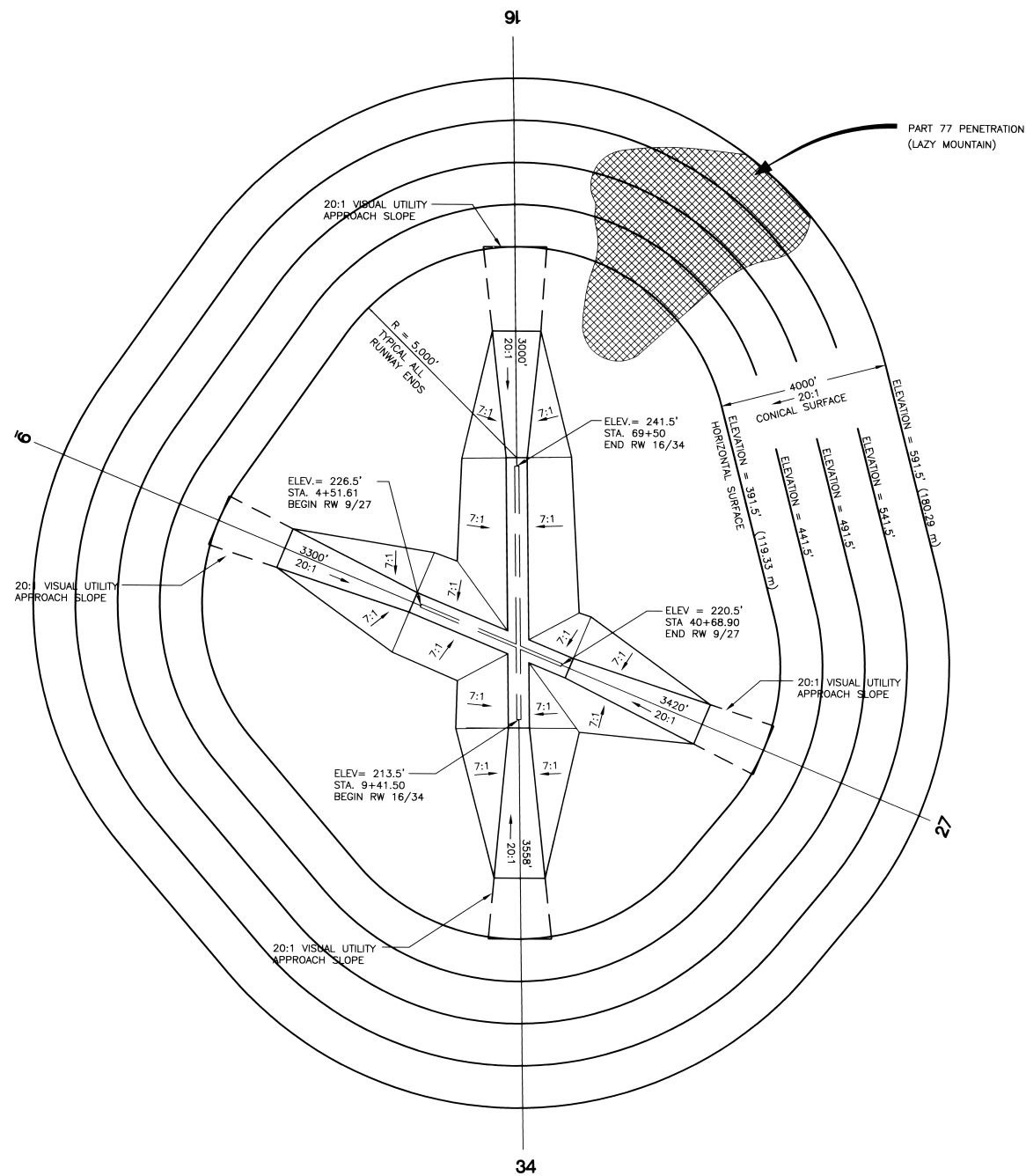

1 PART 77 AIRSPACE PLAN
SCALE: 1" = 2000'

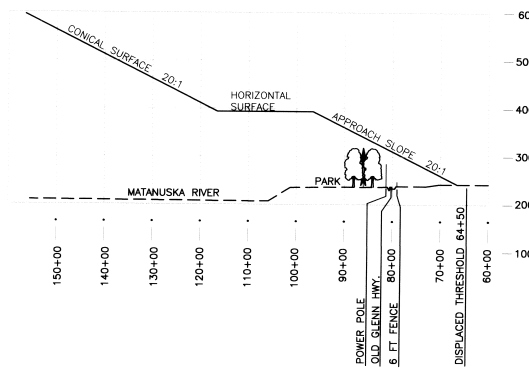

4 RUNWAY 16 APPROACH PROFILE
SCALE: 1" = 2000'

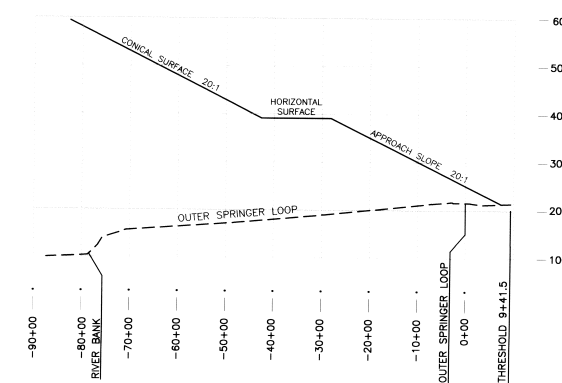

2 RUNWAY 34 APPROACH PROFILE
SCALE: 1" = 2000'

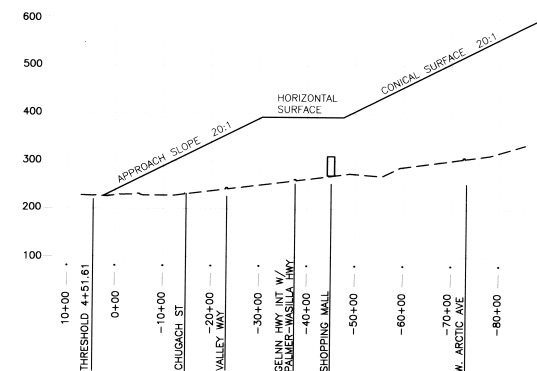

5 RUNWAY 09 APPROACH PROFILE
SCALE: 1" = 2000'

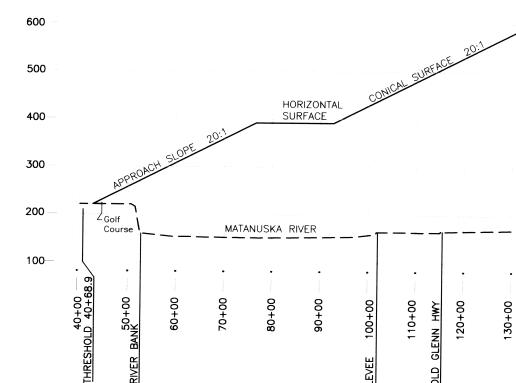

3 RUNWAY 27 APPROACH PROFILE
SCALE: 1" = 2000'

NOTES:

RUNWAY 16/34 IS 6008 FEET IN LENGTH AS SHOWN. PRIMARY SURFACE IS 500 FEET WIDE BY 6408 FEET IN LENGTH. RUNWAY 9/27 IS 3615 FEET IN LENGTH AS SHOWN. PRIMARY SURFACE IS 250 FEET WIDE BY 4015 FEET IN LENGTH.

THERE ARE NO MANMADE OBSTRUCTIONS IN THE APPROACHES, AND NO NATURAL OBSTRUCTIONS OTHER THAN THE RISING TERRAIN OF LAZY MOUNTAIN TO THE NORTHEAST OF RUNWAY 16 AS SHOWN. THE PENETRATION IS NOT ON THE EXTENDED CENTERLINE OF THE RUNWAY.

BASE MAPS USED ARE U.S.G.S. 1:25000 QUAD MAPS, QUAD C6 ANCHORAGE (NE, NW, SE, & SW).

RUNWAY ELEVATIONS AND PART 77 ELEVATIONS ARE SHOWN IN U.S. IMPERIAL FEET ABOVE MEAN SEA LEVEL (MSL).

THE MOST RECENT USGS QUAD MAP AT 1:25000 WAS USED, SO THE CONTOURS AND ELEVATIONS ON QUAD MAP ARE METRIC. THE OLDER 1:24000 QUAD MAP WITH ELEVATIONS IN ENGLISH UNITS IS NO LONGER AVAILABLE.

REVISIONS	SYMBOL	DESCRIPTION	APPD BY	DATE
3				
4				
5				
2				
1				

APPROVAL SIGNATURES

Name of Airport: Palmer Municipal
Date of Sponsor Review: _____
Name of Sponsor Project Manager Responsible for ALP: _____
Signature of Sponsor Submitting ALP to FAA for Review: _____

FAA Airspace Review Number 2004-AAL-10NRA
Airport Layout Plan Conditional Approval Subject To ALP Approval Letter Dated: 7/26/04
BY: [Signature] FOR DATE: 7/26/04
FAA, Airports Division
Alaska Region, AAL-601

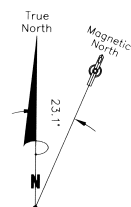

**CITY OF PALMER
PALMER MUNICIPAL AIRPORT
AIRSPACE DRAWING
PALMER, ALASKA**

DRAWN BY: _____ ENGINEER
DESIGNED BY: _____ DATE: 05-01-04
SCALE: AS NOTED JOB #: 01-005
FILE NO. 2 of 7-Layout SHEET: 2 OF 7

FINAL
05-01-2004



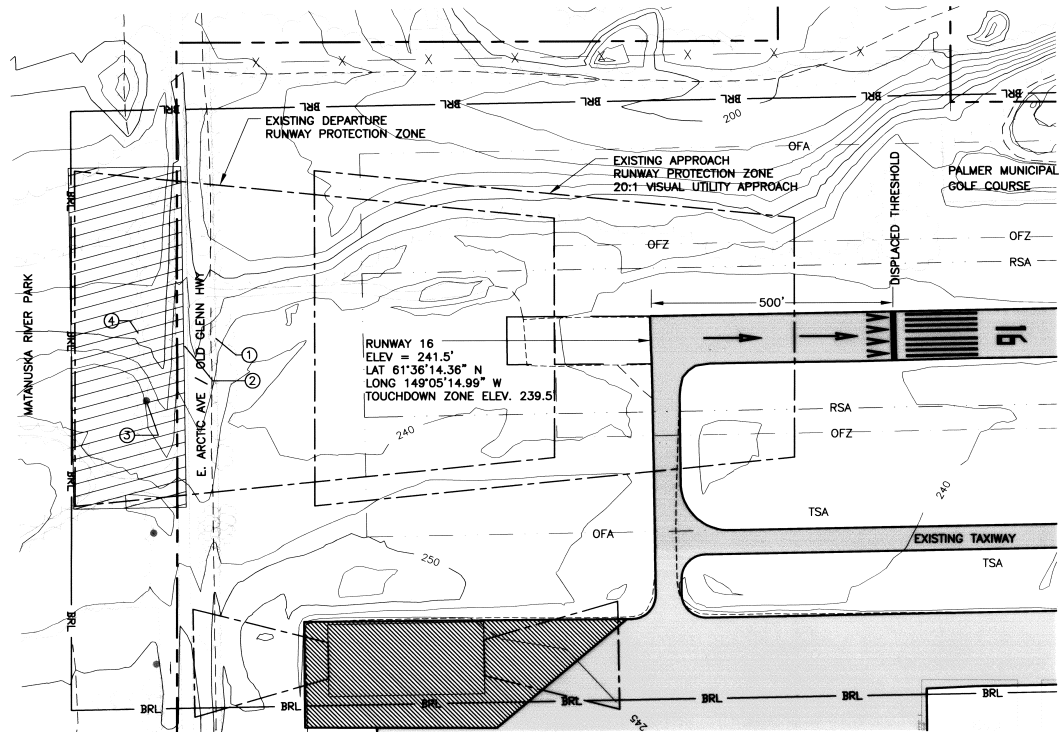

1 RUNWAY 16 PLAN
3 SCALE: HORZ: 1"=200'

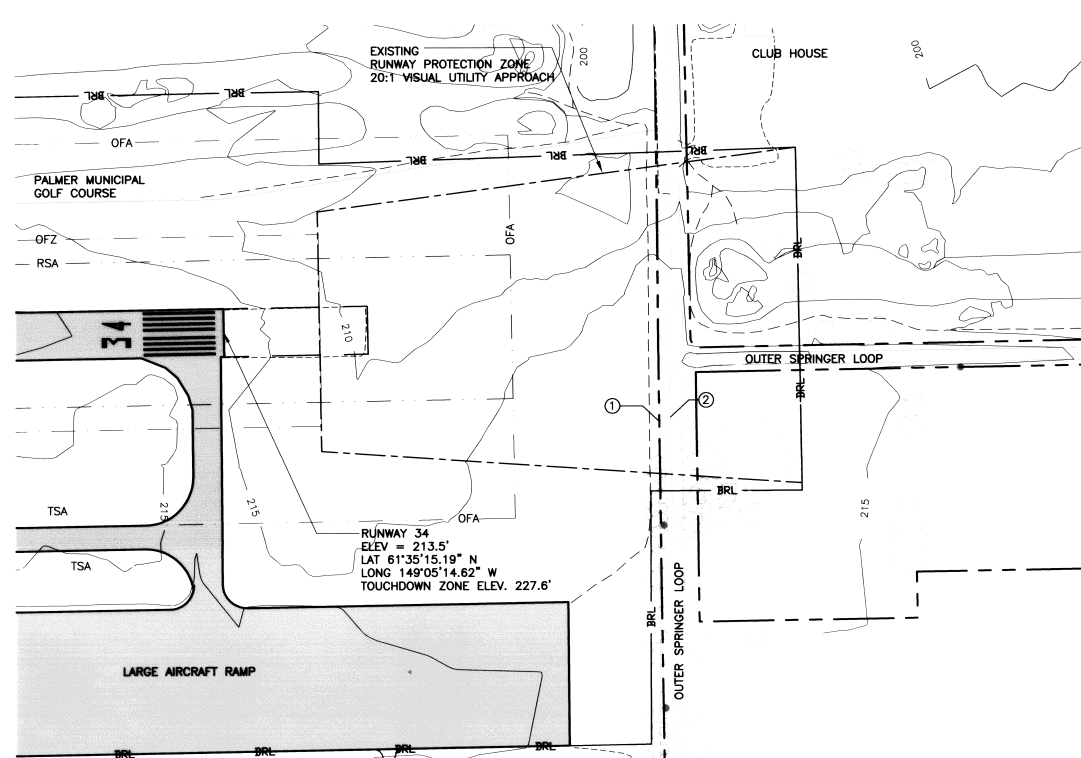

2 RUNWAY 34 PLAN
3 SCALE: HORZ: 1"=200'

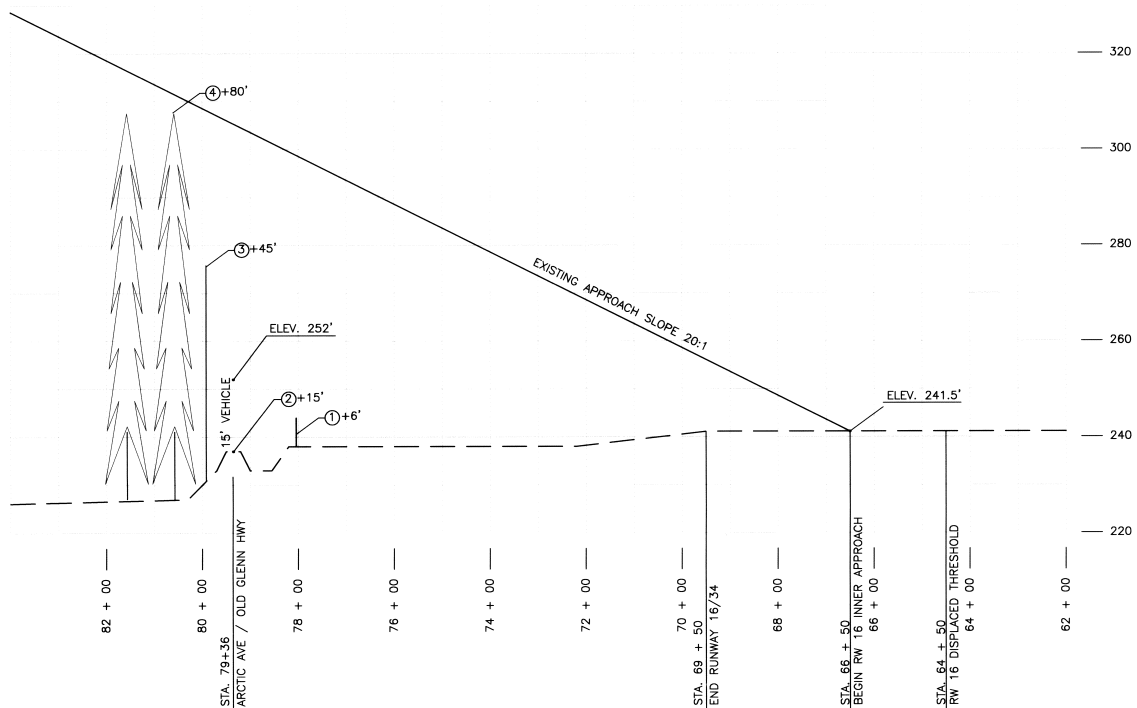

3 RUNWAY 16 APPROACH PROFILE
3 SCALE: HORZ: 1"=200' VERT: 1"= 20'

RUNWAY 16 APPROACH CLEARANCES			
NO.	OBJECT	ESTIMATED ELEVATION	CLEAR DISTANCE
1	FENCE	238 + 6'	APPROACH SURFACE CLEARED BY 56'
2	PUBLIC ROAD	237 + 15'	APPROACH SURFACE CLEARED BY 53'
3	POWER POLE	231 + 45'	APPROACH SURFACE CLEARED BY 32'
4	TREES	227 + 80'	APPROACH SURFACE CLEARED BY 4' PER SURVEY OF MARCH 24, 1999

THERE ARE NO OBSTRUCTIONS TO FAR PART 77 SURFACES.

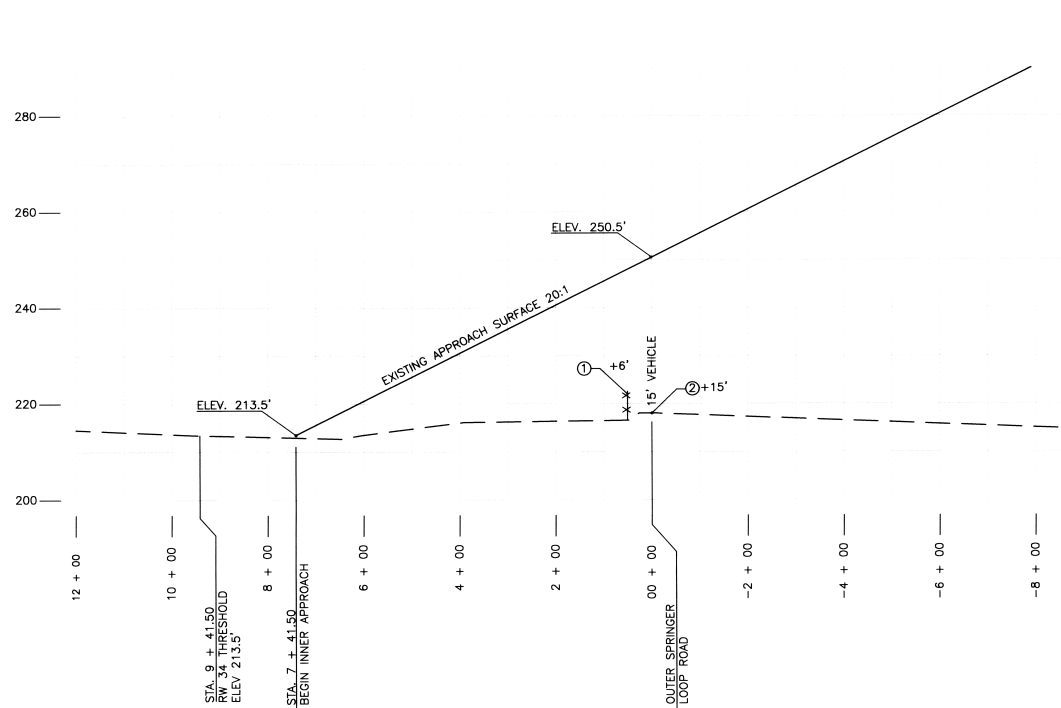

4 RUNWAY 34 APPROACH PROFILE
3 SCALE: HORZ: 1"=200' VERT: 1"= 20'

RUNWAY 34 APPROACH CLEARANCES			
NO.	OBJECT	ESTIMATED TOP ELEV.	CLEAR DISTANCE
1	FENCE	216.5 + 6'	APPROACH SURFACE CLEARED BY 25'
2	PUBLIC ROAD	218 + 15'	APPROACH SURFACE CLEARED BY 17.5'

THERE ARE NO OBSTRUCTIONS TO FAR PART 77 SURFACES.



SYMBOL	DESCRIPTION	APPD BY	DATE
5			
4			
3			
2			
1			

APPROVAL SIGNATURES

Name of Airport: Palmer Municipal
Date of Sponsor Review: _____
Name of Sponsor Project: _____
Manager Responsible for ALP: _____
Signature of Sponsor Submitting ALP to FAA for Review: _____

FAA Airspace Review Number 2004-AAL-10NRA
Airport Layout Plan Conditional Approval Subject to
ALP Approval Letter Dated: 7/26/04
By: [Signature] / FOR DATE: 7/26/04
FAA, Airports Division
Alaska Region, AAL-601

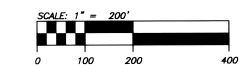
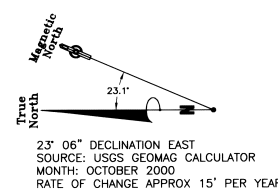

FINAL
05-01-2004

CITY OF PALMER
PALMER MUNICIPAL AIRPORT
INNER PORTION OF APPROACH
PALMER, ALASKA

DRAWN BY: _____ ENGINEER
DESIGNED BY: _____ DATE: 05-01-04
SCALE: AS NOTED JOB #: 01-005
PATH:
FILE NO. 3 of 7-Layout SHEET: 3 OF 7

H:\jobs\03-013 Palmer Airport Aprons\cad\drawings\ALP\alp-3of7_1=1_06/01/04 at 11:55 by cob
LAYOUT: 3 OF 6
XREF: AIRPORT_BD01

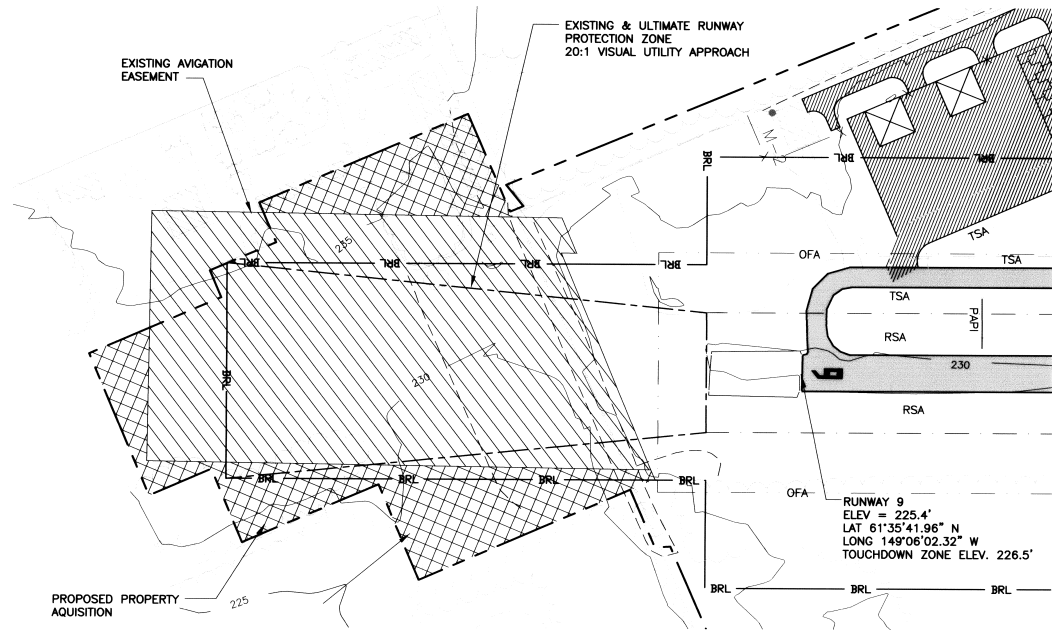

1 RUNWAY 9 PLAN
SCALE: HORZ: 1"=200'

RUNWAY 9
ELEV = 225.4'
LAT 61°35'41.96" N
LONG 149°06'02.32" W
TOUCHDOWN ZONE ELEV. 226.5'

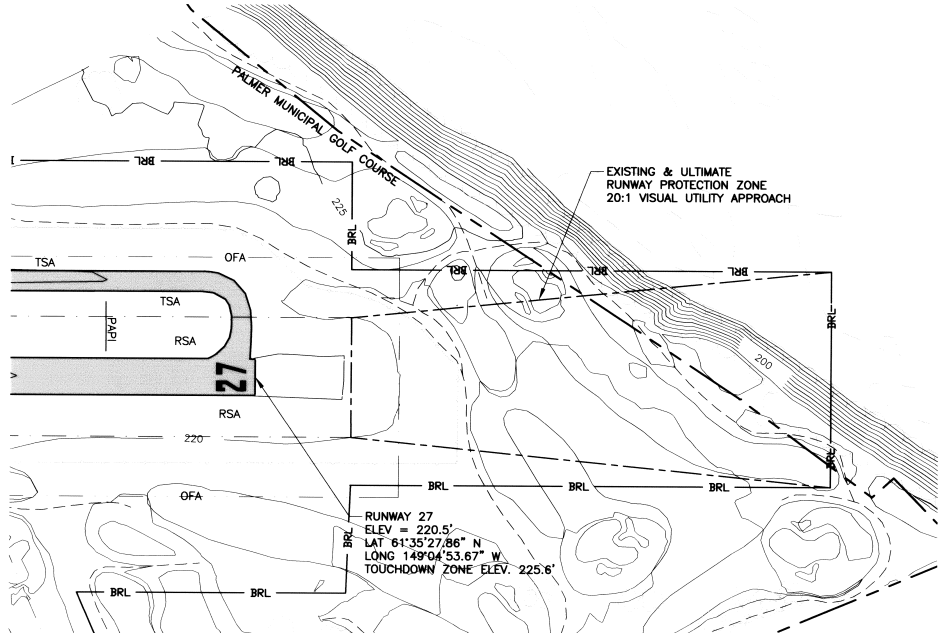

2 RUNWAY 27 PLAN
SCALE: HORZ: 1"=200'

RUNWAY 27
ELEV = 220.5'
LAT 61°35'27.86" N
LONG 149°04'53.67" W
TOUCHDOWN ZONE ELEV. 225.6'

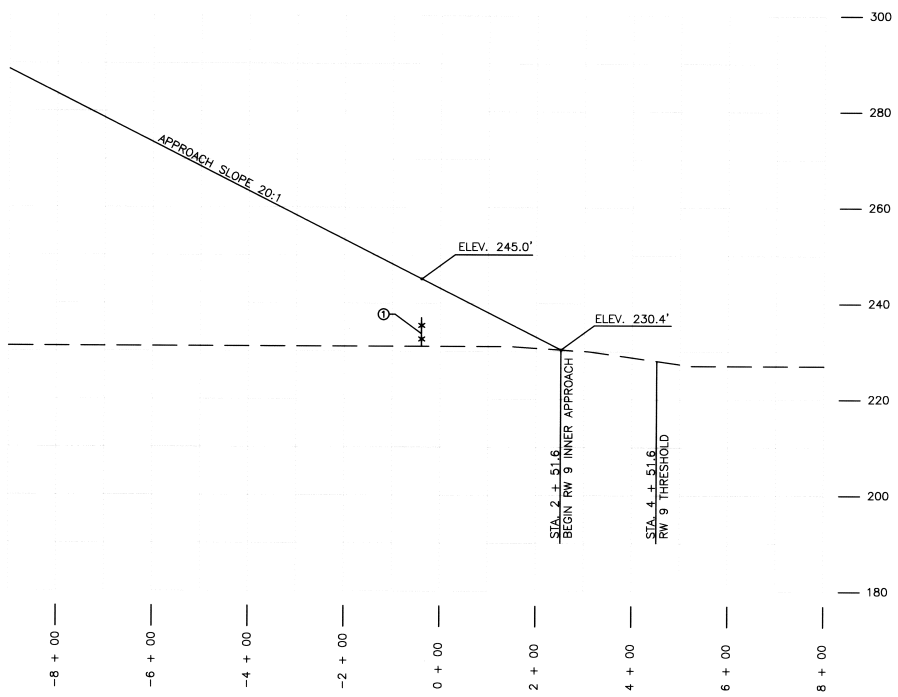

3 RUNWAY 9 APPROACH PROFILE
SCALE: HORZ: 1"=200' VERT: 1"= 20'

RUNWAY 9 APPROACH CLEARANCES			
NO.	OBJECT	ESTIMATED TOP ELEV.	CLEAR DISTANCE
1	FENCE	231 + 6'	APPROACH SURFACE CLEARED BY 8'

THERE ARE NO OBSTRUCTIONS TO FAR PART 77 SURFACES.

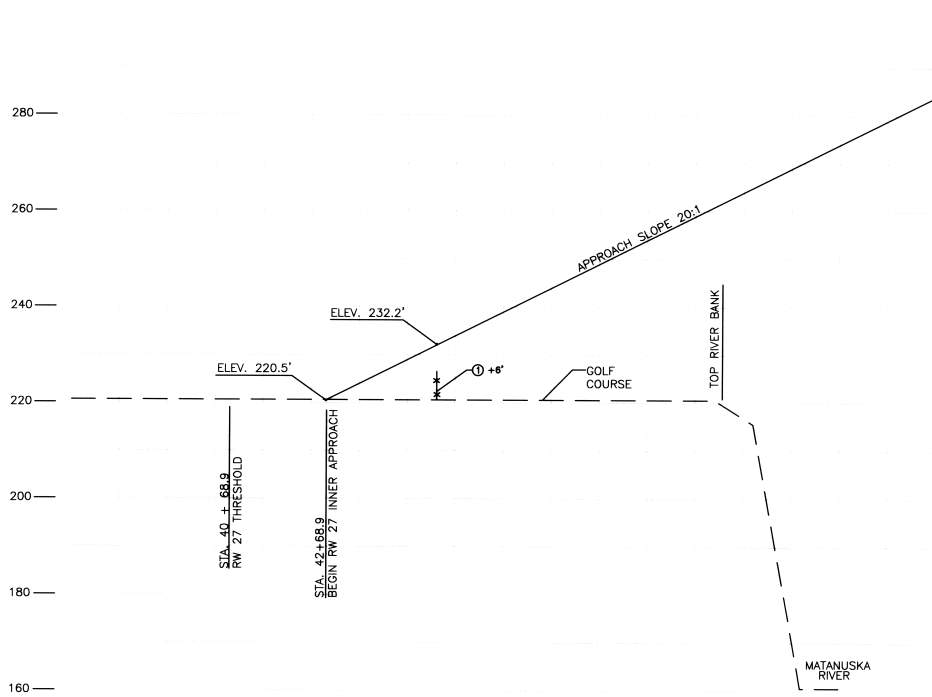

3 RUNWAY 27 APPROACH PROFILE
SCALE: HORZ: 1"=200' VERT: 1"= 20'

RUNWAY 27 APPROACH CLEARANCES			
NO.	OBJECT	ESTIMATED TOP ELEV.	CLEAR DISTANCE
1	FENCE	220.5' + 6'	APPROACH SURFACE CLEARED BY 5.7'

THERE ARE NO OBSTRUCTIONS TO FAR PART 77 SURFACES.



SYMBOL	DESCRIPTION	APPD BY	DATE
△			
△			
△			
△			

APPROVAL SIGNATURES

Name of Airport: Palmer Municipal
Date of Sponsor Review: _____
Name of Sponsor Project: _____
Manager Responsible for ALP: _____
Signature of Sponsor Submitting ALP to FAA for Review: _____

FAA Airspace Review Number 2004-AAL-10NRA
Airport Layout Plan Conditional Approval Subject To
ALP Approval Letter Dated: 7/26/04
BY: [Signature] DATE: 7/26/04
FAA, Airports Division
Alaska Region, AAL-601

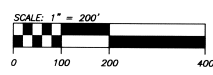
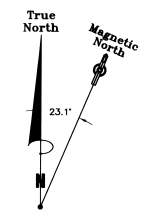

FINAL
05-01-04

**CITY OF PALMER
PALMER MUNICIPAL AIRPORT
INNER PORTION OF APPROACH
PALMER, ALASKA**

DRAWN BY: _____ ENGINEER
DESIGNED BY: _____ DATE: 05-01-04
SCALE: AS NOTED JOB #: 01-005
PATH: _____
FILE NO. 4 of 7-Layout SHEET: 4 OF 7

C:\jps\03_013_palmer_atb\cadd\drawings\ALP-cb-edits\4of6-RPZ-9-27revised, 1=1, 05/24/04 at 11:16 by cob
LAYOUT: 4 OF 6
XREF: AIRPORT_BD01

H:\Jobs\05-021_Palmer Airport Design 2005\CAD\Drawings\Airport Layout_Plan\05021_alp_5of7.dwg, 1=1, 05/15/06 at 09:52 by unknown
 LAYOUT: 5 OF 7
 XREF: 05021_ALP-AIRPORT, 05021_ALP_B001

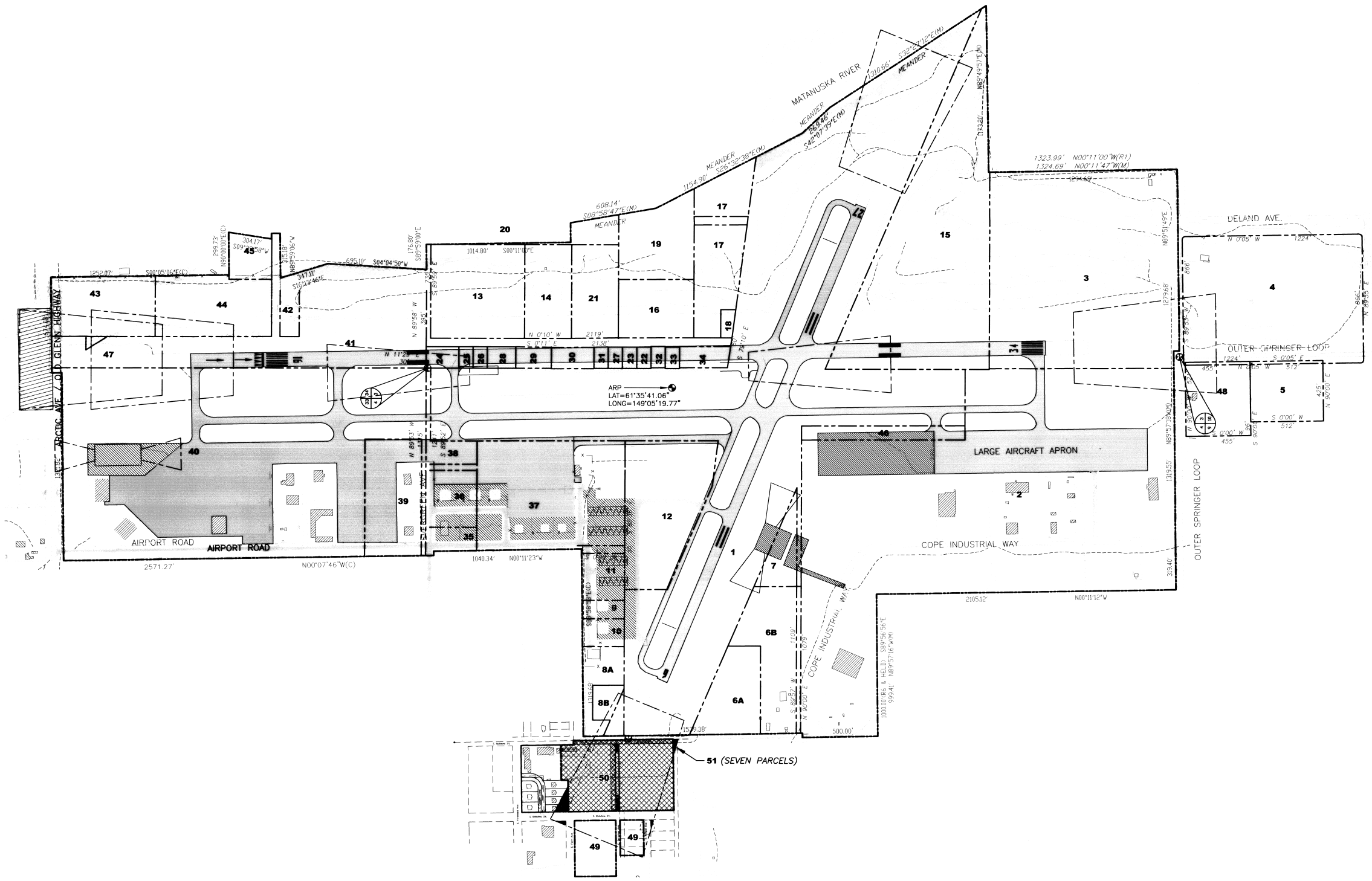

TRACT OR PARCEL No.	HOW ACQUIRED	DATE ACQUIRED
1	DEEDED FROM STATE	5/10/63
2	FAA GRANT	7/13/77
3	FAA GRANT	4/75
4	FAA GRANT & CITY	5/86
5	FAA GRANT	11/86
6	FAA GRANT	8/77
7	FAA GRANT	8/77
8	FAA GRANT	2/80
9	FAA GRANT	UNKNOWN
10	FAA GRANT	10/74
11	FAA GRANT	4/75
12	FAA GRANT	UNKNOWN
13	FAA GRANT	1/75
14	FAA GRANT	2/76
15	FAA GRANT	7/77
16	FAA GRANT	8/77
17	FAA GRANT	8/71, 12/71, 10/78, & 1975
18	FAA GRANT	7/78
19	FAA GRANT	UNKNOWN
20	FAA GRANT	UNKNOWN
21	FAA GRANT	UNKNOWN
22	FAA GRANT	8/78
23	FAA GRANT	8/77
24	FAA GRANT	10/78
25	FAA GRANT	5/75
26	FAA GRANT	UNKNOWN
27	FAA GRANT	8/77
28	FAA GRANT	8/78
29	FAA GRANT	9/77
30	FAA GRANT	12/74
31	FAA GRANT	5/75
32	FAA GRANT	7/75
33	FAA GRANT	9/77
34	FAA GRANT	9/77
35	FAA GRANT	10/74
36	FAA GRANT	4/75
37	FAA GRANT	10/78
38	FAA GRANT	3/75
39	FAA GRANT	7/75
40	FAA GRANT	7/75
41	FAA GRANT	4/75
42	FAA GRANT	4/75
43	FAA GRANT	1/75
44	FAA GRANT	11/79
45	FAA GRANT	12/74
46	FAA GRANT	AVIGATION EASEMENT
47	FAA GRANT	AVIGATION EASEMENT
48	FAA GRANT	8/94
49	FAA GRANT ALP 11-2004	8/04
50	FUTURE ACQUISITION	
51	FUTURE EASEMENT	

NOTES:
 1. BEARINGS AND DISTANCE SHOWN WERE OBTAINED OR COMPUTED BASED ON A LEGAL DESCRIPTION PROVIDED BY ALASKA FIRST TITLE INSURANCE AGENCY, INC. DATED MARCH 28, 1997, EXCEPT AS NOTED BELOW.
 2. MEANDERS SHOWN ALONG THE WEST BANK OF THE MATANUSKA RIVER ARE APPROXIMATE, AND ARE SHOWN FOR AREA CALCULATIONS ONLY.
 3. THIS MAP DEPICTS THE GENERAL OWNERSHIP OF PROPERTIES AT OR AROUND THE PALMER MUNICIPAL AIRPORT AND IS NOT A LEGAL REPRESENTATION OF SAID LANDS. A SURVEYOR LICENSED IN THE STATE OF ALASKA SHALL VERIFY ALL DIMENSIONS AND DESCRIPTIONS FOR ANY LEGAL OR CONSTRUCTION PURPOSES.
 4. EXISTING EASEMENTS AND/OR RIGHT-OF-WAYS THAT ENCRONCH ON AIRPORT PROPERTY ARE TO BE VACATED BY A RE-PLAT OF THE AIRPORT PROPERTY SCHEDULED FOR COMPLETION IN AUGUST 2004.

LEGEND



REVISION	SYMBOL	DESCRIPTION	APPD BY	DATE
1	▲			
2	▲			
3	▲			
4	▲	UPDATED PARCELS	SEH	5/11/06

APPROVAL SIGNATURES
 Name of Airport: Palmer Municipal
 Date of Sponsor Review: 5/25/06
 Name of Sponsor Project Manager Responsible for ALP: JANE DALE
 Signature of Sponsor Submitting ALP to FAA for Review: *Jane Dale*
 FAA Airspace Review Number 2004-AAL-10NRA
 Airport Layout Plan Conditional Approval Subject To ALP Approval Letter Dated: 6/2/06
 BY: *[Signature]* DATE: 6/2/06
 FAA Airports Division
 Alaska Region, AAL-601

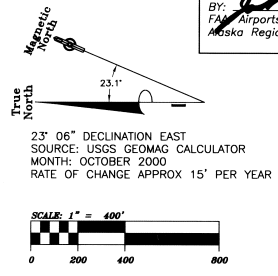

CITY OF PALMER
 PALMER MUNICIPAL AIRPORT
 AIRPORT PROPERTY PLAN
 PALMER, ALASKA
 DRAWN BY: ENGINEER
 DESIGNED BY: DATE: 05-11-06
 SCALE: AS NOTED JOB #: 01-088
 PATH:
 FILE NO. 5 of 7-Layout SHEET: 5 OF 7

H:\jobs\03-013 Palmer Airport Aprons\ad\drawings\ALP\alp-6047_1=1_06/01/04 at 11:40 by cob
 LAYOUT: Layout1
 XREF: AIRPORT_ B001

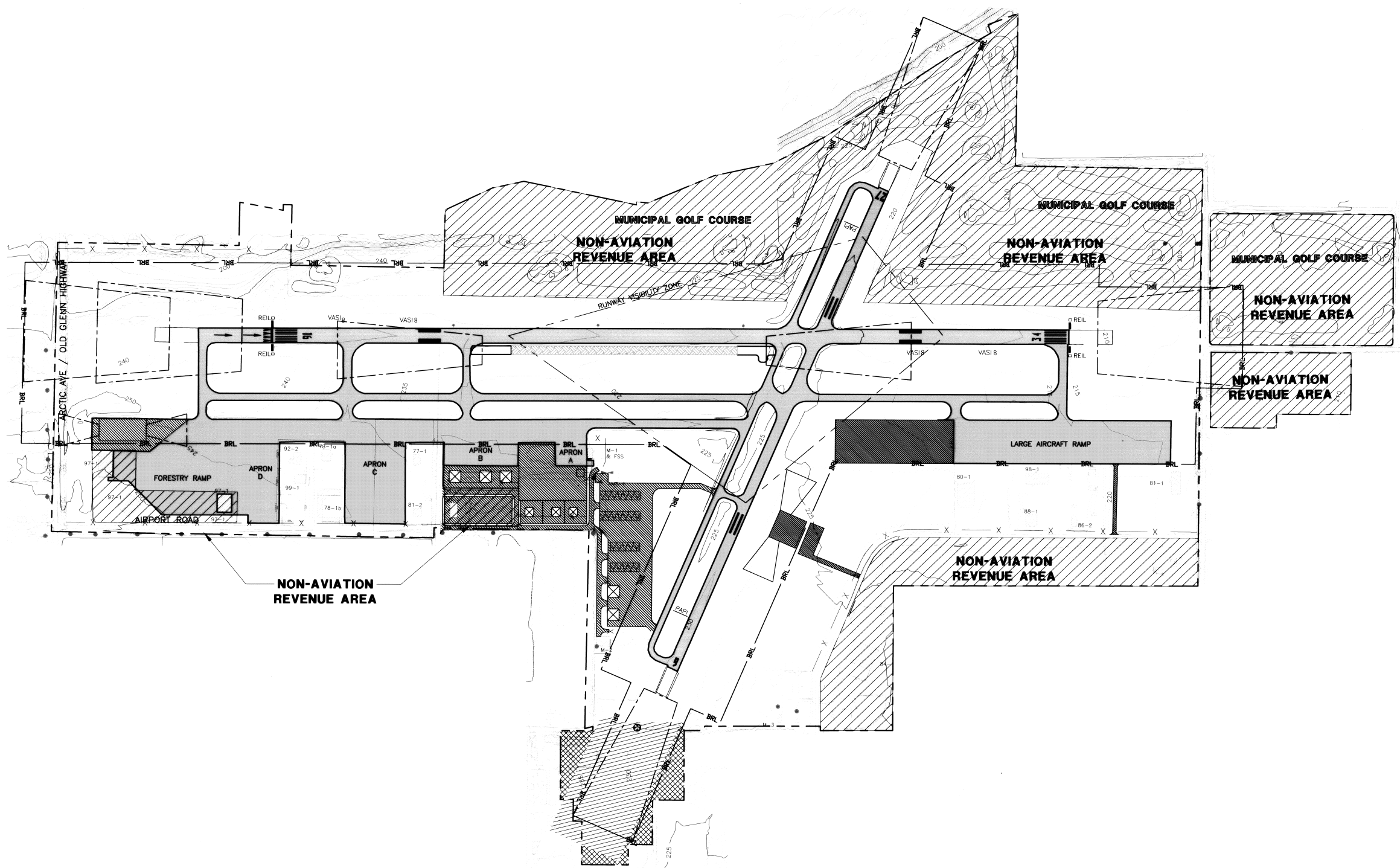

FINAL
 05-01-2004



REVISION	SYMBOL	DESCRIPTION	APPD BY	DATE
5				
4				
3				
2				
1				

APPROVAL SIGNATURES

Name of Airport: Palmer Municipal
 Date of Sponsor Review: _____
 Name of Sponsor Project: _____
 Manager Responsible for ALP: _____
 Signature of Sponsor Submitting ALP to FAA for Review: _____

FAA Airspace Review Number: 2004-AAL-10NRA
 Airport Layout Plan Conditional Approval Subject To
 ALP Approval Letter Dated: 7/26/04
 BY: [Signature] FOR DATE: 7/26/04
 FAA, Airports Division
 Alaska Region, AAL-601

- LEGEND
- EXISTING AVIATION EASEMENT
 - PROPOSED PROPERTY ACQUISITION FOR RPZ
 - EXISTING EASEMENT AND/OR RIGHT-OF-WAY PROPOSED TO BE VACATED
 - AIRFIELD PAVEMENT
 - PROPOSED AIRFIELD PAVEMENT
 - GRAVEL RUNWAY

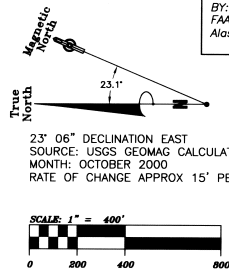

**CITY OF PALMER
 PALMER MUNICIPAL AIRPORT
 AIRPORT LAND USE PLAN
 PALMER, ALASKA**

DRAWN BY:	ENGINEER
DESIGNED BY:	DATE: 05-01-04
SCALE: AS NOTED	JOB #: 01-005
FILE NO. 6 of 7-Layout	SHEET: 6 OF 7

