

**LOCATION MAP**  
NO SCALE

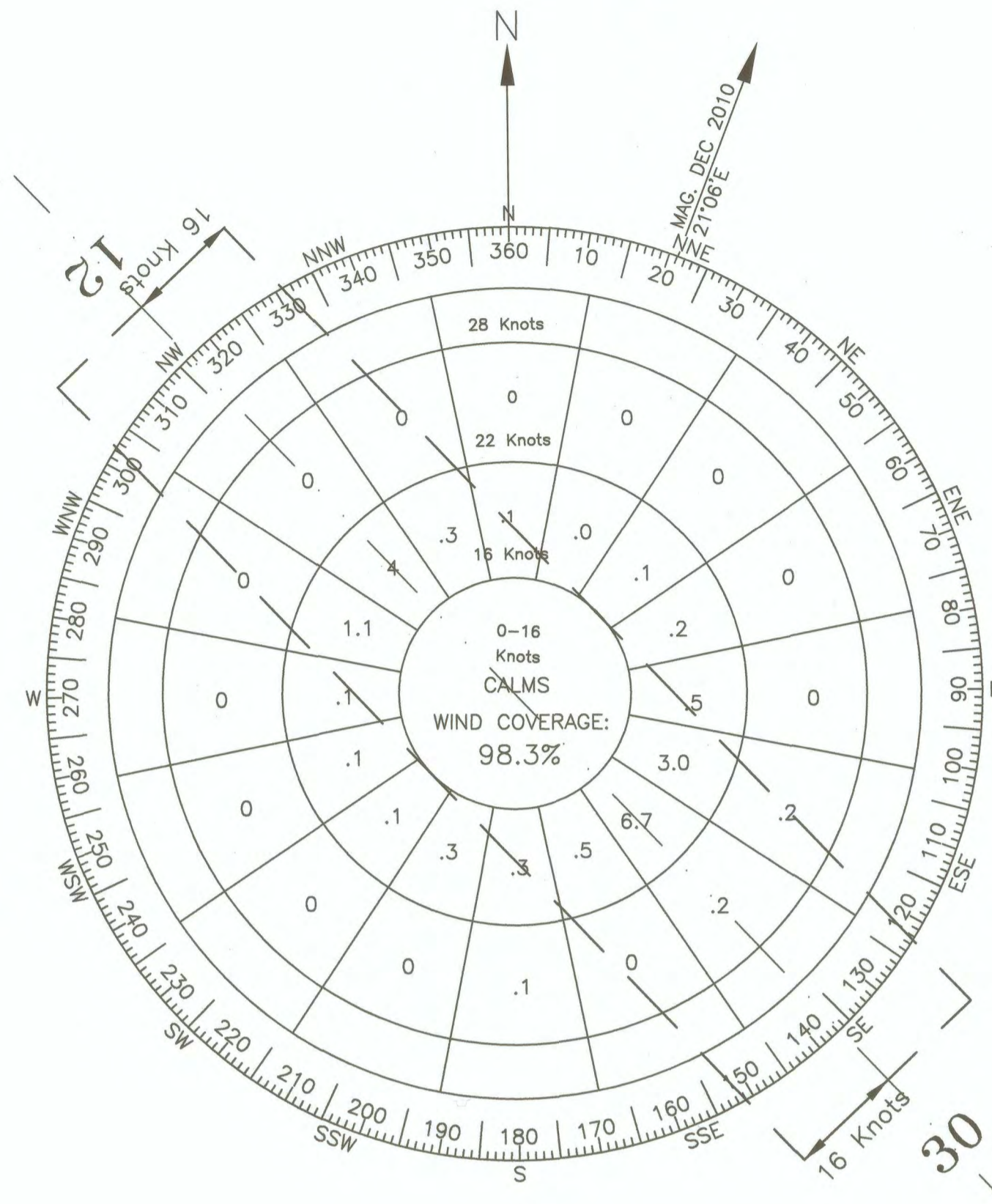

**VICINITY MAP**  
T55S & T56S, R63E, SEC. 2, 3, 34 & 35  
USGS SITKA  
1" = 1 MILE



WIND DATA TABLE				
RUNWAY	10.5 kt	13 kt	16 kt	20 kt
12-30	-	-	98.3%	-

SOURCE: SITKA-JAPONSKI STATION PERIOD: APRIL 1957 TO MAY 1961

AIRPORT DATA TABLE		
ITEM	EXISTING	ULTIMATE
ICAO IDENTIFIER		PASI
NATIONAL AIRPORT IDENTIFIER		SIT
FAA SITE NUMBER		50703.*A
AIRPORT ELEVATION NAVD88		26.5'
AIRPORT REFERENCE CODE		C - III
MEAN MAX. TEMPERATURE, HOTTEST MONTH *		62.1°F IN AUGUST
AIRPORT AND TERMINAL NAVIGATION AIDS	ROTATING BEACON, VORTAC, NDB, LOCALIZER, DME	SAME + GPS
TAXIWAY LIGHTING/MARKING		MITL
RAMP LIGHTING		EDGE & FLOODLIGHTING
OBSTRUCTION SURVEY SOURCE & TYPE		R&M CONSULTANTS, INC. 2011/ VERTICALLY GUIDED AIRPORT AIRSPACE ANALYSIS SURVEY
MAGNETIC DECLINATION, YEAR, RATE OF CHANGE **		21°06'E, JANUARY 2010 0°17'W/YEAR

DATA FROM (\*) THE WESTERN REGIONAL CLIMATE CENTER (\*\*) NATIONAL GEOPHYSICAL DATA CENTER

NON STANDARD CONDITIONS TABLE			
DESCRIPTION	STANDARD	EXISTING	ULTIMATE
RUNWAY SAFETY AREA LENGTH	8820'	7200'	7200'
RUNWAY SAFETY AREA WIDTH	500'	195'	195'

\*REFERENCE THE RUNWAY SAFETY AREA PRACTICABILITY STUDY DATED MAY 20, 2012

RUNWAY DATA TABLE		
ITEM	RW 11/29 EXISTING	RW 12/30 ULTIMATE
RUNWAY TYPE UTILITY OR OTHER THAN UTILITY	OTHER THAN UTILITY	SAME
FAR PART 77 APPROACH CATEGORY (V, NPI, P)	NPI/V	SAME
APPROACH SURFACES	34:1/20:1	SAME
VISIBILITY MINIMUM	≥1 SM/> 2 SM	SAME
RUNWAY SURFACE	ASPHALT CONCRETE	SAME
PAVEMENT STRENGTH SW, DW, DTW, DDTW X 1000LBS	400,000 DT	SAME
AIRCRAFT APPROACH CATEGORY	C	SAME
AIRPLANE DESIGN GROUP	III	SAME
RUNWAY DIMENSIONS	7200' X 150'	SAME
TRUE BEARING	N43°02'52"W	SAME
EFFECTIVE GRADE	0.04%	0.04%
RUNWAY SAFETY AREA (RSA) DIMENSIONS	7200' X 195'	SAME
LENGTH BEYOND R/W ENDS:		
UNDERSHOOT	200'/180'	SAME/SAME
OVERRUN	480'/500'	SAME/SAME
RUNWAY PROTECTION ZONE (RPZ) DIMENSIONS	1700' X 500' X 1010'	SAME/SAME
RUNWAY OBJECT FREE AREA (ROFA) DIMENSIONS	9200' X 800'	SAME
LENGTH BEYOND R/W ENDS OR STOPWAYS	1000'	SAME
RUNWAY OBSTACLE FREE ZONE (OFZ) DIMENSIONS	7600' X 400'	SAME
PRECISION OBJECT FREE ZONE (POFZ) DIMENSIONS	NONE/NONE	SAME/SAME
RUNWAY LIGHTING TYPE	HIRL	SAME + MALSR
RUNWAY MARKING TYPE	PRECISION/PRECISION	SAME/SAME
RUNWAY VISUAL APPROACH AIDS	REIL_VASI/REIL_VASI	SAME + MALSR/SAME
TOUCHDOWN ELEVATION NAVD88	24.4'/26.5'	SAME/SAME

GEOGRAPHIC COORDINATES TABLE		
ITEM	LATITUDE*	LONGITUDE*
AIRPORT REFERENCE POINT	57°02'48.54"N	135°21'39.72"W
THRESHOLD 11/12	57°03'12.51"N	135°22'22.91"W
THRESHOLD 29/30	57°02'24.56"N	135°20'56.53"W

\*NAD83

AIRPORT SURVEY CONTROL			
MONUMENT	LATITUDE	LONGITUDE	ELEVATION
SIT C (PACS)	57°02'49.64"N	135°21'50.40"W	19.9'
SIT D (SACS)	57°03'15.77"N	135°22'18.48"W	24.7'
SIT E (SACS)	57°02'24.60"N	135°20'50.35"W	25.1'

LEGEND		
ITEM	EXISTING	ULTIMATE
AIRPORT REFERENCE POINT		
ANTENNA/TOWER		
BUILDING		
BUILDING RESTRICTION LINE		
FENCE		
FLOOD LIGHT		
LEASE LOT		
PROPERTY LINE		
REIL		
ROADWAYS		
ROTATING BEACON		
RUNWAY/TAXIWAY CENTERLINE		
SHORELINE		
SURVEY MONUMENT		
THRESHOLD LIGHTS		
TOPOGRAPHIC CONTOURS		
TREE (LARGE SINGLE)		
TREELINE		
VASI		
WINDCONE		
WINDCONE WITH SEGMENTED CIRCLE		

SHEET INDEX	
TITLE	NO.
TITLE SHEET	1
EXISTING AIRPORT LAYOUT DRAWING	2
ULTIMATE AIRPORT LAYOUT DRAWING	3
TERMINAL AREA PHOTO	4
TERMINAL DRAWINGS	5-6
PART 77 AIRSPACE DRAWINGS	7
APPROACH SURFACE PROFILES DRAWING	8
RUNWAY 12 INNER APPROACH SURFACE DRAWING	9
RUNWAY PRIMARY & TRANSITIONAL SURFACES DRAWINGS	10-11
RUNWAY 30 INNER APPROACH SURFACE DRAWINGS	12
LANDUSE PLAN DRAWINGS	13-14
PROPERTY PLAN	15

PLANNED: VS  
DRAWN: JT  
CHECKED: KK

STATE OF ALASKA  
DEPARTMENT OF TRANSPORTATION  
AND PUBLIC FACILITIES  
SOUTHEAST REGION PLANNING

PREVIOUS REVISION DATE: OCTOBER 10, 2013  
APPROVED:   
VERNE SKAGERBERG, MEA  
CHIEF OF PLANNING  
DATE: 1/2/2019

FAA AIRSPACE REVIEW NO: ORIGINAL 2012-AAL-62-NRA  
FAA APPROVAL DATE: AS-BUILT ACCEPTED  
BY:   
FAA AIRPORT DIVISION, ALASKA REGION, AAL-600  
SUBJECT TO CONDITIONS IN LETTER DATED: 10-10-13  
PREVIOUS ALP FAA APPROVAL DATE: OCTOBER 10, 2013

SITKA ROCKY GUTIERREZ AIRPORT  
TITLE SHEET

SHEET  
1 OF 15

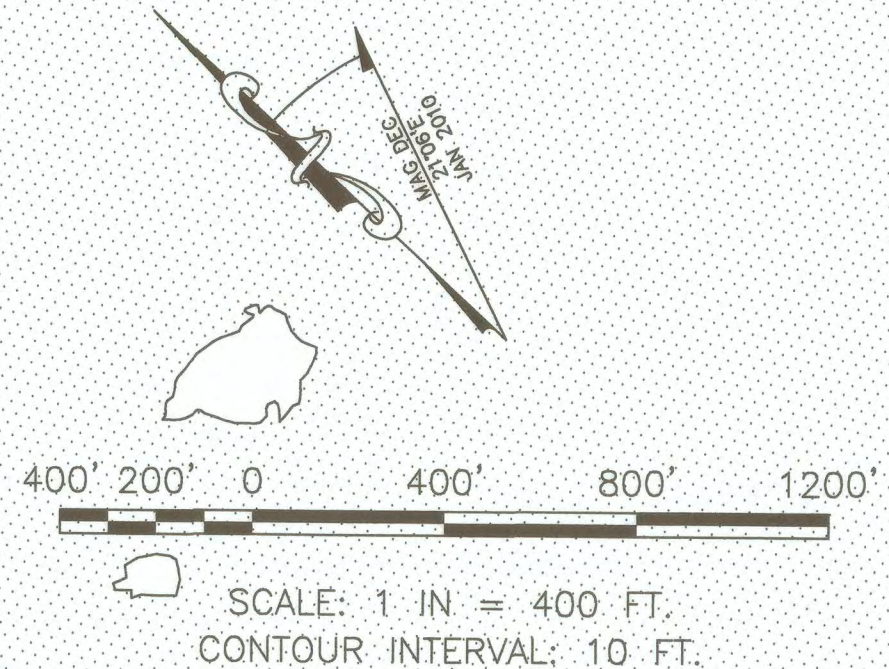
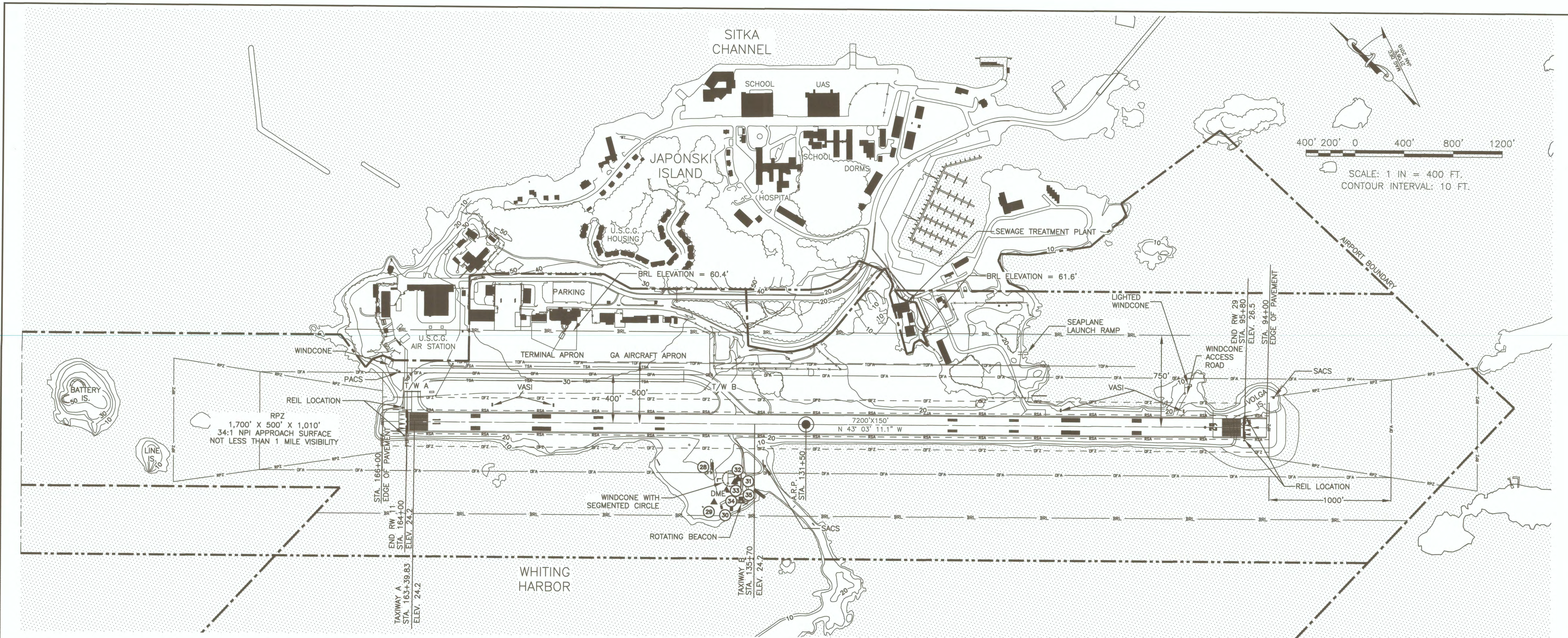

- NOTES:
- SEE SHEETS 10 AND 11 FOR OFZ OBJECT PENETRATIONS.
  - NO THRESHOLD SITING SURFACE PENETRATIONS.

TAXIWAY DATA TABLE			
TAXIWAY	WIDTH (FEET)	SAFETY AREA WIDTH (FEET)	OBJECT FREE AREA WIDTH (FEET)
TAXIWAY A	75	118	186
TAXIWAY B	75	118	186
TAXIWAY C	75	118	186

APRON DATA TABLE		
APRON	DIMENSIONS (FEET)	AREA (SQUARE FEET)
USCG AIR STATION	500 x 300	150,000
TERMINAL APRON	2000 x 300	600,000

DECLARED DISTANCE TABLE *				
RUNWAY	TORA	TODA	ASDA	LDA
EXISTING	EXISTING	EXISTING	EXISTING	EXISTING
11	7200	7200	6720	6500
29	7200	7200	6700	6500

NON-TERMINAL BUILDING & FACILITIES TABLE						
BUILDING NUMBER	DESCRIPTION	STATION RW 11-29	OFFSET	TOP ELEV (NAVD88)	OBSTRUCTION MARKING	DISPOSITION
28	LOCALIZER	139+10	347' LT	31.9		REMAIN
29	TOWER	138+93	642' LT	78.1		REMAIN
30	BUILDING	138+38	669' LT	28.2		REMAIN
31	TOWER	138+01	548' LT	76.2		REMAIN
32	TOWER	137+09	453' LT	49.8		REMAIN
33	TOWER	138+01	548' LT	73.5		REMAIN
34	ELECTRICAL EQUIPMENT BLDG.	137+56	632' LT	26.5		REMAIN
35	AWOS	136+75	632' LT	75.6		REMAIN

\*NOTE: RSA IS NON STANDARD PER FAA AC 150/5300-13A. SEE MODIFICATION TO STANDARDS/NON STANDARD CONDITIONS TABLE ON SHEET 1 FOR DETAILS.

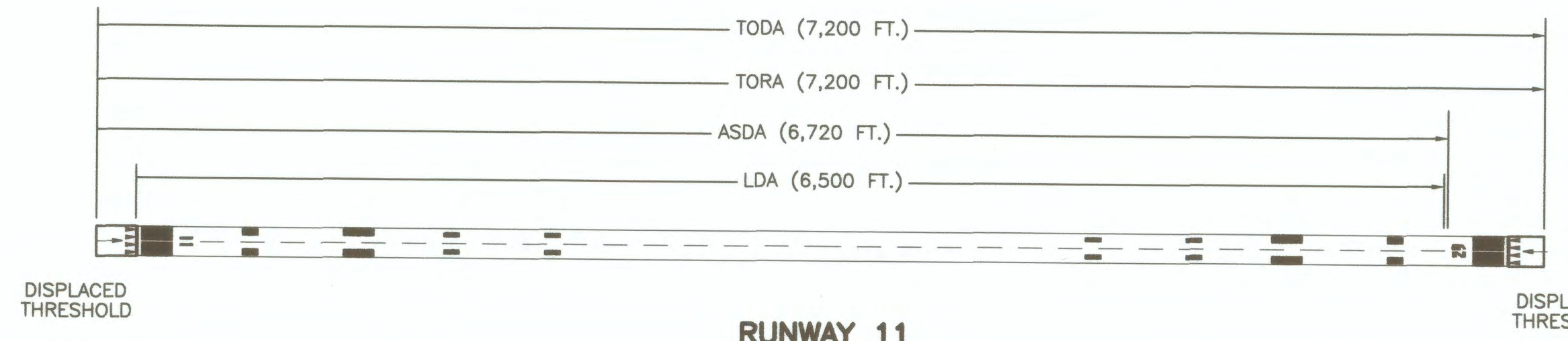

RUNWAY 11

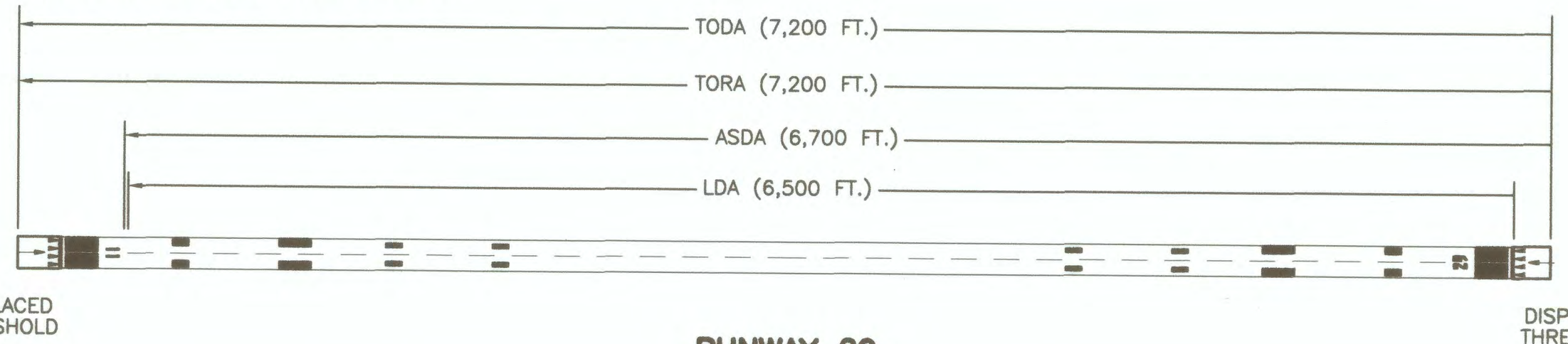

RUNWAY 29

DECLARED DISTANCES

PLANNED: VS  
 DRAWN: JT  
 CHECKED: KK

STATE OF ALASKA  
 DEPARTMENT OF TRANSPORTATION  
 AND PUBLIC FACILITIES  
 SOUTHEAST REGION PLANNING

BY	DATE	REVISION
	6/3/15	AS-BUILT

SITKA ROCKY GUTIERREZ AIRPORT  
 EXISTING AIRPORT LAYOUT DRAWING

G:\sit\AIRPORT\ALP\2017\AIT ALP Drawings\02 - Existing Airport Layout Drawing.dwg



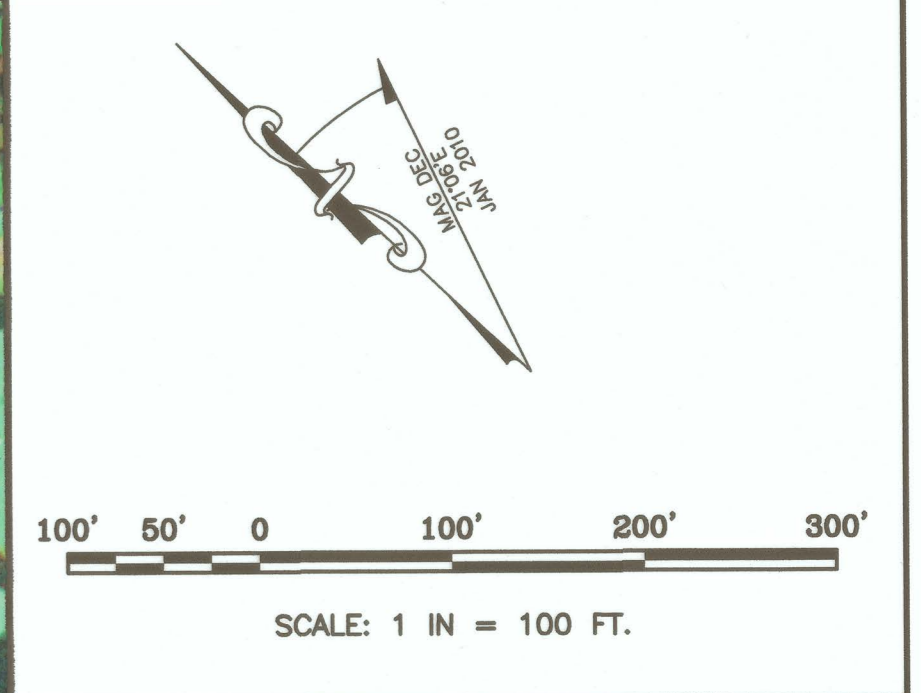

C:\SIT\AIRPORT\ALP\ALP\_2017\SIT\_ALP\_Drawings\04 - Terminal Area Photo.dwg

PLANNED: NBS  
 DRAWN: SA  
 CHECKED: EJJ

STATE OF ALASKA  
 DEPARTMENT OF TRANSPORTATION  
 AND PUBLIC FACILITIES  
 SOUTHEAST REGION PLANNING

BY	DATE	REVISION
	1/3/19	AS-BUILT

SITKA ROCKY GUTIERREZ AIRPORT  
 TERMINAL AREA PHOTO

SHEET  
 4  
 OF  
 15

BUILDING & FACILITIES TABLE						
BUILDING NUMBER	DESCRIPTION	STATION RW 12-30	OFFSET	TOP ELEV (NAVD88)	OBSTRUCTION MARKING	DISPOSITION
1	BUILDING	164+77	649' RT	34.05		REMAIN
2	BUILDING	165+78	742' RT	36.17		REMAIN
3	UTILITY TANK	165+97	810' RT	37.57		REMAIN
4	BUILDING	166+43	909' RT	44.07		REMAIN
5	BUILDING	166+66	1066' RT	48.43		REMAIN
6	COAST GUARD BUILDING	165+81	962' RT	49.41		REMAIN
7	BUILDING	165+13	1085' RT	38.28		REMAIN
8	COAST GUARD HANGER	161+69	993' RT	67.53		REMAIN
9	BUILDING	159+46	1053' RT	42.08		REMAIN
10	ARF & SRE	157+95	871' RT	56.79		REMAIN
11	SITKA SOUND AVIATION LLC	157+32	976' RT	55.06		REMAIN
12	SOUTHEAST EARTH MOVERS LLC	157+32	1076' RT	55.06		REMAIN
13	GUARDIAN FLIGHT INC	154+30	1034' RT	71.07		REMAIN
14	TRAJEN FLIGHT SUPPORT (AERO SERVICES)	154+58	856' RT	49.81		REMAIN
15	ALASKA AIRLINES FREIGHT	153+30	856' RT	54.96		REMAIN
16	CITY & BOROUGH OF SITKA AIRPORT TERMINAL	151+19	873' RT	59.11		REMAIN
17	KALININ PARTNERS LLC (ALASKA SEAPLANES)	147+75	860' RT	47.81		REMAIN
18	HWH LLC (FAA FLIGHT SERVICES)	145+50	843' RT	67.78		REMAIN
19	ALASKA AIRLINES	143+90	853' RT	52.80		REMAIN
20	PERSERVERANCE ENTERPRISES LLC	142+79	848' RT	48.23		REMAIN
21	ALASKA RENT A CAR INC	147+64	985' RT	49.47		REMAIN
22	ALASKA RENT A CAR INC	143+80	988' RT	44.28		REMAIN

SCALE: 1 IN = 100 FT.  
 CONTOUR INTERVAL: 2 FT.  
 SEE SHEET 1 OF 18 FOR NOTES & LEGEND

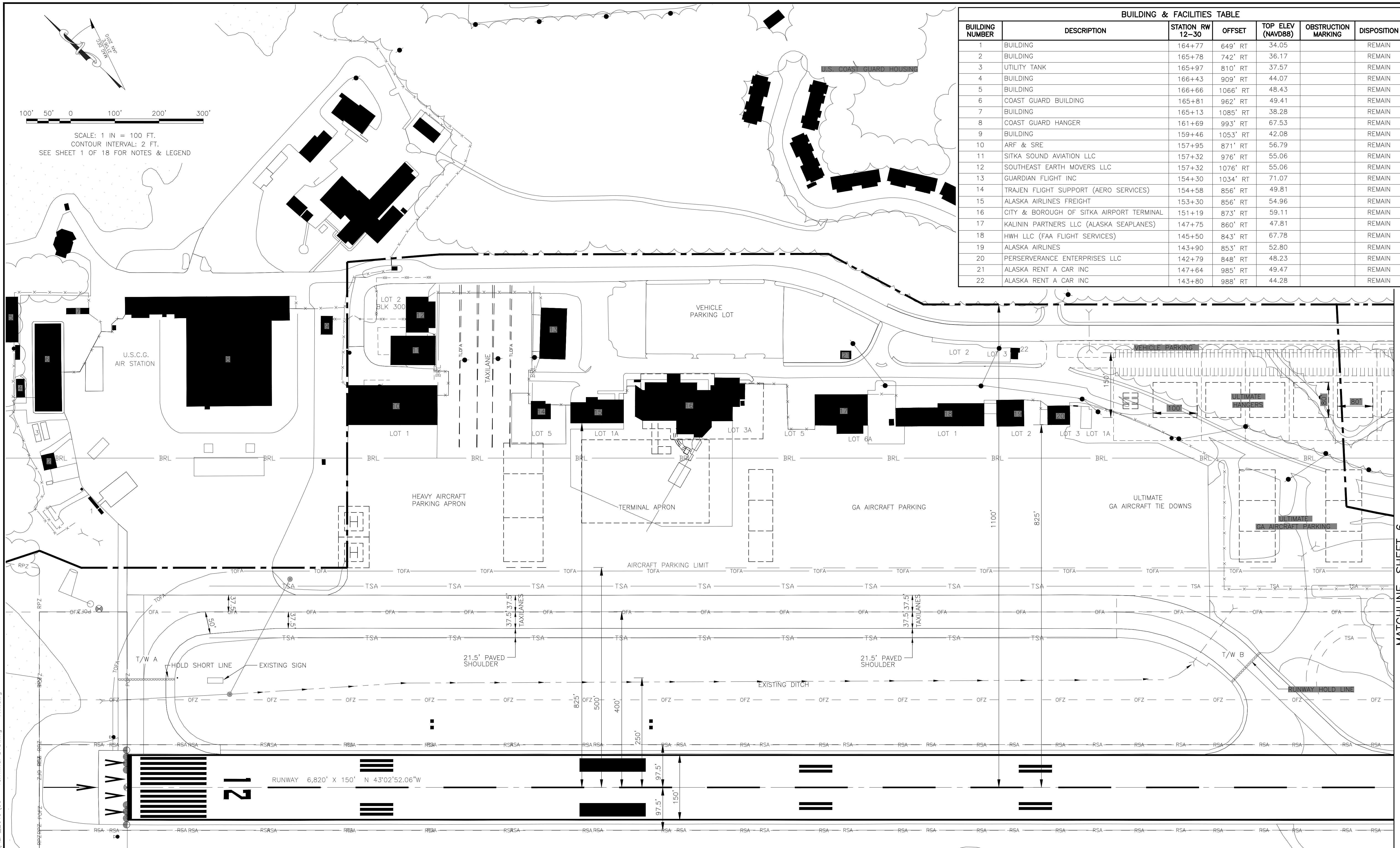

G:\SIT\AIRPORT\ALP\ALP\_2019\05 - Terminal Drawing - NW.dwg

PLANNED: NBS  
 DRAWN: SA  
 CHECKED: EJJ

STATE OF ALASKA  
 DEPARTMENT OF TRANSPORTATION  
 AND PUBLIC FACILITIES  
 SOUTHEAST REGION PLANNING

BY	DATE	REVISION
PK	7/18/23	UPDATED TENANT LIST AND REMOVED BUILDING #22
PK	11/16/22	FUTURE TERMINAL OUTLINE
PK	1/3/19	AS-BUILT

SITKA ROCKY GUTIERREZ AIRPORT  
 TERMINAL DRAWING - NW

SHEET  
 5 OF 15

MATCHLINE, SHEET 6

BUILDING & FACILITIES TABLE						
BUILDING NUMBER	DESCRIPTION	STATION RW 12-30	OFFSET	TOP ELEV (NAVD88)	OBSTRUCTION MARKING	DISPOSITION
23	SEWAGE TREATMENT PLANT	123+10	770' RT	40.44		REMAIN
24	SEWAGE TREATMENT PLANT	123+68	961' RT	59.30		REMAIN
25	BUILDING	123+04	878' RT	31.42		REMAIN
26	BUILDING	120+70	1027' RT	33.06		REMOVE
27	BUILDING	120+30	600' RT	35.40	LIGHT	REMOVE

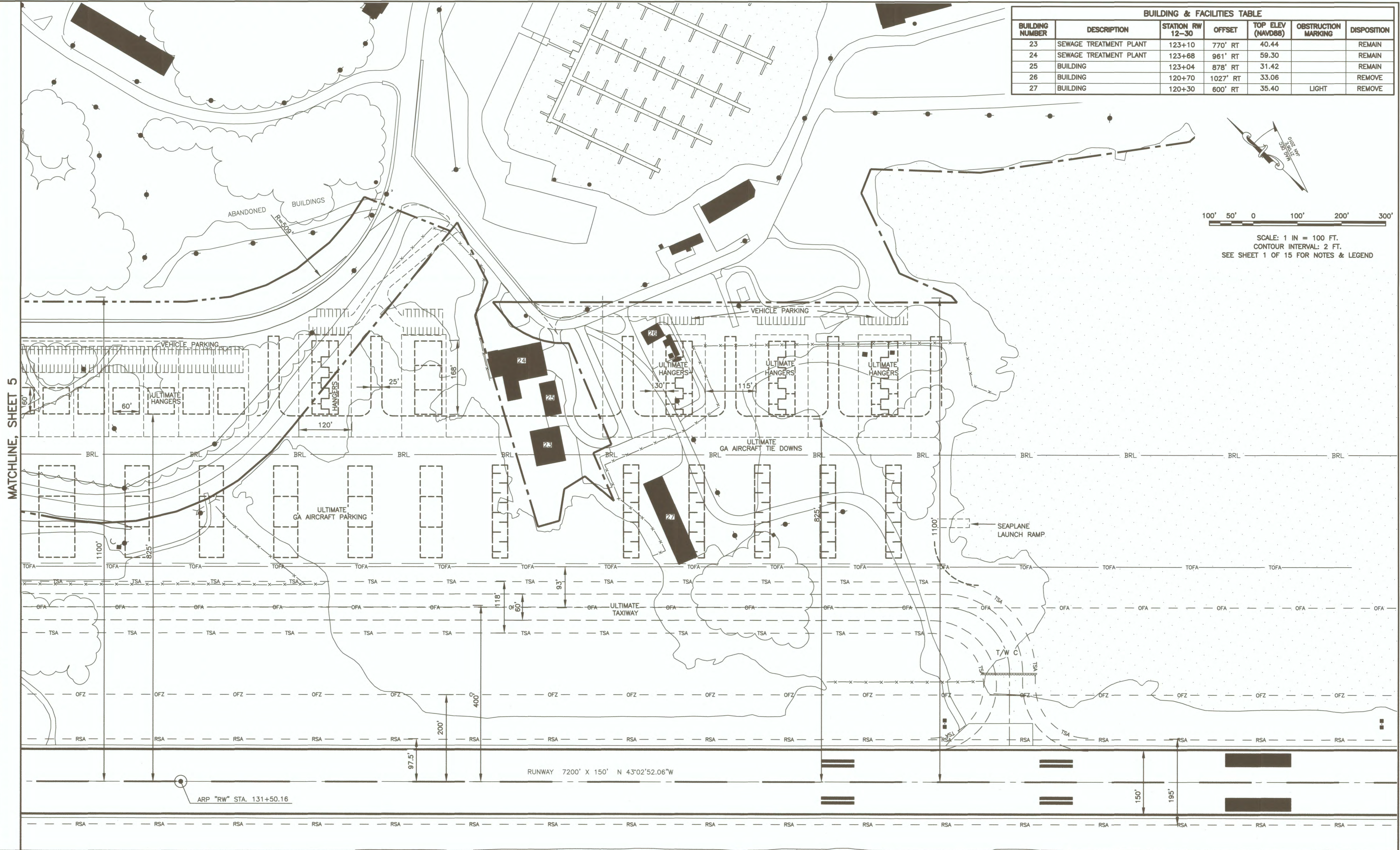
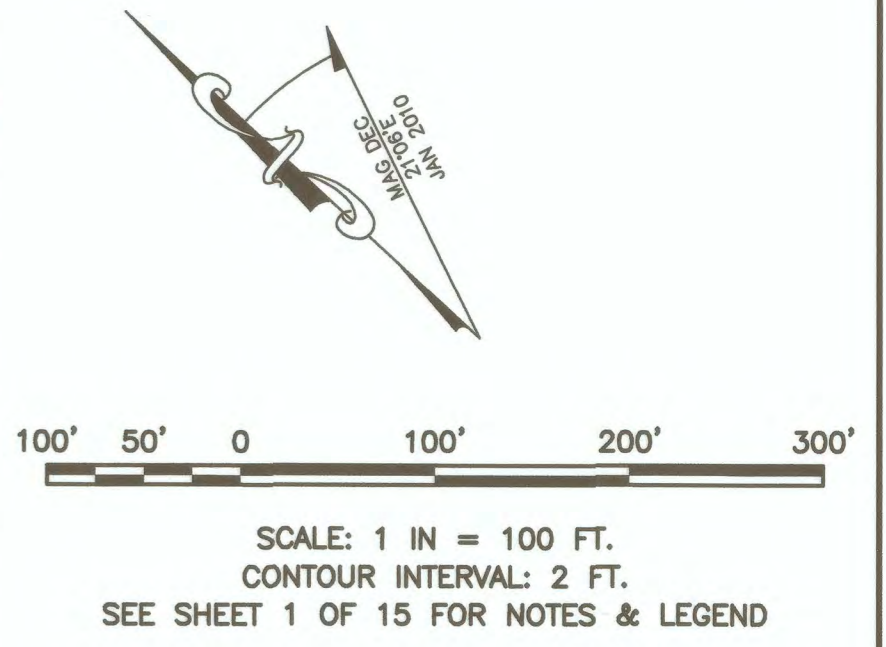

MATCHLINE, SHEET 5

G:\SIT\AIRPORT\ALP\ALP\_2017\AIT ALP Drawings\06 - Terminal Drawing - SE.dwg

PLANNED: VS  
 DRAWN: JT  
 CHECKED: KK

STATE OF ALASKA  
 DEPARTMENT OF TRANSPORTATION  
 AND PUBLIC FACILITIES  
 SOUTHEAST REGION PLANNING

BY	DATE	REVISION
AS-BUILT	1/3/19	

SITKA ROCKY GUTIERREZ AIRPORT  
 TERMINAL DRAWING - SE

SHEET  
 6 OF  
 15

G:\SIT\AIRPORT\ALP\ALP\_2017\AIT ALP Drawings\07 - Part 77 Airspace Drawing.dwg

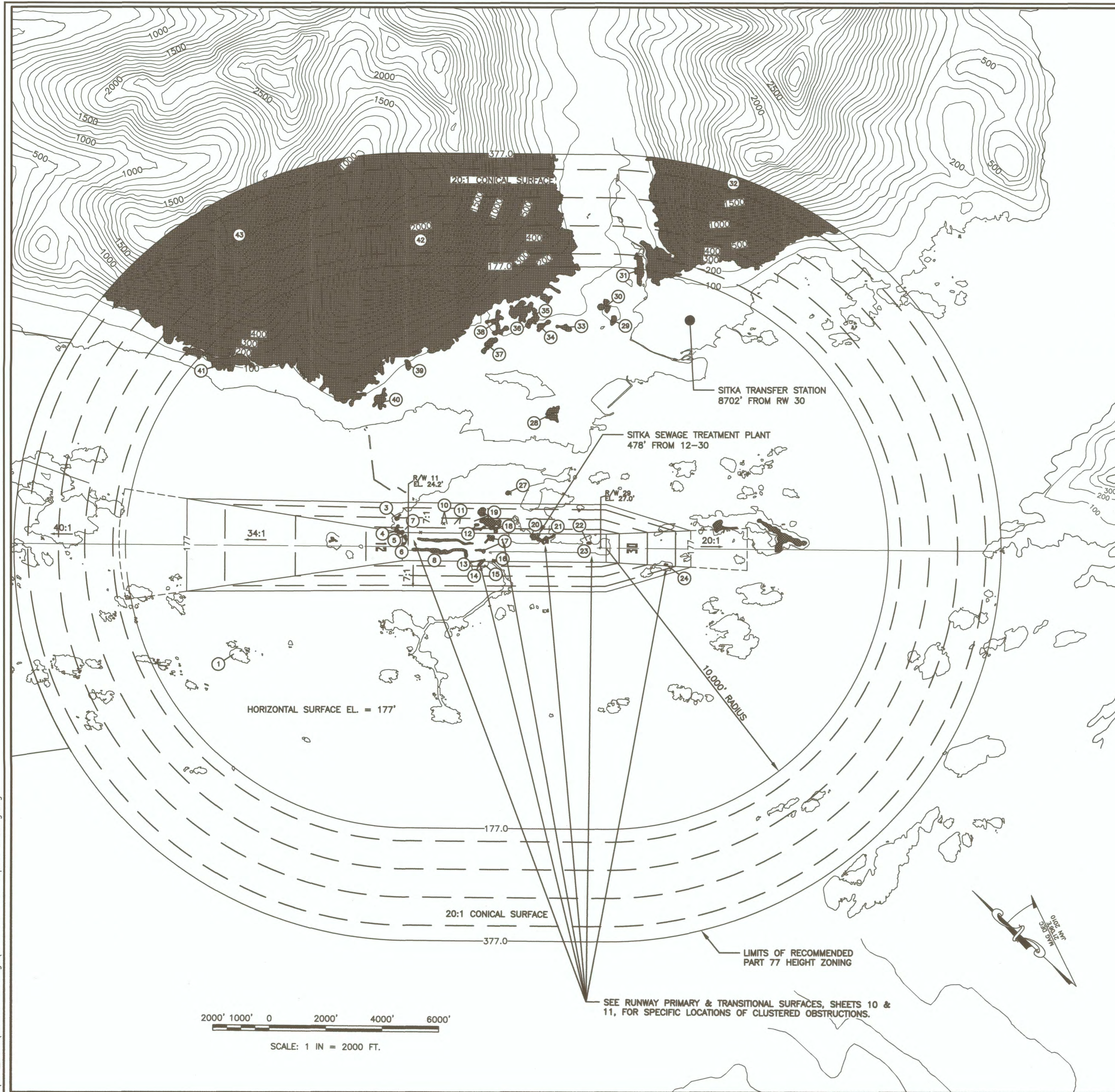

OBSTRUCTION TABLE								
ITEM NO.	DESCRIPTION	STATION/OFFSET RW 12-30	ELEVATION (NAVD88)	SURFACE PENETRATED	SURFACE ELEVATION	AMOUNT PENETRATED	DISPOSITION	STAGE TO CORRECT
1	TREE	225+66/3879' LT	198.2	HORIZONTAL	177.0'	21.2'	REMOVE	N/A
3	TREES	167+93/1004' RT	128.6	TRANSITIONAL	92.6'	36.0'	REMAIN	N/A
4	TREES	167+62/574' RT	114.1	TRANSITIONAL	55.9'	58.2'	REMAIN	N/A
5	WINDSOCK	164+84/418' RT	45.2	PRIMARY	24.1'	21.1'	REMAIN	N/A
6	BUSHES	164+63/254' RT	27.9	PRIMARY	24.2'	3.7'	REMOVE	N/A
7	POLE	164+97/620' RT	55.8	TRANSITIONAL	41.5'	14.3'	REMAIN	N/A
8	BUSHES	151+87/176' LT	26.8	PRIMARY	24.5'	2.3'	REMOVE	N/A
10	POLES	151+25/836' RT	84.2	TRANSITIONAL	72.0'	12.2'	REMAIN	N/A
11	ANTENNAS	146+61/834' RT	80.4	TRANSITIONAL	71.2'	9.2'	REMAIN	N/A
12	POLES	138+50/752' RT	70.5	TRANSITIONAL	67.1'	3.4'	REMAIN	N/A
13	WINDSOCK	137+68/446' LT	43.3	PRIMARY	25.2'	18.1'	REMAIN	N/A
14	ANTENNAS	138+11/560' LT	76.2	TRANSITIONAL	44.1'	32.1'	REMAIN	N/A
15	POLE	136+75/632' LT	75.6	TRANSITIONAL	44.2'	31.4'	REMAIN	N/A
16	TREE	134+29/493' LT	29.8	PRIMARY	25.4'	4.4'	REMOVE	N/A
17	BUSHES	138+09/109' LT	31.3	PRIMARY	25.4'	5.9'	REMOVE	N/A
18	POLES/TANK	133+12/660' RT	59.5	TRANSITIONAL	50.0'	9.5'	REMAIN	N/A
19	TREES	136+12/944' RT	162.0	TRANSITIONAL	143.2'	18.8'	REMOVE	N/A
20	BUILDING	119+92/508' RT	40.5	TRANSITIONAL	27.1'	13.4'	REMOVE	N/A
21	TREES/BUSHES/GROUND	116+87/293' RT	39.9	PRIMARY	26.2'	13.7'	REMOVE	N/A
22	WINDSOCK	100+67/275' RT	40.9	PRIMARY	26.8'	14.1'	REMAIN	N/A
23	TREES	99+79/179' RT	29.0	PRIMARY	26.8'	2.2'	REMOVE	N/A
24	TREES	72+59/570' LT	142.4	TRANSITIONAL	134.6'	7.8'	REMAIN	N/A
27	ANTENNAS	128+82/1938' RT	210.3	HORIZONTAL	177.0'	33.3'	REMAIN	N/A
28	TREES	113+16/4768' RT	216.2	HORIZONTAL	177.0'	39.2'	REMAIN	N/A
29	TREES	91+77/8103' RT	197.8	HORIZONTAL	177.0'	20.8'	REMAIN	N/A
30	TREES	94+77/8592' RT	198.7	HORIZONTAL	177.0'	21.7'	REMAIN	N/A
31	TREES	82+39/9887' RT	221.6	HORIZONTAL	177.0'	44.6'	REMAIN	N/A
32	TREES/GROUND	54+46/11750' RT	2148.4	CONICAL	369.2'	1779.2'	REMAIN	N/A
33	TREES	108+63/7822' RT	207.5	HORIZONTAL	177.0'	30.5'	REMAIN	N/A
34	TREES	116+96/7883' RT	193.7	HORIZONTAL	177.0'	16.7'	REMAIN	N/A
35	TREES	119+89/8129' RT	199.7	HORIZONTAL	177.0'	22.7'	REMAIN	N/A
36	TREES	124+56/8409' RT	214.5	HORIZONTAL	177.0'	37.5'	REMAIN	N/A
37	TREES	135+43/7239' RT	222.8	HORIZONTAL	177.0'	45.8'	REMAIN	N/A
38	TREES	133+13/7970' RT	189.3	HORIZONTAL	177.0'	12.3'	REMAIN	N/A
39	TREES	164+39/6459' RT	213.9	HORIZONTAL	177.0'	36.9'	REMAIN	N/A
40	TREES	174+19/5209' RT	196.8	HORIZONTAL	177.0'	19.8'	REMAIN	N/A
41	TREES	229+37/6485' RT	260.5	HORIZONTAL	177.0'	83.5'	REMAIN	N/A
42	TREES/GROUND	160+23/10827' RT	2221.5	CONICAL	216.3'	2005.2'	REMAIN	N/A
43	TREES/GROUND	224+01/10968' RT	2410.2	CONICAL	304.0'	2106.2'	REMAIN	N/A

NOTES:

1. REFER TO THE INNER PORTION OF THE APPROACH SURFACE DRAWINGS FOR CLOSE IN OBSTRUCTIONS.
2. PRIMARY SURFACE WIDTH IS 1000'.

PLANNED: VS  
 DRAWN: JT  
 CHECKED: KK

STATE OF ALASKA  
 DEPARTMENT OF TRANSPORTATION  
 AND PUBLIC FACILITIES  
 SOUTHEAST REGION PLANNING

BY	DATE	REVISION
	1/3/19	AS-BUILT

SITKA ROCKY GUTIERREZ AIRPORT  
 PART 77 AIRSPACE DRAWING

SHEET  
 7  
 OF  
 15

RUNWAY 12

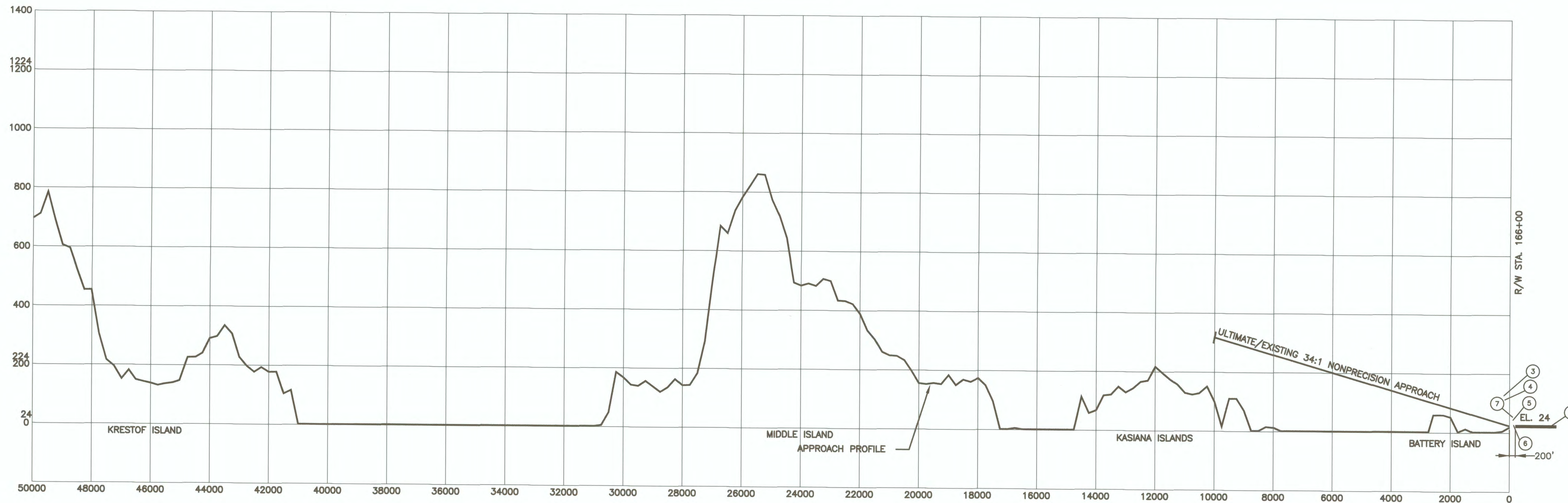

OBSTRUCTION TABLE								
ITEM NO.	DESCRIPTION	STATION/OFFSET RW 12-30	ELEVATION (NAVD88)	SURFACE PENETRATED	SURFACE ELEVATION	AMOUNT PENETRATED	DISPOSITION	STAGE TO CORRECT
3	TREES	167+93/1004' RT	128.6	TRANSITIONAL	92.6'	36.0'	REMOVE	N/A
4	TREES	167+62/574' RT	114.1	TRANSITIONAL	55.9'	58.2'	REMOVE	N/A
5	WINDSOCK	164+84/418' RT	45.2	PRIMARY	24.1'	21.1'	REMAIN	N/A
6	BUSHES	164+63/254' RT	27.9	PRIMARY	24.2'	3.7'	REMOVE	N/A
7	POLE	164+97/620' RT	55.8	TRANSITIONAL	41.5'	14.3'	REMAIN	N/A
8	BUSHES	151+87/176' LT	26.8	PRIMARY	24.5'	2.3'	REMOVE	N/A
9	BUSHES	151+91/240' RT	26.8	PRIMARY	24.5'	2.3'	REMOVE	N/A

NOTES:

- APPROACH PROFILE IS A COMPOSITE PROFILE OF HIGHEST TERRAIN ALONG APPROACH SURFACE.
- PROFILE DATA COMPILED USING PHOTOGRAMMETRIC PROCEDURES USING PHOTOGRAPHY DATED SEPTEMBER 14 1997.

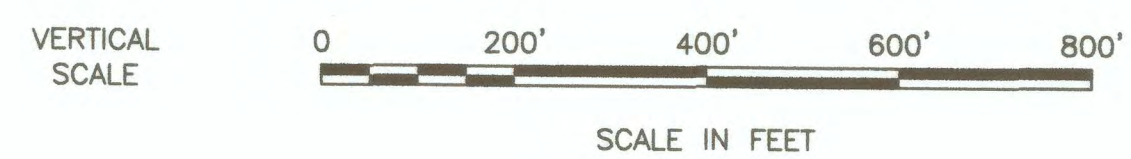
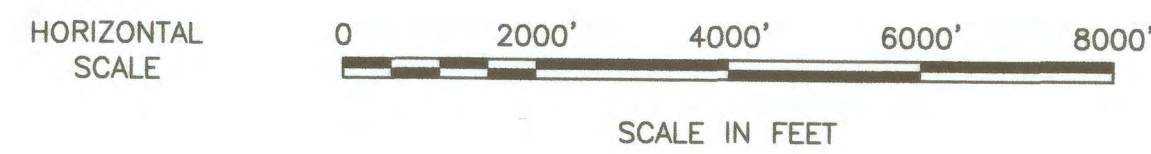

RUNWAY 30

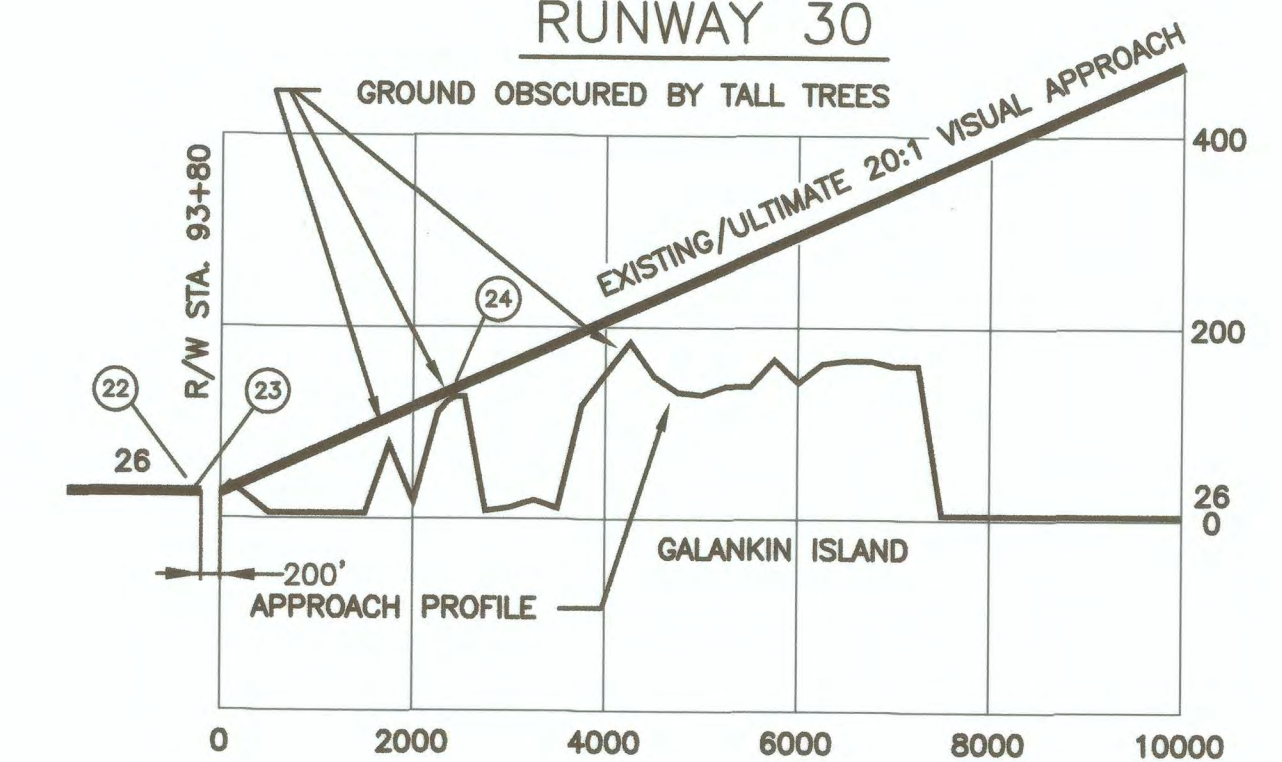

OBSTRUCTION TABLE								
ITEM NO.	DESCRIPTION	STATION/OFFSET RW 12-30	ELEVATION (NAVD88)	SURFACE PENETRATED	SURFACE ELEVATION	AMOUNT PENETRATED	DISPOSITION	STAGE TO CORRECT
22	WINDSOCK	100+67/275' RT	40.9	PRIMARY	26.8'	14.1'	REMAIN	N/A
23	TREES	99+79/179' RT	29.0	PRIMARY	26.8'	2.2'	REMOVE	N/A
24	TREES	72+59/570' LT	142.4	TRANSITIONAL	134.6'	7.8'	REMAIN	N/A

G:\SIT\AIRPORT\VALP\2017\AIT ALP Drawings\09 - Approach Surface Profiles Drawing.dwg

PLANNED: VS  
DRAWN: JT  
CHECKED: KK

STATE OF ALASKA  
DEPARTMENT OF TRANSPORTATION  
AND PUBLIC FACILITIES  
SOUTHEAST REGION PLANNING

BY	DATE	REVISION
	1/3/19	AS-BUILT

SITKA ROCKY GUTIERREZ AIRPORT  
APPROACH SURFACE  
PROFILES DRAWING

SHEET  
8  
OF  
15







OBSTRUCTION TABLE								
ITEM NO.	DESCRIPTION	STATION/OFFSET RW 12-30	ELEVATION (NAVD88)	SURFACE PENETRATED	SURFACE ELEVATION	AMOUNT PENETRATED	DISPOSITION	STAGE TO CORRECT
20	BUILDING	119+92/508' RT	40.5	TRANSITIONAL	27.1'	13.4'	REMOVE	N/A
21	TREES/BUSHES/GROUND	116+87/293' RT	39.9	PRIMARY	26.2'	13.7'	REMOVE	N/A
22	WINDSOCK	100+67/275' RT	40.9	PRIMARY	26.8'	14.1'	REMAIN	N/A
23	TREES	99+79/179' RT	29.0	PRIMARY	26.8'	2.2'	REMOVE	N/A
24	TREES	72+59/570' LT	142.4	TRANSITIONAL	134.6'	7.8'	REMOVE	N/A
27	ANTENNAS	128+82/1938' RT	210.3	HORIZONTAL	177.0'	33.3'	REMAIN	N/A

NOTE:  
1. EXISTING RUNWAY DESIGNATION AND MARKINGS ARE 11/29.  
ULTIMATE RUNWAY DESIGNATION AND MARKINGS ARE 12/30.

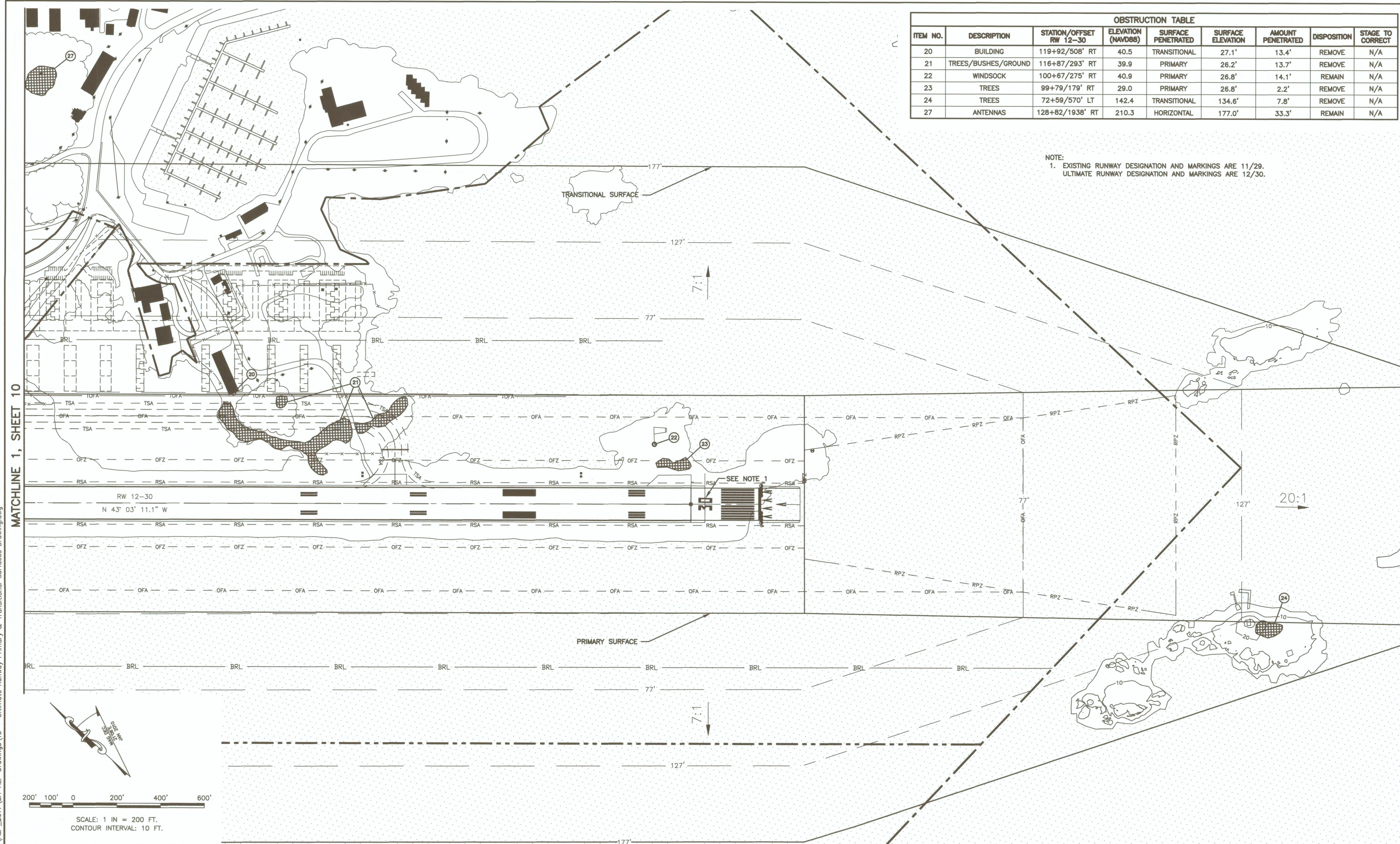

MATCHLINE 1, SHEET 10

Q:\SIT\AIRPORT\ALP\ALP\_2017\SIT ALP Drawings\13 - Ultimate Runway Primary & Transitional Surfaces Drawing.dwg

PLANNED: VS  
DRAWN: JT  
CHECKED: KK

STATE OF ALASKA  
DEPARTMENT OF TRANSPORTATION  
AND PUBLIC FACILITIES  
SOUTHEAST REGION PLANNING

BY	DATE	REVISION
	11/3/19	AS-BUILT

SITKA ROCKY GUTIERREZ AIRPORT  
RUNWAY PRIMARY & TRANSITIONAL  
SURFACES DRAWING

SHEET  
11  
OF  
15

Q:\SIT\AIRPORT\ALP\ALP\_2017\SIT ALP Drawings\15 - Ultimate Runway 30 Inner Approach Surface Drawing.dwg

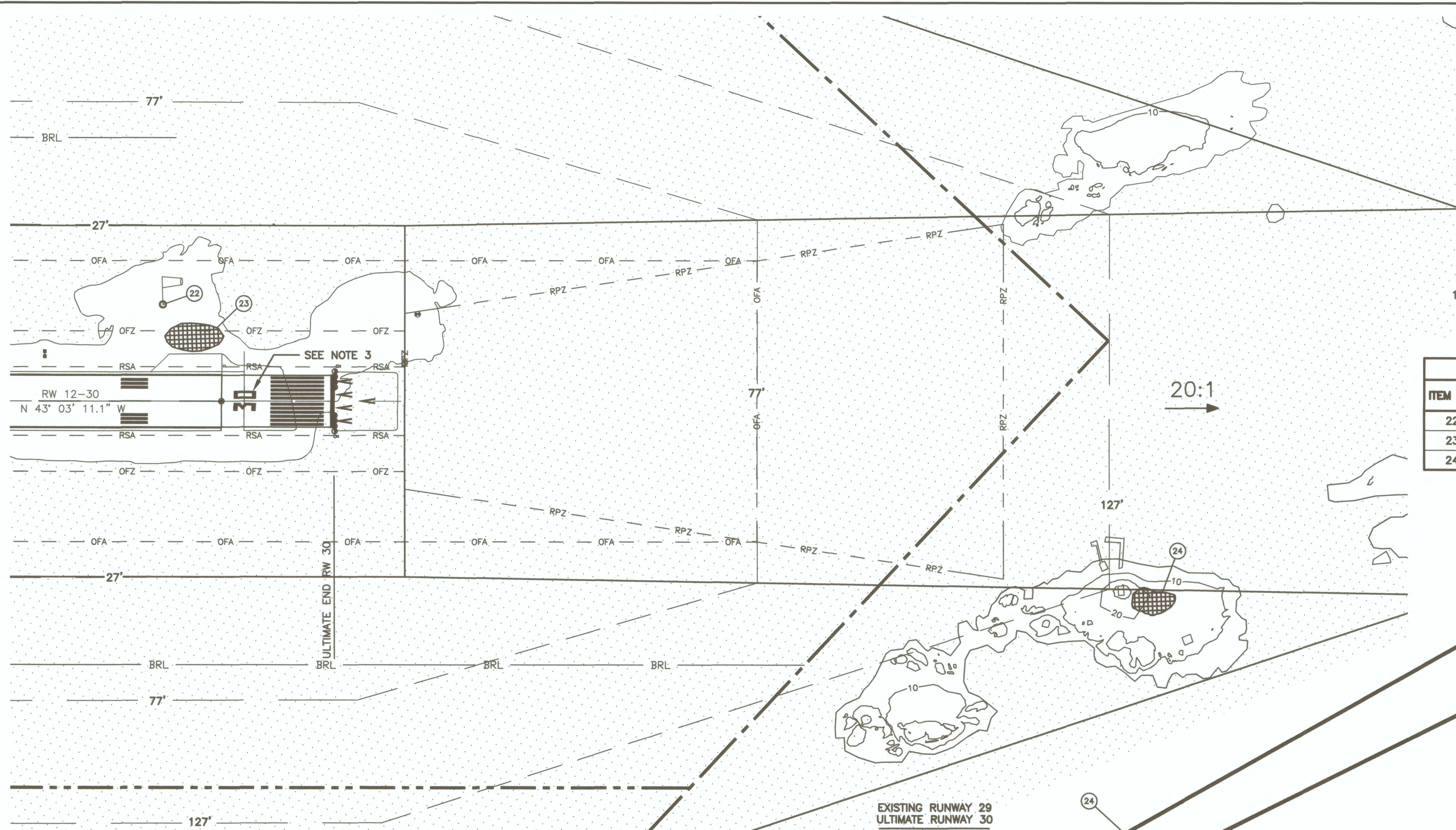

OBSTRUCTION TABLE								
ITEM NO.	DESCRIPTION	STATION/OFFSET RW 12-30	ELEVATION (NAVD88)	SURFACE PENETRATED	SURFACE ELEVATION	AMOUNT PENETRATED	DISPOSITION	STAGE TO CORRECT
22	WINDSOCK	100+67/275' RT	40.9	PRIMARY	26.8'	14.1'	REMAIN	N/A
23	TREES	99+79/179' RT	29.0	PRIMARY	26.8'	2.2'	REMOVE	N/A
24	TREES	72+59/570' LT	142.4	TRANSITIONAL	134.6'	7.8'	REMOVE	N/A

RWY 30 TOUCHDOWN ZONE ELEVATION = 27.0'

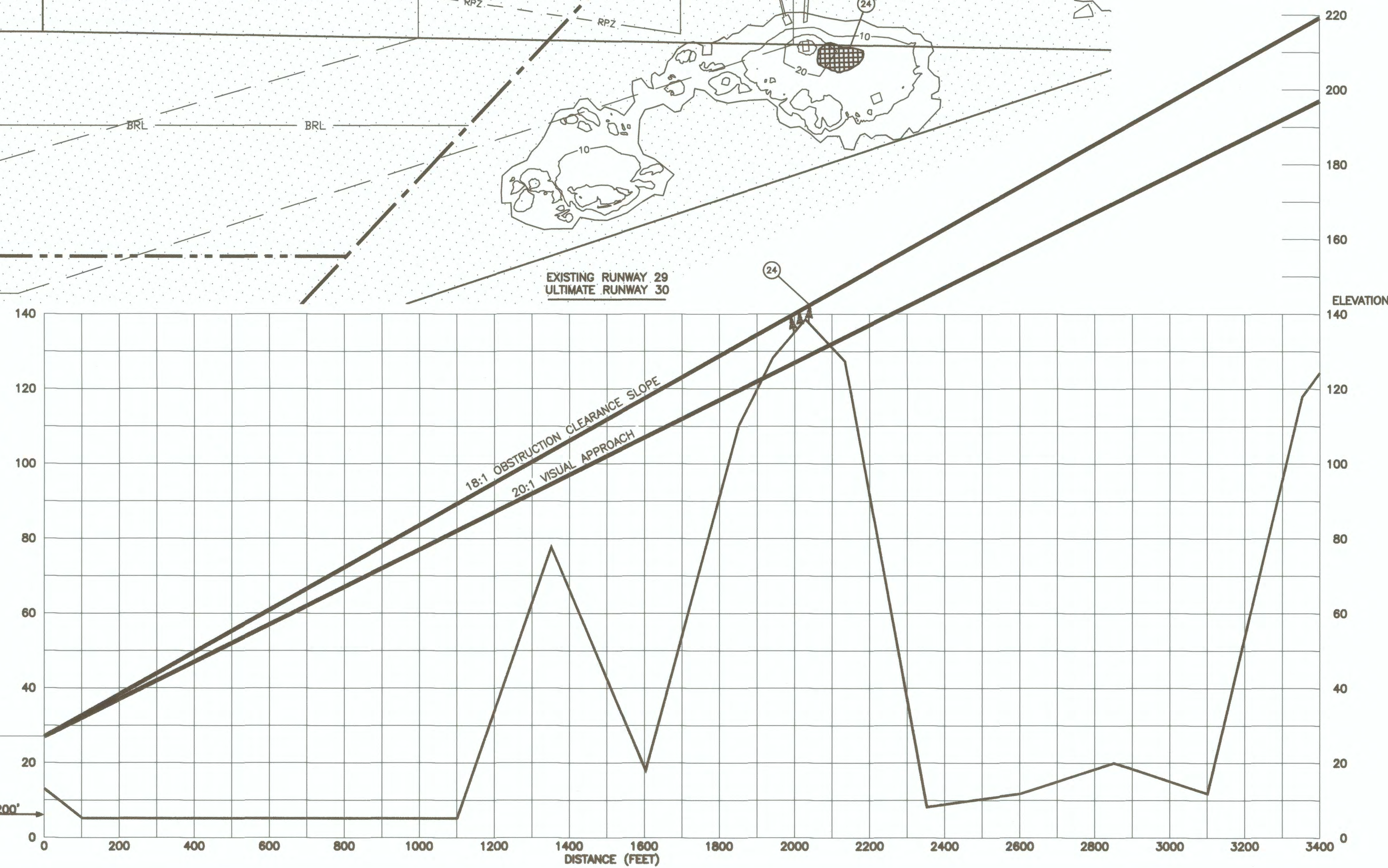

NOTES:

1. THERE ARE CONTROLLING OBSTRUCTIONS FOR RUNWAY 29(30). THEREFORE THE CONTROLLING OBSTRUCTION CLEARANCE SLOPE IS ESTABLISHED AS 18:1 PER FAA AC 150/5200-35, SECTION 4, DATA ELEMENT NUMBER 57.
2. THERE ARE OBJECT PENETRATIONS IN THE RUNWAY APPROACH END SITING SURFACES OF RUNWAY 29(30), AS DEFINED IN FAA AC 150/5300-13A, TABLE 3-2, LINE 3.
3. EXISTING RUNWAY DESIGNATION AND MARKINGS ARE 11/29. ULTIMATE RUNWAY DESIGNATION AND MARKINGS ARE 12/30.

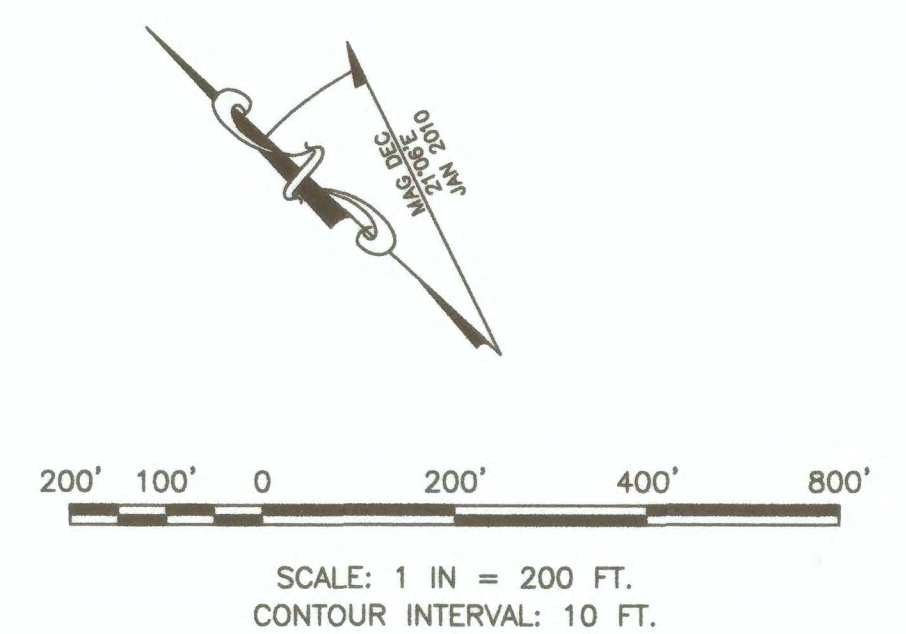

PLANNED: VS  
DRAWN: JT  
CHECKED: KK

STATE OF ALASKA  
DEPARTMENT OF TRANSPORTATION  
AND PUBLIC FACILITIES  
SOUTHEAST REGION PLANNING

BY	DATE	REVISION
	1/3/19	AS-BUILT

SITKA ROCKY GUTIERREZ AIRPORT  
RUNWAY 29(30) INNER  
APPROACH SURFACE DRAWING

SHEET  
12  
OF  
15





